

Kontaktübersicht:  
contacts overview

L = lang / long  
M = mittel / middle  
S = kurz / short

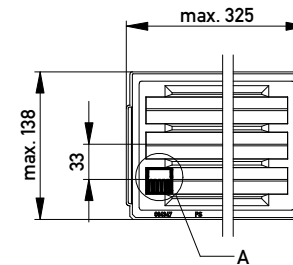
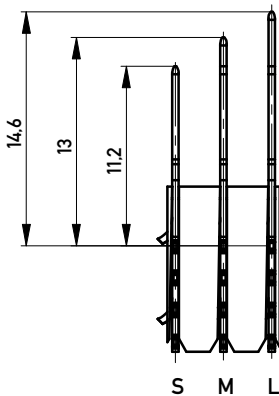

M 1: 5

verpackt in Tray  
VPE: 36 St.

tray packaging  
packaging unit 36 pcs.

DETAIL A  
MAßSTAB 1: 1

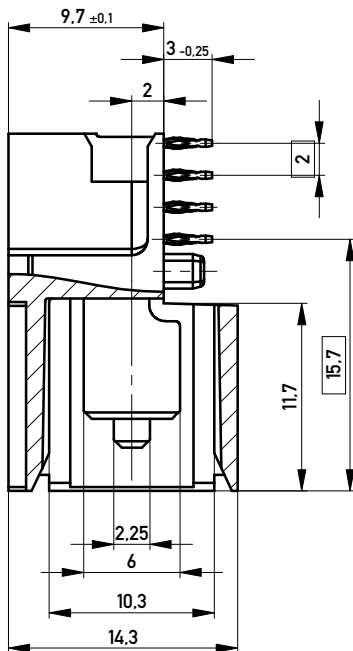
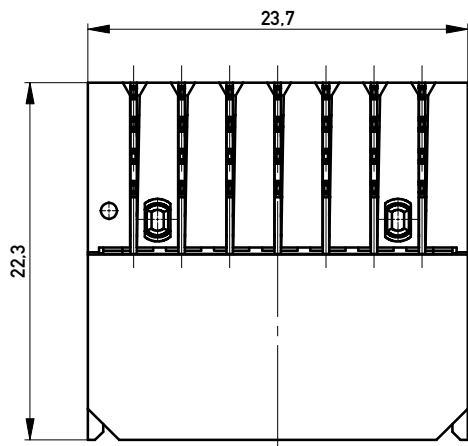
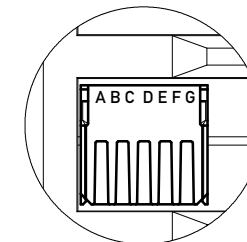

Bestückungsplan  
contact layout

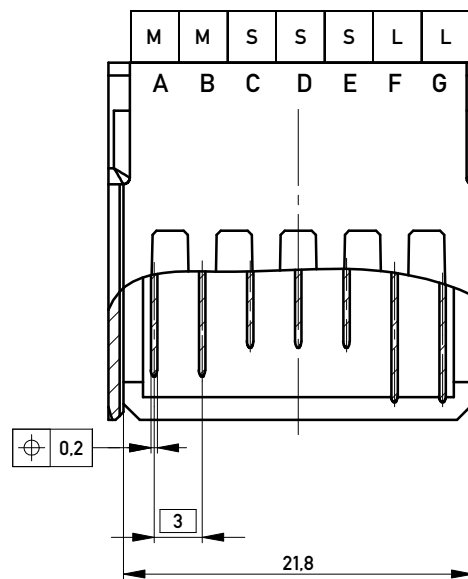

Gehäuse / housing: PBTP grau 30% GF / PBTP gray 30% GF  
Kontakte / contacts: Phosphor Bronze / phosphor bronze

Oberflächenbeschichtung / plating:

Kontaktbereich / mating area: 2-3 µm Ni 1.2 µm Au  
Anschlussbereich / termination: 2-3 µm Ni 1 µm Sn matt

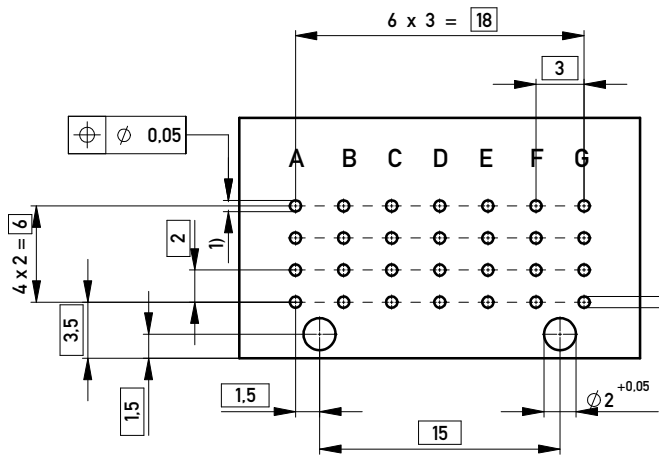

Lochbild für Leiterplatte  
Board hole pattern

1)  $\phi 0,6 \pm 0,05$  Durchmesser des metallisierten Loches  
 $\phi 0,6 \pm 0,05$  Diameter of finished plated-through hole

Schichtaufbau im metallisierten Loch  
siehe Zeichnung 114406 / 164062 Nr.1  
Metal plating of plated-through hole  
see drawing 114406 / 164062 Nr.1

Anforderungsstufe 1  
class 1

Information:	Tolerances	 All Dimensions in mm	Scale	3:1
	All rights reserved. Only for Information. To ensure that this is the latest version of this drawing, please contact one of the ERNI companies before using.		Subject to modification without prior notice. Drawing will not be updated.	Designation <b>ERmet Messerl. PM 7 pol RC</b> <b>ERmet Male PM 7 pin RC</b>
Index	Date	 www.ERNI.com	<b>100100420001</b>	I A3
			Class	ERPMP

Copyright by ERNI GmbH  
Proprietary notice pursuant to ISO 16018 to be observed.