

APPROVED: _____

DATE: _____ TITLE: _____

Rev	AWO #	Description	Date	Appr
-		RELEASED	11/17/10	
A		ADD 1.50MM INSULATOR	11/18/10	

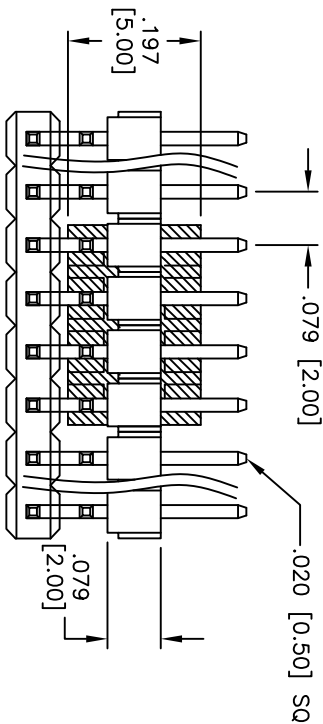
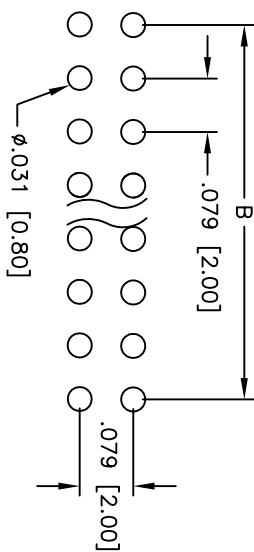
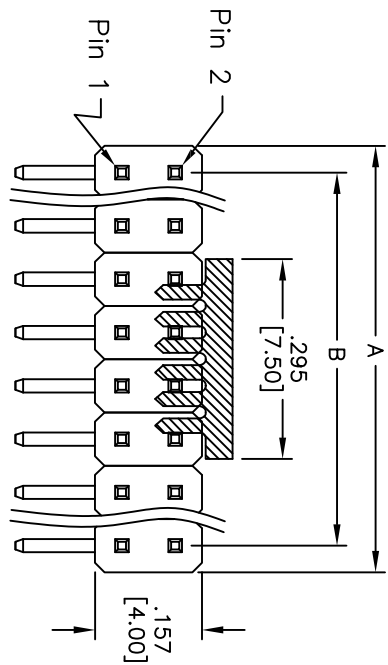

PCAKAGED ON TAPE & REEL

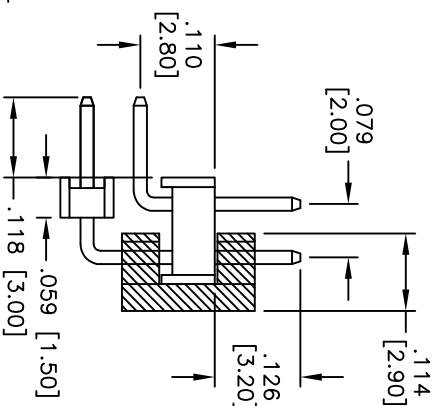

SPECIFICATIONS:

Material: Insulator: Hi-temp thermoplastic, rated UL 94V-0

Contacts: Brass

Plating: Matt Tin over Nickel underplate overall

Electrical: Current rating: 1 Amp max

Contact resistance: 20 mohms max @ DC 100mA

Insulation resistance: 5,000 Mohms min @ DC 500mA

Dielectric withstanding voltage: 500 VAC for 1 minute

Temperature Rating: Operating temperature: -55°C to +105°C

Environmental: Lead free, RoHS compliant Recommended soldering temp: 260°C for 5 seconds



A = .079 [2.00] x No. of Spaces + .069 [1.75]
B = .079 [2.00] x No. of Spaces

UNLESS OTHERWISE SPECIFIED ALL DIMENSIONS ARE INCHES [MM] TOLERANCES: EXCEPT AS NOTED INCHES Holes: .X ± .10 ØXX ± .015 .XX ± .020 ØXXX ± .010 .XXX ± .015 APPROVALS: DRAWN: AY 11/17/10 CHECKED: AH 11/17/10 APPROVED:

ADAM TECH

909 Railway Avenue, Union, NJ 07083
Phone: 908-687-5000 Fax: 908-687-5710

TITLE: .079 [2.00] DUAL ROW PIN HEADER, R/A
MATT TIN PLATED, PICK & PLACE CAPE

SIZE	PART NO.	REV.
X	2PHR-XX-MT-A9656-HT-PP-T/R	A
REF: S0059T	SCALE: NTS	SHEET 1 OF 1