

# Coaxial Directional Coupler

**NEW!**  
**ZNDC-18-2G**

50Ω 18dB 800 to 2000 MHz

## Maximum Ratings

Operating Temperature	-55°C to 100°C
Storage Temperature	-55°C to 100°C
Power Input	3W Max.

## Pin Connections

INPUT	1
OUTPUT	2
COUPLED	3

## Features

- excellent insertion loss, 0.5 dB typ.
- excellent VSWR, 1.15:1 typ.
- very flat coupling,  $\pm 0.3$  dB typ.

## Applications

- cellular
- PCS
- ISM



CASE STYLE: FM587  
PRICE: \$49.95 ea. QTY (1-9)

## Directional Coupler Electrical Specifications

FREQ. RANGE (MHz)	COUPLING (dB)		MAINLINE LOSS (dB)		DIRECTIVITY (dB)		VSWR (:1)	POWER INPUT (W)
	Nom.	Max. Flatness	Typ.	Max.	Typ.	Min.		
800-2000								
800-1000	18.5 $\pm$ 0.5	$\pm$ 0.3	0.3	0.6	22	17	1.1	3
1000-1700	18.2 $\pm$ 0.5	$\pm$ 0.4	0.5	0.9	25	18	1.2	3
1700-2000	18.0 $\pm$ 0.5	$\pm$ 0.35	0.6	1.1	25	14	1.3	3

## Outline Drawing

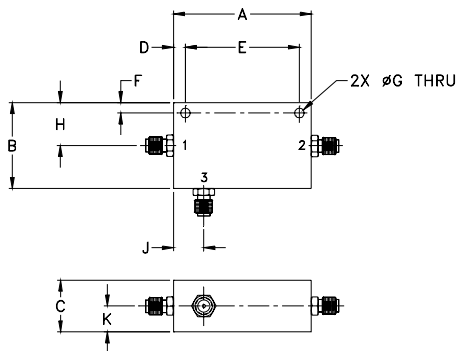

## Outline Dimensions (inch mm)

A	B	C	D	E	F	G	H
2.00	1.25	.75	.17	1.656	.15	.140	.63
50.80	31.75	19.05	4.32	42.06	3.81	3.56	16.00

J	K	wt.
.44	.38	grams
11.18	9.65	57

## Typical Performance Data

Frequency (MHz)	Insertion Loss (dB) In-Out	Coupling (dB) In-Cpl	Directivity (dB)	Return Loss (dB)		
				In	Out	Cpl
800.00	0.35	18.76	23.37	21.37	21.29	21.05
900.00	0.36	18.64	24.53	22.59	22.52	21.97
1000.00	0.38	18.53	25.86	24.03	23.48	22.73
1100.00	0.41	18.42	27.49	25.01	24.10	23.40
1300.00	0.46	18.23	30.98	25.09	23.78	23.61
1500.00	0.53	18.09	39.09	23.97	22.61	21.52
1700.00	0.58	17.98	35.88	23.18	21.27	19.43
1800.00	0.63	17.96	29.68	22.92	20.69	18.20
1900.00	0.67	17.97	25.97	22.85	20.31	16.89
2000.00	0.70	17.98	22.69	23.35	20.36	15.85

