

PLEASE CHECK WWW.MOLEX.COM FOR LATEST PART INFORMATION

Part Number: [0908790502](#)
Status: **Active**
Overview: [rast 5 connector system](#)
Description: 5.00mm (.197") Pitch Appli-Mate RAST 5 Header, Right Angle, Male, Natural, Unblocked Position Keys: 1B & 2A, Unblocked Coding Keys: 01C & D20, Latch Position 1/2, 2 Circuits

Documents:

[3D Model](#)
[Packaging Specification \(PDF\)](#)
[Drawing \(PDF\)](#)
[Product Specification PS-99020-0037 \(PDF\)](#)
[RoHS Certificate of Compliance \(PDF\)](#)

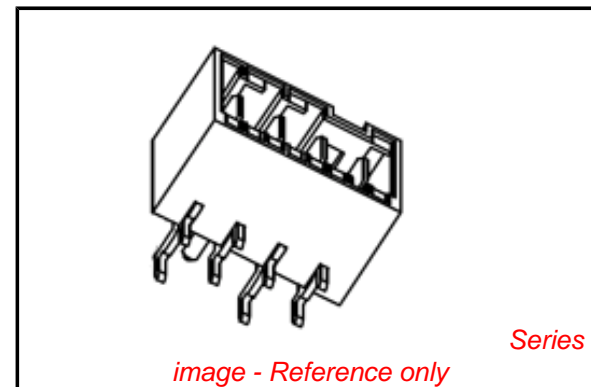

Agency Certification

CSA LR19980
 UL E29179

General

Product Family PCB Headers
 Series [90879](#)
 Application Wire-to-Board
 Comments Male Indirect Receptacle Reference K01
 Overview [rast 5 connector system](#)
 Product Name RAST 5

Physical

Breakaway No
 Circuits (Loaded) 3
 Circuits (maximum) 3
 Color - Resin Natural
 Durability (mating cycles max) 10
 First Mate / Last Break No
 Flammability 94V-0
 Glow-Wire Compliant No
 Guide to Mating Part No
 Keying to Mating Part None
 Lock to Mating Part Yes
 Material - Metal Brass
 Material - Plating Mating Tin
 Material - Resin Polyester
 Number of Rows 1
 Orientation Right Angle
 PC Tail Length (in) 0.154 In
 PC Tail Length (mm) 3.90 mm
 PCB Locator No
 PCB Retention N/A
 PCB Thickness Recommended (in) 0.055 In
 PCB Thickness Recommended (mm) 1.40 mm
 Packaging Type Bag
 Pitch - Mating Interface (in) 0.197 In
 Pitch - Mating Interface (mm) 5.00 mm
 Pitch - Term. Interface (in) 0.197 In
 Pitch - Term. Interface (mm) 5.00 mm
 Polarized to Mating Part Yes
 Polarized to PCB Yes
 Shrouded Fully
 Stackable No

EU RoHS

ELV and RoHS Compliant
REACH SVHC Contains SVHC: No
Halogen-Free Status

China RoHS



Need more information on product environmental compliance?

Email productcompliance@molex.com
 For a multiple part number RoHS Certificate of Compliance, [click here](#)

Please visit the [Contact Us](#) section for any non-product compliance questions.

Search Parts in this Series

[90879Series](#)

Mates With

[91338](#) Appli-Mate Female Connector. Appli-Mate 5.0 IDT Connector System Female Receptacle [90833](#) , [90835](#). Appli-Mate RAST 5 IDT Housing [91777](#) , [91778](#)

| | |
|--------------------------------|---------------|
| Surface Mount Compatible (SMC) | No |
| Temperature Range - Operating | -20C TO +120C |
| Termination Interface: Style | Through Hole |

Electrical

| | |
|-------------------------------|---------|
| Current - Maximum per Contact | 16A |
| Voltage - Maximum | 250V AC |

Solder Process Data

| | |
|--|------------------------|
| Duration at Max. Process Temperature (seconds) | 10 |
| Lead-free Process Capability | Wave Capable (TH only) |
| Process Temperature max. C | 260 |

Material Info

Reference - Drawing Numbers

| | |
|-------------------------|---------------|
| Packaging Specification | PK-90858-001 |
| Product Specification | PS-99020-0037 |
| Sales Drawing | SD-90879-001 |

This document was generated on 05/26/2010

PLEASE CHECK WWW.MOLEX.COM FOR LATEST PART INFORMATION

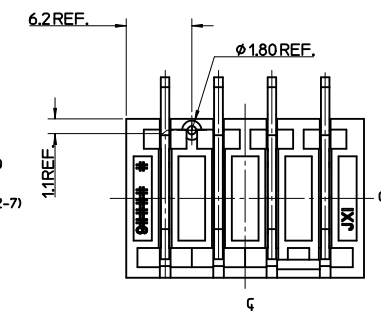
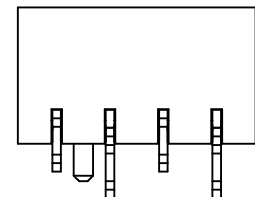
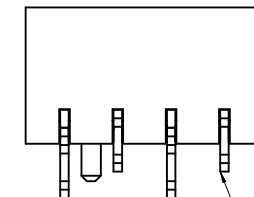
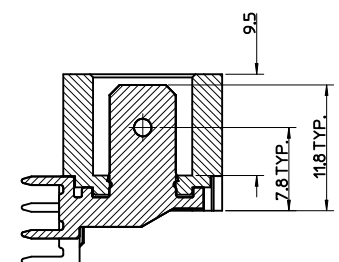
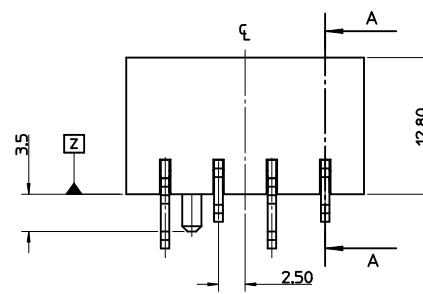
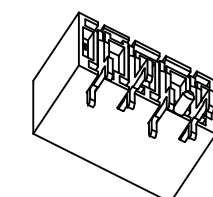
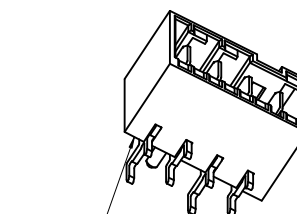
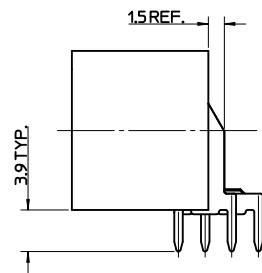
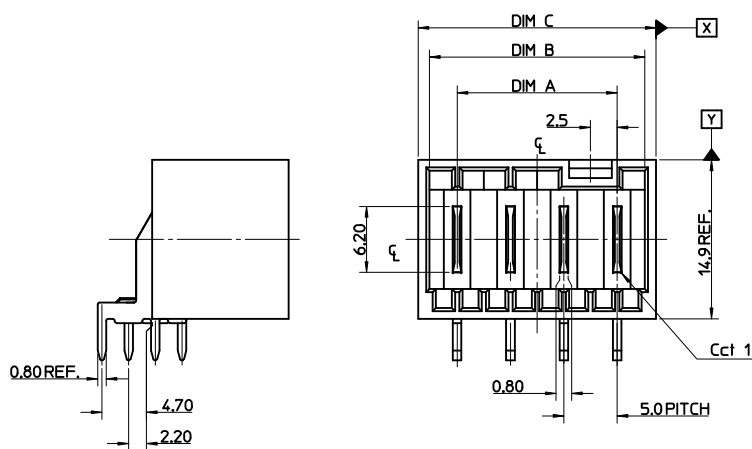

HOLES ON SOME TOOLED VERSIONS

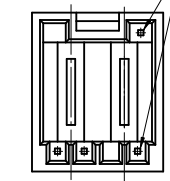

| CCT | DIM A | DIM B | DIM C | TOL |
|-----|-------|-------|-------|---------|
| 2 | 5.00 | 10.20 | 12.30 | |
| 3 | 10.00 | 15.20 | 17.30 | |
| 4 | 15.00 | 20.20 | 22.30 | |
| 5 | 20.00 | 25.20 | 27.30 | |
| 6 | 25.00 | 30.20 | 32.30 | +/-0.30 |
| 7 | 30.00 | 35.20 | 37.30 | |
| 8 | 35.00 | 40.20 | 42.30 | |
| 9 | 40.00 | 45.20 | 47.30 | |
| 10 | 45.00 | 50.20 | 52.30 | |
| 11 | 50.00 | 55.20 | 57.30 | |
| 12 | 55.00 | 60.20 | 62.30 | |

RECOMMENDED PCB LAYOUT

P.C.B. POLARISATION OPTION 'A'

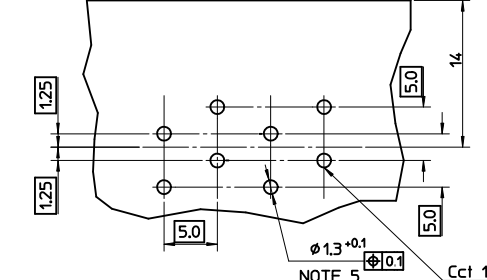

P.C.B. POLARISATION OPTION 'B' (FOR REVERSE FOOTPRINT)

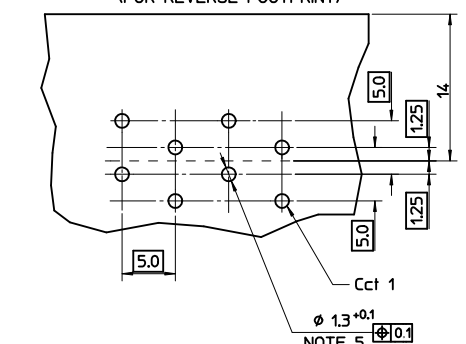

- NOTES:
- MATERIAL:
 - HOUSING: 30% GLASS-FILLED PBT, UL94 V-0
 - TERMINAL: BRASS 0.80 REF. THICK
 - PLATING: OPTIONAL (SEE CHARTS SHEETS 2-7)
 - 5µm TIN OVER
 - 2.5µm NICKEL ALLOVER
 - SELECTIVE SILVER
 - 2µm SILVER OVER
 - 2.5µm NICKEL ALLOVER
 - PRODUCT CONFORMS TO SPECIFICATION PS-99020-0037
 - MATES WITH MOLEX 91338, 90833, 90835, 91777, 91778 & 91779
 - PARTS PACKAGED LOOSE IN PLASTIC BAGS
 - PLATED THRU HOLE
 - RECOMMENDED PCB THICKNESS: 1.4±0.1mm.
 - PCB VIEW IS FROM SOLDER SIDE

| | | | | | | | | |
|--|--|--|---------|-----------------------------------|--------------------|---------------------------------|------------------------|------------------------|
| MOULD TOOLING CHANGE EC NO: E2010-0370 DRWN: BRUTTLE 2010/02/24 CHKD: DENNEHY 2004/05/23 APPR: BMAGUIRE 2010/06/08 | QUALITY SYMBOLS $\nabla=0$ $\nabla=0$ | GENERAL TOLERANCES (UNLESS SPECIFIED) | | DIMENSION STYLE MM ONLY | | SCALE 1:1 | DESIGN UNITS METRIC | THIRD ANGLE PROJECTION |
| | | 4 PLACES ± --- ± --- 3 PLACES ± --- ± --- 2 PLACES ± 0.1 ± --- 1 PLACE ± 0.2 ± --- ANGULAR ± 2 ° | mm INCH | DRAWN BY NMCNAMAR | DATE 2004/05/22 | TITLE RAST 5 R.A. HDR | | |
| DESCRIPTION REV J | DRAFT WHERE APPLICABLE MUST REMAIN WITHIN DIMENSIONS | MATERIAL NO. SEE SHEETS 2 TO 7 | | APPROVED BY BMAGUIRE | DATE 2004/05/27 | MOLEX INCORPORATED | | |
| | | SIZE A2 | | DOCUMENT NO. SD-90879-001 | | | SHEET NO. 1 OF 5 | |

2 CIRCUIT

SEE CODE DESIGNATION TABLE FOR NUMBERING
FORMAT WHEN ADDING NEW PART NUMBERS

P.C.B.
POLARISATION
OPTION.

| PART NO. (TIN) | COLOUR | UNBLOCKED POSITION KEYS | UNBLOCKED CODING KEYS | LATCH POSITION | CONFIGURATION (SEE NOTES) | REF | PART NO. (SILVER) | P.C.B. POLARISATION OPTION. |
|-------------------|---------|----------------------------|--------------------------|-------------------|------------------------------|-----|----------------------|-----------------------------------|
| 90879-0003 | NATURAL | 1b 2a | 01c d20 | 1/2 | | K01 | 90879-0499 | A |
| 90879-0046 | NATURAL | 1a 2b | 01c | 1/2 | | K02 | 90879-0498 | A |
| 90879-0026 | NATURAL | 1b 2b | 01c | 1/2 | | K09 | 90879-0488 | A |
| 90879-0018 | NATURAL | 2a | 01c, d20 | 1/2 | | K03 | 90879-0495 | A |
| 90879-0021 | NATURAL | 1b | 01c, d20 | 1/2 | | K16 | 90879-0492 | A |
| 90879-0022 | NATURAL | 1a 2b | NONE | 1/2 | | K06 | 90879-0491 | A |
| 90879-0019 | NATURAL | 1a 2b | d20 | 1/2 | | K05 | 90879-0478 | A |
| 90879-0058 | NATURAL | 2b | NONE | 1/2 | | K11 | 90879-0476 | A |
| 90879-0029 | NATURAL | 1a 1b | d20 | 1/2 | | K13 | 90879-0486 | A |
| 90879-0030 | NATURAL | 2a 2b | NONE | 1/2 | | K31 | 90879-0485 | A |
| 90879-0059 | NATURAL | 2b | d20 | 1/2 | | K38 | 90879-0475 | A |
| 90879-0060 | NATURAL | 1a 2a | 01c d20 | 1/2 | | K44 | 90879-0474 | A |
| 90879-0061 | NATURAL | 1a 1b | NONE | 1/2 | | K40 | 90879-0473 | A |
| 90879-0020 | NATURAL | 1a 1b | 01c | 1/2 | | K04 | 90879-0493 | A |
| 90879-0062 | NATURAL | 2b | 01c d20 | 1/2 | | K15 | 90879-0472 | A |
| 90879-0057 | NATURAL | 1a | 01c d20 | 1/2 | | K12 | 90879-0477 | A |
| 90879-0009 | NATURAL | 1a 2a | 01c | 1/2 | | K10 | 90879-0496 | A |
| 90879-0049 | NATURAL | ALL | d20 | 1/2 | | K34 | 90879-0481 | A |
| 90879-0056 | NATURAL | 1b 2a 2b | d20 | 1/2 | | K07 | 90879-0479 | A |
| 90879-0063 | NATURAL | 1b 2a | 01c d20 | 1/2 | | K01 | 90879-0471 | B |
| 90879-0064 | NATURAL | 2a | 01c | 1/2 | | k42 | 90879-0470 | A |
| | | | | | | | | |
| | | | | | | | | |

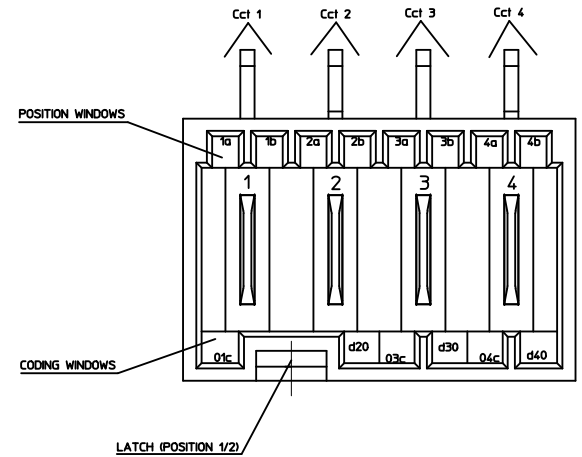

KEYING, CODING & LATCH POSITION
(4CCT EXAMPLE SHOWN)
VIEW INMATING DIRECTION

| | | | | | | |
|---|---------------------|---------------------------------------|---------------------|-------------------------------------|------------------------|--------------------|
| SEE SHEET 1 EC NO: DRWNBUTTLE 2010/02/24 CHKD: JDENNEY2004/05/23 APPR: BMAGUIRE 2010/06/08 | QUALITY SYMBOLS | GENERAL TOLERANCES (UNLESS SPECIFIED) | SCALE 1:1 | DESIGN UNITS METRIC | THIRD ANGLE PROJECTION | REVISE ON CAD ONLY |
| | ▽ - 0 | 4 PLACES ± --- ± --- | mm INCH | DIMENSION STYLE MM ONLY | TITLE RAST 5 R.A. HDR | |
| | ▽ - 0 | 3 PLACES ± --- ± --- | | DRAWN BY DATE | | |
| | | 2 PLACES ± 0.1 ± --- | | NMCNAMAR 2004/05/22 | | |
| | 1 PLACE ± 0.2 ± --- | | CHECKED BY DATE | | | |
| | ANGULAR ± 2 ° | | JDENNEY 2004/05/23 | | | |
| DRAFT WHERE APPLICABLE MUST REMAIN WITHIN DIMENSIONS | | | APPROVED BY DATE | MATERIAL NO. DOCUMENT NO. SHEET NO. | | |
| | | | BMAGUIRE 2004/05/27 | SEE CHART | SD-90879-001 | 2 OF 5 |
| THIS DRAWING CONTAINS INFORMATION THAT IS PROPRIETARY TO MOLEX INCORPORATED AND SHOULD NOT BE USED WITHOUT WRITTEN PERMISSION | | | | | | |

MOLEX INCORPORATED

| 3 CIRCUIT | | SEE CODE DESIGNATION TABLE FOR NUMBERING FORMAT WHEN ADDING NEW PART NUMBERS | | | | | P.C.B. POLARISATION OPTION | |
|-------------------|---------|---|--------------------------|-------------------|------------------------------|------|----------------------------------|---|
| PART NO. (TIN) | COLOUR | UNBLOCKED POSITION KEYS | UNBLOCKED CODING KEYS | LATCH POSITION | CONFIGURATION (SEE NOTES) | REF | PART NO. (SILVER) | |
| 90879-0502 | NATURAL | 1b | 01c, d20 | 1/2 | | K01 | 90879-1249 | A |
| 90879-0508 | NATURAL | 1a | 03c | 1/2 | | K04 | 90879-1248 | A |
| 90879-0528 | NATURAL | 1a 1b | d30 | 1/2 | | K05 | 90879-1247 | A |
| 90879-0512 | NATURAL | 1a 3b | 01c | 1/2 | | K06 | 90879-1246 | A |
| 90879-0513 | NATURAL | 1b | d20 03c | 1/2 | | K09 | 90879-1245 | A |
| 90879-0529 | NATURAL | 1b 2a 2b | d30 | 1/2 | | K33 | 90879-1244 | A |
| 90879-0530 | NATURAL | 2b | d20 | 1/2 | | K56 | 90879-1243 | A |
| 90879-0526 | NATURAL | ALL | d10 d30 | 2/3 | | K38 | 90879-1242 | A |
| 90879-0527 | NATURAL | ALL | d20 | 1/2 | | K40 | 90879-1241 | A |
| 90879-0531 | NATURAL | 2b, 3a | d10, d30 | 2/3 | | K--- | 90879-1240 | A |
| 90879-0532 | NATURAL | 2b, 3b | d10, 02c | 2/3 | | K--- | 90879-1239 | A |
| 90879-0533 | NATURAL | 1b | 01c, d20 | 1/2 | | K01 | 90879-1238 | B |
| 90879-0534 | NATURAL | 1b, 2a, 2b, 3b, | NONE | 2/3 | | K--- | 90879-1237 | B |
| | | | | | | | | |
| | | | | | | | | |
| | | | | | | | | |

| 4 CIRCUIT | | SEE CODE DESIGNATION TABLE FOR NUMBERING FORMAT WHEN ADDING NEW PART NUMBERS | | | | | P.C.B. POLARISATION OPTION | |
|-------------------|---------|---|--------------------------|-------------------|------------------------------|------|----------------------------------|---|
| PART NO. (TIN) | COLOUR | UNBLOCKED POSITION KEYS | UNBLOCKED CODING KEYS | LATCH POSITION | CONFIGURATION (SEE NOTES) | REF | PART NO. (SILVER) | |
| 90879-1254 | NATURAL | 1b | 03c d40 | 1/2 3/4 | | K01 | 90879-1999 | A |
| 90879-1264 | NATURAL | 1a 4b | d40 | 1/2 3/4 | | K03 | 90879-1997 | A |
| 90879-1265 | NATURAL | 2a 4b | d20 | 1/2 3/4 | | K07 | 90879-1996 | A |
| 90879-1267 | NATURAL | 1b 2a 3a 4b | 01c d40 | 1/2 3/4 | | K37 | 90879-1994 | A |
| 90879-1278 | NATURAL | 1a 2b 4b | 01c 03c d40 | 1/2 3/4 | | K44 | 90879-1988 | A |
| 90879-1279 | NATURAL | 1a 3a 3b | 01c d20 d40 | 1/2 3/4 | | K32 | 90879-1987 | A |
| 90879-1280 | NATURAL | 1b 2a 4b | 01c d20 03c | 1/2 3/4 | | K61 | 90879-1986 | A |
| 90879-1281 | NATURAL | 1a 3a | d40 | 1/2 3/4 | | K06 | 90879-1985 | A |
| 90879-1282 | NATURAL | 1a 2b 3b 4a | 01c 03c d40 | 1/2 3/4 | | K65 | 90879-1984 | A |
| 90879-1266 | NATURAL | 2a 4b | d20 03c | 1/2 3/4 | | K30 | 90879-1995 | A |
| 90879-1276 | NATURAL | 3b | d30 | 2/3 | | K04 | 90879-1989 | A |
| 90879-1283 | NATURAL | 1b, 2a, 3a, 4b | d20, d40 | 1/2, 3/4 | | K109 | 90879-1983 | A |
| 90879-1284 | NATURAL | ALL | ALL | 1/2, 3/4 | | --- | 90879-1982 | A |
| | | | | | | | | |
| | | | | | | | | |
| | | | | | | | | |

| SEE SHEET 1 EC NO: DRWINBRUTTLE 2010/02/24 CHKD: JDENNEHY2004/05/23 APPR: BMAGUIRE 2010/06/08 REV | QUALITY SYMBOLS | GENERAL TOLERANCES (UNLESS SPECIFIED) | SCALE 1:1 | DESIGN UNITS METRIC | THIRD ANGLE PROJECTION | REVISE ON CAD ONLY | | | | | | | | | | | | | |
|---|--|---|-----------|---------------------|------------------------|--------------------|-------|-------|----------|-------|-------|----------|-------|-------|---------|-------|-------|-------------------------|-----------------------|
| | 0 0 | <table border="1"> <tr> <th></th> <th>mm</th> <th>INCH</th> </tr> <tr> <td>4 PLACES</td> <td>± ---</td> <td>± ---</td> </tr> <tr> <td>3 PLACES</td> <td>± ---</td> <td>± ---</td> </tr> <tr> <td>2 PLACES</td> <td>± 0.1</td> <td>± ---</td> </tr> <tr> <td>1 PLACE</td> <td>± 0.2</td> <td>± ---</td> </tr> </table> | | mm | INCH | 4 PLACES | ± --- | ± --- | 3 PLACES | ± --- | ± --- | 2 PLACES | ± 0.1 | ± --- | 1 PLACE | ± 0.2 | ± --- | DIMENSION STYLE MM ONLY | TITLE RAST 5 R.A. HDR |
| | | | mm | INCH | | | | | | | | | | | | | | | |
| | 4 PLACES | ± --- | ± --- | | | | | | | | | | | | | | | | |
| 3 PLACES | ± --- | ± --- | | | | | | | | | | | | | | | | | |
| 2 PLACES | ± 0.1 | ± --- | | | | | | | | | | | | | | | | | |
| 1 PLACE | ± 0.2 | ± --- | | | | | | | | | | | | | | | | | |
| ANGULAR ± 2 ° DRAFT WHERE APPLICABLE MUST REMAIN WITHIN DIMENSIONS | DRAWN BY NMCNAMAR DATE 2004/05/22 CHECKED BY JDENNEHY DATE 2004/05/23 APPROVED BY BMAGUIRE DATE 2004/05/27 | MATERIAL NO. SEE CHART DOCUMENT NO. SD-90879-001 SHEET NO. 3 OF 5 | | | | | | | | | | | | | | | | | |
| THIS DRAWING CONTAINS INFORMATION THAT IS PROPRIETARY TO MOLEX INCORPORATED AND SHOULD NOT BE USED WITHOUT WRITTEN PERMISSION | | | | | | A1 | | | | | | | | | | | | | |

| 5 CIRCUIT | | SEE CODE DESIGNATION TABLE FOR NUMBERING FORMAT WHEN ADDING NEW PART NUMBERS | | | | | | P.C.B. POLARISATION OPTION |
|-------------------|---------|---|--------------------------|-------------------|------------------------------|-----|----------------------|----------------------------------|
| PART NO. (TIN) | COLOUR | UNBLOCKED POSITION KEYS | UNBLOCKED CODING KEYS | LATCH POSITION | CONFIGURATION (SEE NOTES) | REF | PART NO. (SILVER) | |
| 90879-2000 | NATURAL | 1a 5b | 01c d30 | 1/2 2/3 | | K01 | 90879-2749 | A |
| 90879-2001 | NATURAL | 1a 3a | 01c d30 | 1/2 4/5 | | K30 | 90879-2748 | A |
| 90879-2002 | NATURAL | 1a 5b | 01c d20 03c d50 | 1/2 3/4 | | K31 | 90879-2747 | A |
| 90879-2003 | NATURAL | 1b 2a 3b 5a | 01c 03c | 1/2 3/4 | | K35 | 90879-2746 | A |
| 90879-2023 | NATURAL | 1a 2a 2b 4b 5b | 01c d30 04c d50 | 1/2 2/3 4/5 | | K36 | 90879-2732 | A |
| 90879-2024 | NATURAL | 2a | 01c d50 | 2/3 4/5 | | K43 | 90879-2731 | A |
| 90879-2025 | NATURAL | 2a 4b | 01c d20 d40 | 1/2 3/4 | | K44 | 90879-2730 | A |
| 90879-2026 | NATURAL | 2b | d20 | 1/2 4/5 | | K02 | 90879-2729 | A |
| 90879-2027 | NATURAL | 4b 5a | 01c d30 04c d50 | 1/2 4/5 | | K45 | 90879-2728 | A |
| 90879-2028 | NATURAL | NONE | 01c d40 | 1/2 3/4 | | K46 | 90879-2727 | A |
| 90879-2029 | NATURAL | 1a 4b | d30 | 1/2 4/5 | | K04 | 90879-2726 | A |
| 90879-2030 | NATURAL | 1a 5b | d20 d40 | 1/2 3/4 | | K77 | 90879-2725 | A |
| 90879-2005 | NATURAL | 1b 2b 4a | d20 d30 d50 | 1/2 4/5 | | K40 | 90879-2744 | A |
| 90879-2016 | NATURAL | 3b 4a 5b | 01c d30 d50 | 2/3 4/5 | | k47 | 90879-2738 | A |
| 90879-2018 | NATURAL | 1a 4b | 01c | 1/2 3/4 | | K48 | 90879-2736 | A |
| 90879-2020 | NATURAL | 1a 5b | d30 04c | 2/3 | | K50 | 90879-2734 | A |
| 90879-2021 | NATURAL | 1b 2a 4a | 01c 04c d50 | 1/2 4/5 | | K51 | 90879-2733 | A |
| 90879-2022 | NATURAL | 2b 3b 4a | 01c d20 d40 | 1/2 3/4 | | K52 | 90879-2735 | A |

| 6 CIRCUIT | | SEE CODE DESIGNATION TABLE FOR NUMBERING FORMAT WHEN ADDING NEW PART NUMBERS | | | | | | P.C.B. POLARISATION OPTION |
|-------------------|---------|---|--------------------------|-------------------|------------------------------|-----|----------------------|----------------------------------|
| PART NO. (TIN) | COLOUR | UNBLOCKED POSITION KEYS | UNBLOCKED CODING KEYS | LATCH POSITION | CONFIGURATION (SEE NOTES) | REF | PART NO. (SILVER) | |
| 90879-2753 | NATURAL | 1b | 03c d60 | 1/2 4/5 | | K01 | 90879-3499 | A |
| 90879-2754 | NATURAL | 1a 3b 4b | 01c d50 06c | 1/2 4/5 | | K30 | 90879-3498 | A |
| 90879-2755 | NATURAL | 1a 1b 2b 3a 3b 4b | d30 04c d50 | 1/2 2/3 4/5 | | K37 | 90879-3497 | A |
| 90879-2756 | NATURAL | 1a 1b 4a 4b | d10 d50 | 2/3 4/5 | | K39 | 90879-3496 | A |
| 90879-2757 | NATURAL | 2a 4b 5a 6b | d20 03c 05c | 1/2 3/4 5/6 | | K42 | 90879-3495 | A |
| 90879-2758 | NATURAL | 1a 2b 3a 3b 5b 6b | 01c d40 d60 | 1/2 3/4 5/6 | | K43 | 90879-3494 | A |
| 90879-2759 | NATURAL | 1b 2a 3a 4b 5a 5b 6b | 01c 03c d60 | 1/2 3/4 5/6 | | K44 | 90879-3493 | A |
| 90879-2760 | NATURAL | 2b | d20 d60 | 1/2 5/6 | | K46 | 90879-3492 | A |
| 90879-2761 | NATURAL | 2b 3b 4a | 01c d50 06c | 1/2 4/5 | | K36 | 90879-3491 | A |
| 90879-2762 | NATURAL | 1b 4b | d20 03c d50 06c | 1/2 4/5 | | K58 | 90879-3486 | A |
| 90879-2764 | NATURAL | 1a 2b 3b 4a 6b | 01c 03c d40 05c d60 | 1/2 3/4 5/6 | | K59 | 90879-3485 | A |
| 90879-2765 | NATURAL | 1a 2b 4a 6b | 01c d40 | 1/2 3/4 5/6 | | K62 | 90879-3484 | A |
| 90879-2763 | NATURAL | 1b 2b 3b | 01c 05c d60 | 1/2 3/4 5/6 | | K51 | 90879-3490 | A |
| 90879-2766 | NATURAL | 1b | d20 03c | 1/2 4/5 | | K55 | 90879-3489 | A |
| 90879-2767 | NATURAL | 1b 2a 3a 5a 5b | 01c d20 03c d40 d60 | 1/2 3/4 5/6 | | K56 | 90879-3488 | A |
| 90879-2771 | NATURAL | 1a 3a 3b 5b 6a | 01c d20 240 05c d60 | 1/2 3/4 5/6 | | K60 | 90879-3487 | A |

| SEE SHEET 1 | EC NO: 2010/02/24 DRW: BRUTTLE 2010/02/24 CHK: JDENNEHY 2004/05/23 APPR: BMAGUIRE 2010/06/08 | QUALITY SYMBOLS 0 1 | GENERAL TOLERANCES (UNLESS SPECIFIED) | | SCALE 1:1 | DESIGN UNITS METRIC | THIRD ANGLE PROJECTION | REVISE ON CAD ONLY | | | | | | | | | | | | | | | | | |
|--|---|---------------------------|---|--------------------------------------|-----------|---|------------------------|--------------------|-------|-------|----------|-------|-------|----------|-------|-------|---------|-------|-------|-------------------------|--|-----------------------|--|--|--|
| | | | <table border="1"> <tr><th></th><th>mm</th><th>INCH</th></tr> <tr><td>4 PLACES</td><td>± ---</td><td>± ---</td></tr> <tr><td>3 PLACES</td><td>± ---</td><td>± ---</td></tr> <tr><td>2 PLACES</td><td>± 0.1</td><td>± ---</td></tr> <tr><td>1 PLACE</td><td>± 0.2</td><td>± ---</td></tr> </table> | | | mm | INCH | 4 PLACES | ± --- | ± --- | 3 PLACES | ± --- | ± --- | 2 PLACES | ± 0.1 | ± --- | 1 PLACE | ± 0.2 | ± --- | DIMENSION STYLE MM ONLY | | TITLE RAST 5 R.A. HDR | | | |
| | | | | mm | INCH | | | | | | | | | | | | | | | | | | | | |
| | | | 4 PLACES | ± --- | ± --- | | | | | | | | | | | | | | | | | | | | |
| 3 PLACES | ± --- | ± --- | | | | | | | | | | | | | | | | | | | | | | | |
| 2 PLACES | ± 0.1 | ± --- | | | | | | | | | | | | | | | | | | | | | | | |
| 1 PLACE | ± 0.2 | ± --- | | | | | | | | | | | | | | | | | | | | | | | |
| DRAFT WHERE APPLICABLE MUST REMAIN WITHIN DIMENSIONS | | ANGULAR ± 2 ° | | DRAWN BY DATE NMCNAMAR 2004/05/22 | | MATERIAL NO. DOCUMENT NO. SHEET NO. SEE CHART SD-90879-001 4 OF 5 | | | | | | | | | | | | | | | | | | | |
| | | | | APPROVED BY DATE JDENNEHY 2004/05/23 | | MOLEX INCORPORATED THIS DRAWING CONTAINS INFORMATION THAT IS PROPRIETARY TO MOLEX INCORPORATED AND SHOULD NOT BE USED WITHOUT WRITTEN PERMISSION | | | | | | | | | | | | | | | | | | | |

| 7 CIRCUIT | | SEE CODE DESIGNATION TABLE FOR NUMBERING FORMAT WHEN ADDING NEW PART NUMBERS | | | | | P.C.B. POLARISATION OPTION | |
|-------------------|---------|---|--------------------------|-------------------|------------------------------|-----|----------------------------------|---|
| PART NO. (TIN) | COLOUR | UNBLOCKED POSITION KEYS | UNBLOCKED CODING KEYS | LATCH POSITION | CONFIGURATION (SEE NOTES) | REF | PART NO. (SILVER) | |
| 90879-3500 | NATURAL | NONE | 03c d40 07c | 1/2 5/6 | | K01 | 90879-4220 | A |
| 90879-3512 | NATURAL | 3a 4a | d30 d70 | 1/2 5/6 | | K30 | 90879-4248 | A |
| 90879-3504 | NATURAL | 2b | d20 d60 | 1/2 5/6 | | K32 | 90879-4247 | A |
| 90879-3513 | NATURAL | 1a 1b 3a 4b 5a | 01c 07c | 1/2 3/4 5/6 | | K40 | 90879-4240 | A |
| 90879-3514 | NATURAL | 2a | 01c d50 | 2/3 4/5 | | K41 | 90879-4239 | A |
| 90879-3515 | NATURAL | 7b | 01c d40 d70 | 1/2 3/4 6/7 | | K43 | 90879-4238 | A |
| 90879-3516 | NATURAL | 1b | 03c d60 | 1/2 4/5 | | K31 | 90879-4237 | A |
| 90879-3517 | NATURAL | 1a 3a 4b 7b | 01c d20 03c 06c | 1/2 3/4 6/7 | | K45 | 90879-4236 | A |
| 90879-3518 | NATURAL | 1b 7a | 02c d50 | 2/3 6/7 | | K48 | 90879-4235 | A |
| 90879-3519 | NATURAL | 1a 2b 3a 4b 6a | d20 03c d40 d50 d70 | 1/2 3/4 6/7 | | K51 | 90879-4234 | A |
| 90879-3520 | NATURAL | 1b 6a | d20 03c d50 d70 | 1/2 3/4 6/7 | | K69 | 90879-4233 | A |
| 90879-3505 | NATURAL | 1b 2a 5a 5b 7b | d20 d50 06c d70 | 1/2 4/5 6/7 | | K34 | 90879-4246 | A |
| 90879-3506 | NATURAL | 2b | d20 07c | 1/2 3/4 5/6 | | K35 | 90879-4245 | A |
| 90879-3507 | NATURAL | 2a 2b 4b 5b 6a | d20 03c d40 d60 | 1/2 3/4 5/6 | | K38 | 90879-4244 | A |
| 90879-3510 | NATURAL | 2b 4a 4b 5b 6a | 01c d20 d40 d60 | 1/2 3/4 5/6 | | K42 | 90879-4241 | A |
| | | | | | | | | |

| | | | | | | |
|---|-----------------|---|--------------------------------------|---------------------|---|--------------------|
| SEE SHEET 1 EC NO: DRW:BRUTTLE 2010/02/24 CHKD: JDENNEHY2004/05/23 APPR: BMAGUIRE 2010/06/08 | QUALITY SYMBOLS | GENERAL TOLERANCES (UNLESS SPECIFIED) | SCALE 1:1 | DESIGN UNITS METRIC | THIRD ANGLE PROJECTION | REVISE ON CAD ONLY |
| | | mm INCH | DIMENSION STYLE MM ONLY | | TITLE RAST 5 R.A. HDR | |
| | | 4 PLACES ± --- ± --- 3 PLACES ± --- ± --- 2 PLACES ± 0.1 ± --- 1 PLACE ± 0.2 ± --- | DRAWN BY DATE NMCNAMAR 2004/05/22 | | CHECKED BY DATE JDENNEHY 2004/05/23 | |
| | ANGULAR ± 2 ° | | APPROVED BY DATE BMAGUIRE 2004/05/27 | | THIS DRAWING CONTAINS INFORMATION THAT IS PROPRIETARY TO MOLEX INCORPORATED AND SHOULD NOT BE USED WITHOUT WRITTEN PERMISSION | |
| DRAFT WHERE APPLICABLE MUST REMAIN WITHIN DIMENSIONS | | | | | | |