

Verpackt im Gurt nach DIN IEC 60286-3
 Tape on Reel Packaging according to DIN IEC 60286-3
 Verpackungseinheit: 1000 Stück
 Packaging unit: 1000 pcs

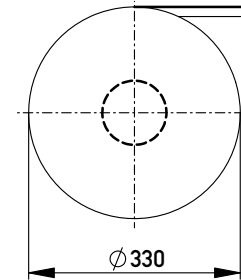

Anforderungsstufe 1
 Performance Level 1

Kontaktbereich vergoldet
 Mating Area gold plating

Anschlussbereich verzinkt 4-6 µm
 Terminal Area 4-6 µm tin plating

Koplanarität der Anschlüsse ≤ 0,1 mm
 Coplanarity Area of Termination ≤ 0,1 mm

Abspulrichtung - Reel off Direction

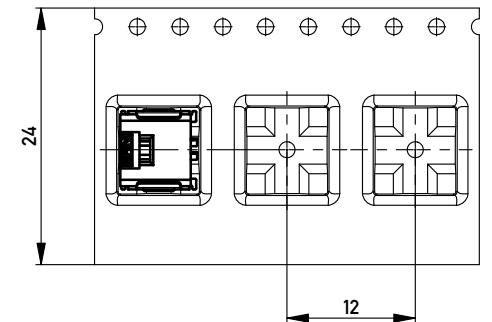

Leiterplatten-Layout für SMT
 PCB-Layout for SMT

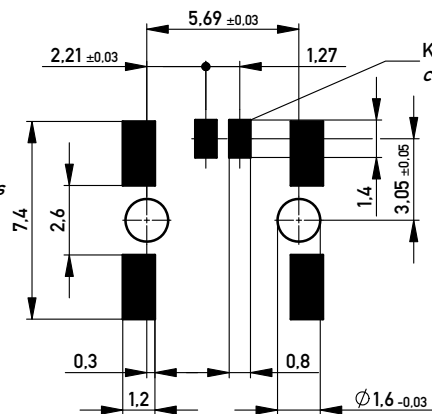

Kontaktbezeichnung bei Pin 1
 contact marking at pin 1

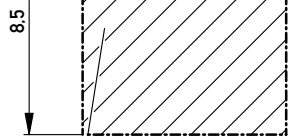

Sperrfläche für Leiterbahnen
 gültig bei Verwendung von
 Gegenstecker Federleiste 90°
 in SKV Ausführung
 Restricted area for conductors
 valid for use by mating
 female connector 90°
 in IDC version

1) gültig bei Verwendung von Gegenstecker
 Federleiste 90° in SMD Ausführung
 valid for use by mating female connector 90°
 in SMD version

Für die Anforderung nach PG 9 der LV214
 (Koshiri-Sicherheit)

For the requirement of the LV214 PG 9
 (Koshiri-security)

Information:	Tolerances	 All Dimensions in mm	Scale	5:1
			Designation	
All rights reserved. Only for Information. To ensure that this is the latest version of this drawing, please contact one of the ERNI companies before using.			M 1.27 SRC A, 2-polig KS M 1.27 SRC A, 2-pin KS	
			www.ERNI.com	
a	20.03.2014	474108		I
Index	Date	Class SRCA		A3

Copyright by ERNI GmbH
 Proprietary notice pursuant to ISO 9006 to be observed.