

## Model:KMG9626

### characteristics:

It applies to electronic fence.

### Technical indicators:

Installation method: sub-plate mount

Flame resistance: UL94-V0

Operating temperature:  $-20^{\circ}\text{C}\sim+50^{\circ}\text{C}$

Storage temperature:  $-40^{\circ}\text{C}\sim+85^{\circ}\text{C}$

Frequency range: 60Hz $\sim$ 5KHz

Dielectric strength: 15KV



### Electrical parameters:

primary resistance	0.6	$\Omega$
secondary resistance	9.9	$\Omega$
primary inductance	8	mH
secondary inductance	530	mH
turns ratio	1:8.2	
input voltage (Peak-Peak)		V
output voltage	>1.8	KV
output power		W
no-load work time		s
Weight		g

### Connection diagram:

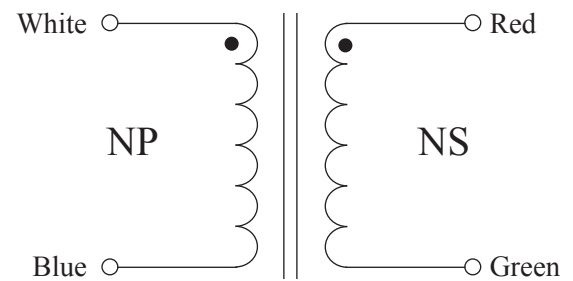

### Dimensions (in mm) :

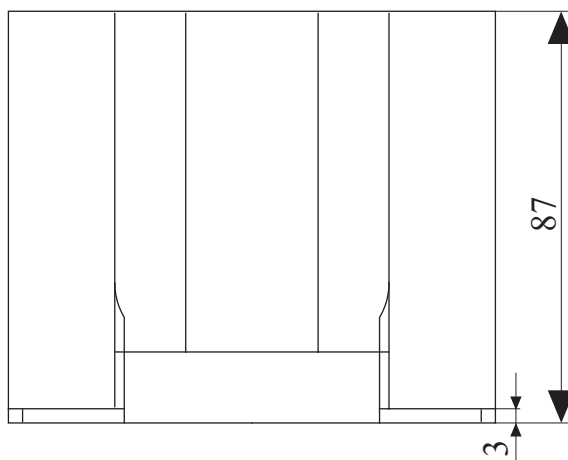

Front View

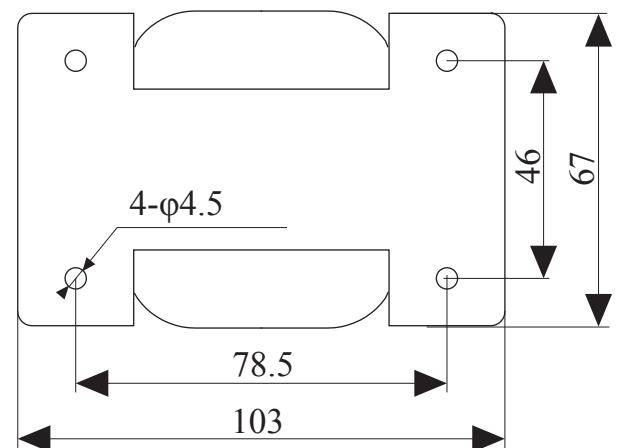

Bottom View