

NOTE:  
 1. Operating Force: 230gf±50gf  
 2. Travel : 2.4±0.2mm  
 Push To Lock

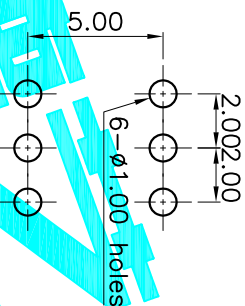

PCB Layout(Pattern Side)

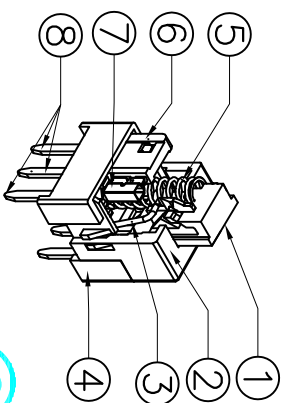
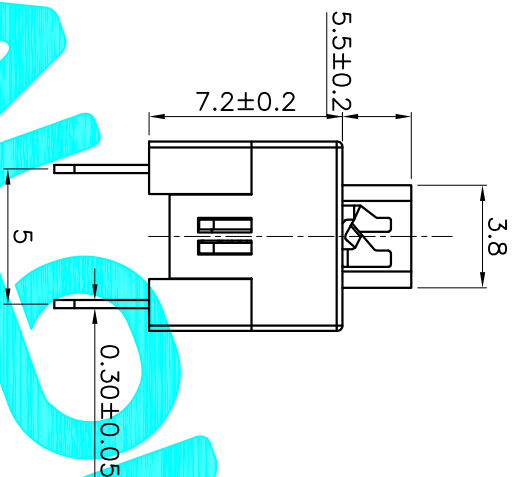
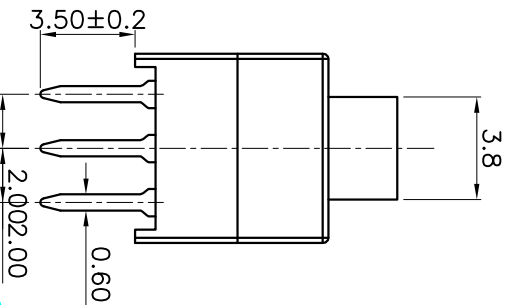
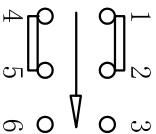
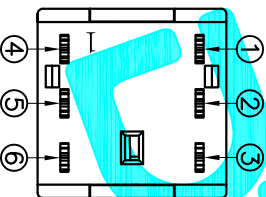

Circuit Diagram

⑧	Terminal	6	Brass strip	Plating silver
⑦	Contact	2	Phosphor bronze	Plating silver
⑥	Securing glue	2	PA66	Black
⑤	Spring	1	SUS	Natural
④	Base	1	PBT	Black
③	Crochet Needle	1	SUS	Natural
②	Cover	1	POM	White
①	Knob	1	POM	Blue
ITEM	PART NAME	QTY.	MATERIAL	FINISHING

APPROVALS		DATE	DRAWING NO.	
DRAWN	G.M.Chen	2015/4/16	PB-22E72	
CHECKED			TITLE: PUSH SWITCH	
APPROVALS			PART NO.	
TOLERANCES ARE		±0.30	ANGLE	±2°
30 <sup>±0.15</sup>	10 <sup>±0.10</sup>	±0.20	UNIT: mm	SCALE: 1:1
9 <sup>±0.10</sup>	5 <sup>±0.10</sup>	±0.15	DRAWING NO.	SHEET 1 OF 1
ECN NO.	REV.	DATE.	DESCRIPTION.	PROJ.
	A		NEW	

