

4mm Full Safety Spade Terminal

Features

- UL/CSA Compliant
- Accepts All Industry Standard 4mm Test Lead Plugs
- Tiered Spade Opening Accommodates a Variety of Test Point Sizes



| NTE Type No. | Color | Diag No. |
|----------------|-----------------------------------|----------|
| 72-026 | Black | TL-017 |
| 72-027 | Red | TL-017 |
| NEW 72-027-KIT | Contains 1 ea. of 72-026 & 72-027 | |

TL-017

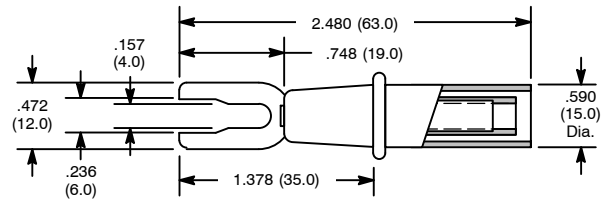

Specifications

IEC 1010 Rating: 1000V CAT3 / 600V CAT4 □ 20 Amps

4mm to 4mm Safety Plug Adaptor

Features

- Accepts All Industry Standard 4mm Test Lead Plugs
- Adapts Old Style Non Shrouded Sockets to Accept Full Safety Shrouded Plugs



| NTE Type No. | Color | Diag No. |
|----------------|-----------------------------------|----------|
| 72-028 | Black | TL-018 |
| 72-029 | Red | TL-018 |
| NEW 72-029-KIT | Contains 1 ea. of 72-028 & 72-029 | |

TL-018

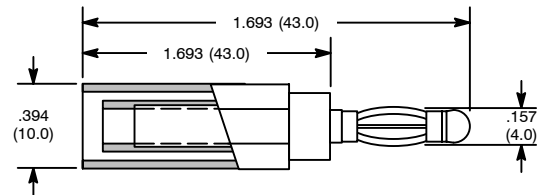

4mm to 4mm Coupler

Features

- Ideal for Connecting Two Test Leads Together
- Standard Colors: Black, Red



| NTE Type No. | Color | Diag No. |
|----------------|-----------------------------------|----------|
| 72-051 | Black | TL-020 |
| 72-052 | Red | TL-020 |
| NEW 72-052-KIT | Contains 1 ea. of 72-051 & 72-052 | |

TL-020

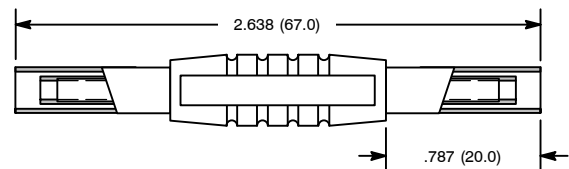

Specifications

IEC 1010 Rating: 1000V CAT3 □ 10 Amps

DIN Rail Terminal Test Adaptor

Features

- Enables DIN Rail Mounted Terminals to Accept 4mm Test Leads
- Adaptor Screws into Current Bar and Allows Easy and Convenient Access
- Uses M3 Thread Connection

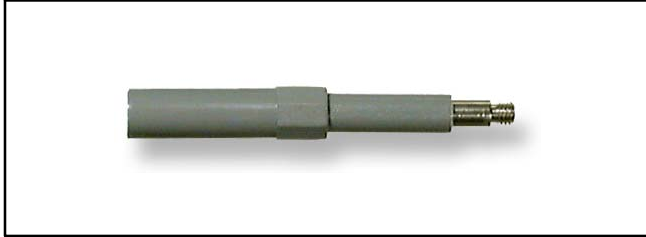

| NTE Type No. | Color | Diag No. |
|--------------|-------|----------|
| 72-030 | Grey | TL-019 |

TL-019

