

**PLEASE CHECK WWW.MOLEX.COM FOR LATEST PART INFORMATION**

**Part Number:** [0490680710](#)  
**Status:** **Active**  
**Description:** 4.20mm (.165") Pitch & 6.50mm (.256") Pitch Hybrid Wire-to-Board Header 7 Pins

**Documents:**

[Drawing \(PDF\)](#) [RoHS Certificate of Compliance \(PDF\)](#)  
[Product Specification PS-49068-001 \(PDF\)](#)

**Agency Certification**

UL E29179

**General**

Product Family PCB Headers  
 Series [49014](#)  
 Application Wire-to-Board  
 Product Name N/A

**Physical**

Breakaway No  
 Circuits (Loaded) 7  
 Circuits (maximum) 7  
 Color - Resin Natural  
 Durability (mating cycles max) 30  
 First Mate / Last Break No  
 Flammability 94V-0  
 Glow-Wire Compliant No  
 Guide to Mating Part No  
 Keying to Mating Part None  
 Lock to Mating Part Yes  
 Material - Metal Brass  
 Material - Plating Mating Tin  
 Material - Plating Termination Tin  
 Material - Resin Polyester Alloy  
 Number of Rows 1  
 Orientation Right Angle  
 PC Tail Length (in) 0.134 In  
 PC Tail Length (mm) 3.40 mm  
 PCB Locator No  
 PCB Retention None  
 Packaging Type Bag  
 Pitch - Mating Interface (in) 0.165 In, 0.220 In, 0.256 In  
 Pitch - Mating Interface (mm) 4.20 mm, 5.60 mm, 6.50 mm  
 Pitch - Term. Interface (in) 0.165 In, 0.220 In, 0.256 In  
 Pitch - Term. Interface (mm) 4.20 mm, 5.60 mm, 6.50 mm  
 Polarized to Mating Part Yes  
 Polarized to PCB Yes  
 Shrouded Fully  
 Stackable No  
 Surface Mount Compatible (SMC) No  
 Temperature Range - Operating -40°C to +105°C  
 Termination Interface: Style Through Hole

**Electrical**

Current - Maximum per Contact 7A  
 Voltage - Maximum 300V AC (RMS)/DC

**Material Info**

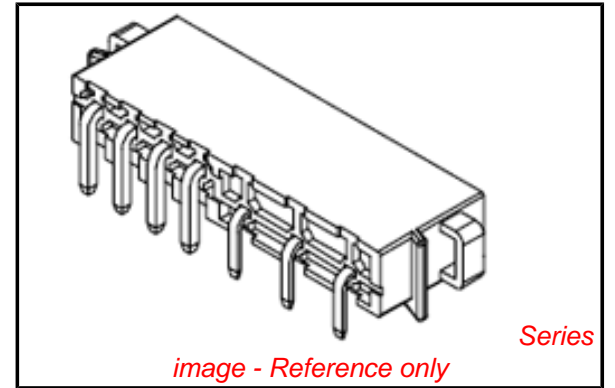

*image - Reference only*

**EU RoHS**

**ELV and RoHS  
 Compliant**  
**REACH SVHC**  
 Not Reviewed  
**Halogen-Free  
 Status**

**China RoHS**



**Need more information on product  
 environmental compliance?**

Email [productcompliance@molex.com](mailto:productcompliance@molex.com)  
 For a multiple part number RoHS Certificate of  
 Compliance, [click here](#)

Please visit the [Contact Us](#) section for any  
 non-product compliance questions.

**Search Parts in this Series**

[49014Series](#)

**Mates With**

[495060700 Hybrid Wire-to-Board Housing](#)

**Reference - Drawing Numbers**

Product Specification  
Sales Drawing

PS-49068-001  
SD-49068-001

This document was generated on 04/21/2010

**PLEASE CHECK [WWW.MOLEX.COM](http://WWW.MOLEX.COM) FOR LATEST PART INFORMATION**

DWG. NO.  
SD-49068-001

SIMILAR ITEM

PROJECT NO.

B

DO NOT SCALE DRAWING  
DIMENSION IN METRIC

8 7 6 5 4 3 2 1

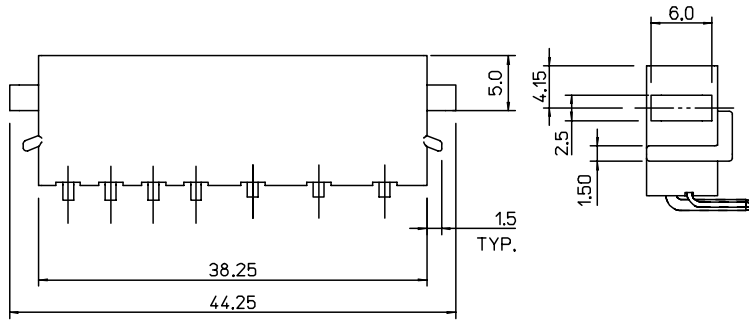

NOTES

1. MATERIAL & PART LIST : SEE [ TABLE 1 ]
2. MATED HOUSING : 49506-0700

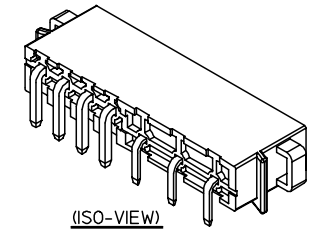

[ TABLE 1 ]

HEADER ASS'Y PART		
NO.	DESCRIPTION	MATERIAL
①	WAFER BASE	POLYESTER, UL94V-0 (GWIT)
②	.110 TAB-PIN	BRASS, TIN PLATED
③	1.07 SQ PIN	BRASS, TIN PLATED

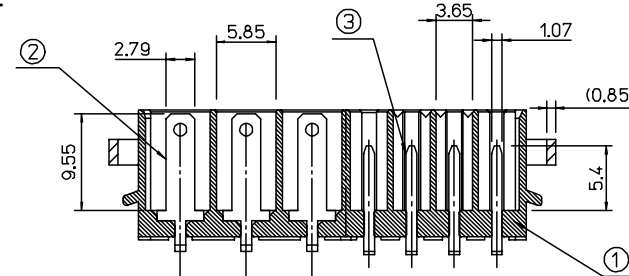
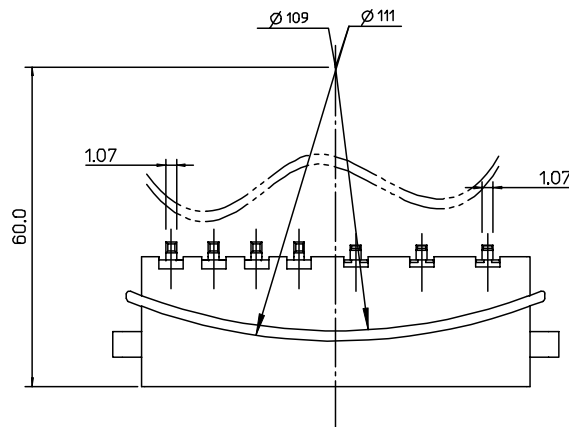
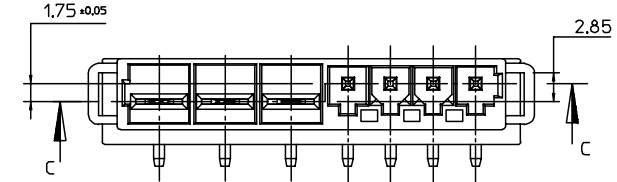
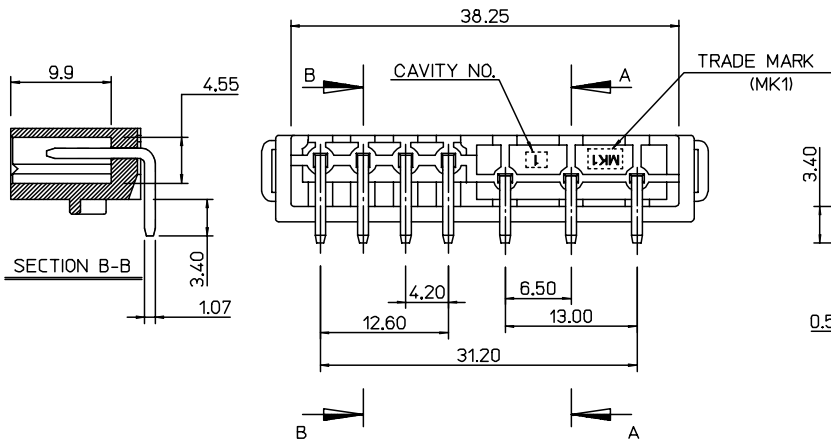

SECTION C-C

NEW RELEASE ECN NO. KOR2005-0057 DRWN: JB.JIN 04/09/15 CHK: W.Y.YANG APPR: CW.LEE	DESCRIPTION REV	QUALITY SYMBOLS	GENERAL TOLERANCES: (UNLESS SPECIFIED)		SCALE 1 : 1	DESIGN UNITS <input checked="" type="checkbox"/> mm <input type="checkbox"/> INCH	DIMENSIONS: <input type="checkbox"/> mm <input type="checkbox"/> INCH <input checked="" type="checkbox"/> mm ONLY		SHT	REV
		MAJOR ▲ = 0	mm	INCH	DRAWN BY & DATE C.B.CHIN 04/06/10	THIRD ANGLE PROJECTION		TITLE: HYBRID W/B CONN. HEADER ASS'Y-7P		
		CRITICAL ▽ = 0	4 PLACES ±0.	±-	CHECKED BY & DATE W.Y.YANG 04/06/10	MOLEX INCORPORATED			SHEET NO. 1 OF 1	
			3 PLACES ±0.	±-	APPROVED BY & DATE C.W.LEE 04/06/10	CAD FILENAME S490680710.MI	MATERIAL NO. 490680710	DRAWING NO. SD-49068-001	SIZE B	
		2 PLACES ±0.25	±-	DRAFT WHERE APPLICABLE MUST REMAIN WITHIN DIMENSIONS		THIS DRAWING CONTAINS INFORMATION THAT IS PROPRIETARY TO MOLEX INCORPORATED AND SHOULD NOT BE USED WITHOUT WRITTEN PERMISSION.				
		1 PLACE ±0.30	±-			KOREA		MX-A3		

8 7 6 5 4 3 2 1 KOREA MX-A3