

# Customer Information Sheet

DRAWING No.: M22-204XXXX

SHEET 2 OF 2

IF IN DOUBT - ASK

(C)

NOT TO SCALE

THIRD ANGLE PROJECTION

ALL DIMENSIONS IN mm

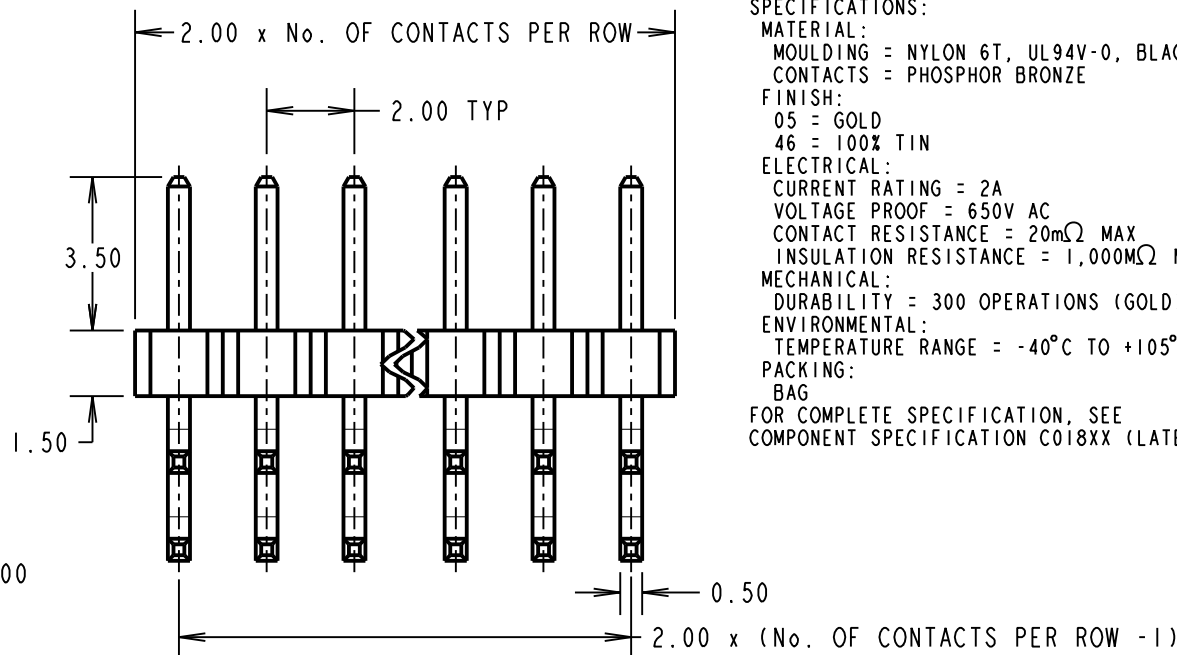
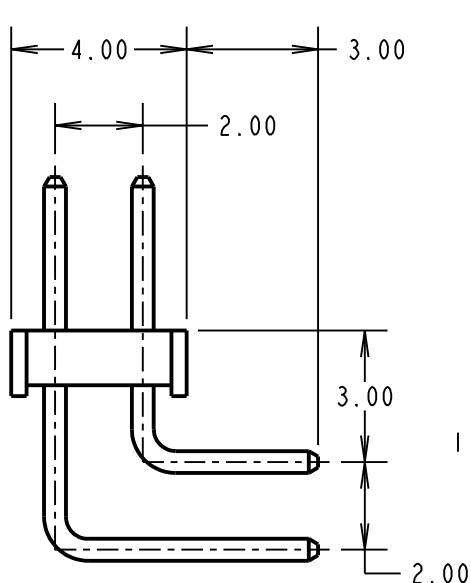

## SPECIFICATIONS:

### MATERIAL:

MOULDING = NYLON 6T, UL94V-0, BLACK

CONTACTS = PHOSPHOR BRONZE

### FINISH:

05 = GOLD

46 = 100% TIN

### ELECTRICAL:

CURRENT RATING = 2A

VOLTAGE PROOF = 650V AC

CONTACT RESISTANCE = 20mΩ MAX

INSULATION RESISTANCE = 1,000MΩ MIN

### MECHANICAL:

DURABILITY = 300 OPERATIONS (GOLD), 50 OPERATIONS (TIN)

### ENVIRONMENTAL:

TEMPERATURE RANGE = -40°C TO +105°C

### PACKING:

BAG

FOR COMPLETE SPECIFICATION, SEE  
COMPONENT SPECIFICATION C018XX (LATEST ISSUE)

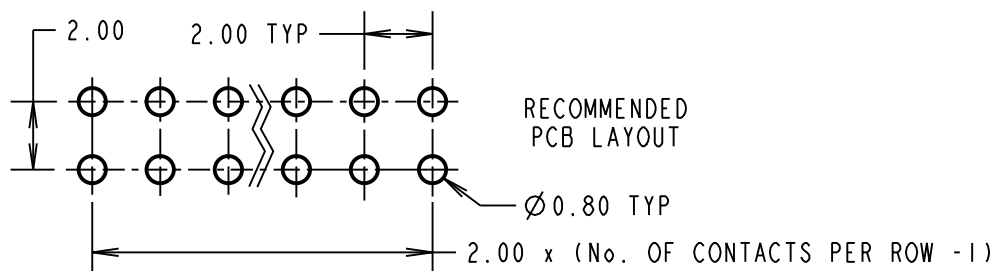

RECOMMENDED  
PCB LAYOUT

Ø0.80 TYP

2.00 x (No. OF CONTACTS PER ROW - 1)

## NOTES:

1. ALL TOLERANCES ARE  $\pm 0.20$  UNLESS OTHERWISE STATED.

## ORDER CODE:

**M22-204XXXX**

No. OF WAYS PER ROW

02 TO 25, 50

## FINISH

05 = GOLD OVER NICKEL

46 = 100% TIN OVER NICKEL

LS	9	01.11.17	20898
NAME	ISS.	DATE	C/NOTE
APPROVED: LS			
CHECKED: MGP			
DRAWN: P. D. COLLINS			
CUSTOMER REF.:			
ASSEMBLY DRG:			

# HARWIN

www.harwin.com  
technical@harwin.com

THIS DRAWING AND ANY  
INFORMATION OR DESCRIPTIVE  
MATTER SET OUT HEREON ARE  
CONFIDENTIAL AND COPYRIGHT  
PROPERTY OF THE HARWIN  
GROUP AND MUST NOT BE  
DISCLOSED, LOANED, COPIED  
OR USED FOR MANUFACTURING,  
TENDERING OR FOR ANY  
OTHER PURPOSE WITHOUT  
THEIR WRITTEN PERMISSION.

TOLERANCES  
~~X. =  $\pm 1$ mm~~  
~~X.X =  $\pm 0.50$ mm~~  
~~X.XX =  $\pm 0.10$ mm~~  
~~X.XXX =  $\pm 0.01$ mm~~  
ANGLES =  $\pm 5$   
UNLESS STATED

## MATERIAL:

SEE ABOVE

## FINISH:

SEE ABOVE

## S/AREA:

mm<sup>2</sup>

## TITLE:

2.00mm PITCH DIL  
HORIZONTAL PC TAIL PIN HDR

## DRAWING NUMBER:

**M22-204XXXX**

SHT  
2  
OF  
2