

DWG. NO. 210-910-0630G			
REV	DESCRIPTION	BY DATE	APPD
D	ECR 7206	JSM 2/9/02	JSM

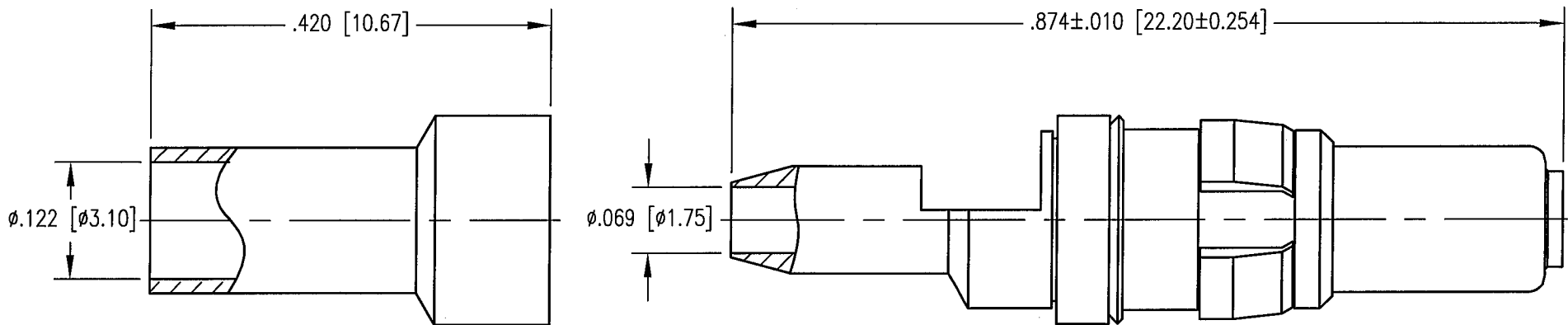

NOTES:

1. MATERIALS:

BODY AND FERRULE: BRASS PER ASTM B16
 CONTACT: COPPER ALLOY
 CLIP RING: BERYLLIUM COPPER PER ASTM B194
 SPRING WASHER: PHOSPHOR BRONZE PER ASTM B103
 INSULATOR: TEFLON PER ASTM D1710

2. FINISH:

BODY AND CONTACT: .000030 MIN. GOLD PER MIL-G-45204 OVER
 .000050 MIN. NICKEL PER QQ-N-290
 CLIP RING: .000100 MIN. NICKEL PER QQ-N-290 OVER
 COPPER FLASH
 ALL OTHER METAL PARTS: .000005 MIN. GOLD PER MIL-G-45204 OVER
 .000050 MIN. NICKEL PER QQ-N-290

3. FOR USE WITH RG-316 CABLE OR EQUIVALENT.

4. FOR ASSEMBLY USE CAP 9-01 WITH TRIMMING DIMENSIONS SHOWN.

5. CRIMP FERRULE USING .128 HEX. DIE.

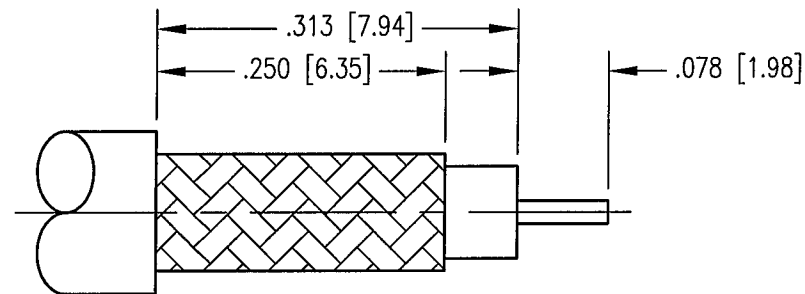

CABLE TRIMMING DIMENSIONS

PER ASME Y14.5M-1994 UNLESS OTHERWISE SPECIFIED: DIMENSIONS ARE IN INCHES (MM)				NORTHROP GRUMMAN			
TOLERANCES: DECIMALS .XX ± .01 [0.254] .XXX ± .005 [0.127] ANGLES ± 2'				Winchester Electronics 400 Park Road Watertown, CT 06795			
SCALE: 6:1				TITLE			
CUSTOMER DRAWING				RDM 50 OHM STRAIGHT PLUG			
DRAWN	DATE	CHECKED	DATE	A		210-910-0630G	
KJT	3/24/99	JED	3/24/99	SHT.	OF	REV.	
APPROVED	DATE	APPROVED	DATE	1	1	D	
JMC	3/24/99	JMC	3/24/99				