

SPECIFICATIONS

Rated(额定参数): 300V,1.5A
 Dielectric strength(抗电强度): AC2000V/1 Minute
 Insulation Resistance(绝缘电阻):1000MΩ Min
 Contact Resistance(接触电阻):20mΩ Max
 Screw Torque(扭矩): 0.4Nm (3.5Lb.in)
 Wire Range(线径):26~14AWG
 Strip length(剥线长度):6~7mm
 Temp. range(操作温度): -40℃~+105℃
 MAX Soldering(瞬时温度):+250℃,5s

Housing Material(塑件): PA66 (UL94 V-0)
 Contact(端子): Brass, Tin plating(黄铜镀锡)
 Clamp(方块): Brass/Steel(铜/铁), Ni plating(镀镍)
 Screw (螺丝): M2.5, Steel, Zinc plating(钢,镀锌)

PITCH RANGE IN MM	NOMINAL DIMENSION RANGE IN MM				
	OVER TO	OVER TO	OVER TO	OVER TO	OVER TO
6 TO 10	10 TO 24	30 TO 60	60 TO 100	100 TO 150	150 TO 150
±0.10	±0.15 ±0.25 ±0.30	±0.30 ±0.30 ±0.50	±0.50 ±0.70 ±1.00		

Ordering Information

JL 500 - XXX XX G X 1

Pitch
500=5.0PH
508=5.08PH

No.of pins
2P,3P,4P~24P

Housing Color
B=Black
G=Green
U=Blue
R=Red
W=White
O=Orange
E=Grey

Packing
0=Pe bog
A=Troy
T=Tube

Recommended P.C.B Layout(Top Side)

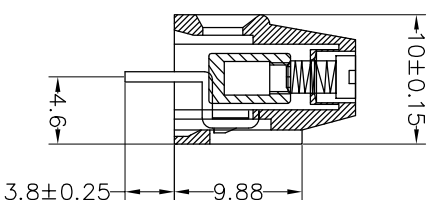
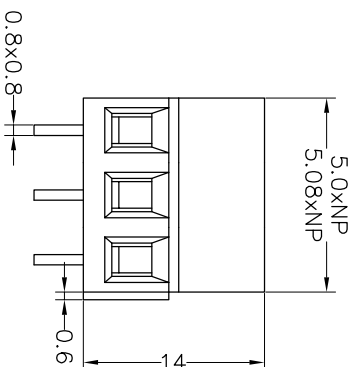
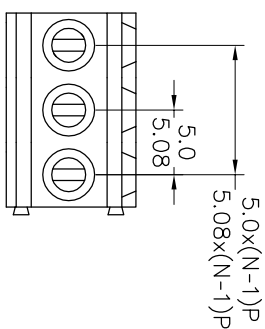
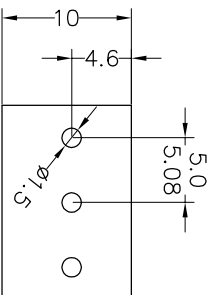

REV	DATE	MODIFICATION DESCRIPTION	CHANGE	OPERATION		DRAW	BEN	17.01.04	SCALE	FIT	PART NO.	TITLE:
				UNIT	SIZE				SHEET	PROJ.		
A0	2017.01.04	NEW DRAWING		X.X	±0.30	CHECK		mm	A4	1/1	JL500-XXXXXXGX1	5.0/5.08mm Terminal Blocks Female
1				Angle	±3°	APPROVE						

深圳市锦凌电子有限公司
 SHENZHEN JINLING ELECTRONIC CO.,LTD
 Tel: 86-755-2997-5806/5802 Fax: 86-755-2997-5992