

UNAUTHORIZED USE OF THIS  
DRAWING IS STRICTLY PROHIBITED

DAR	REV	DESCRIPTION	APPVD	DATE
1323	A	INITIAL RELEASE	TJD	8-07
1497	B	CHANGE LD HEIGHT & HEIGHT DIMS	DG	11-08
3519	C	SEE DAR	DG	2-12
5104	D	SEE DAR	DG	8-14

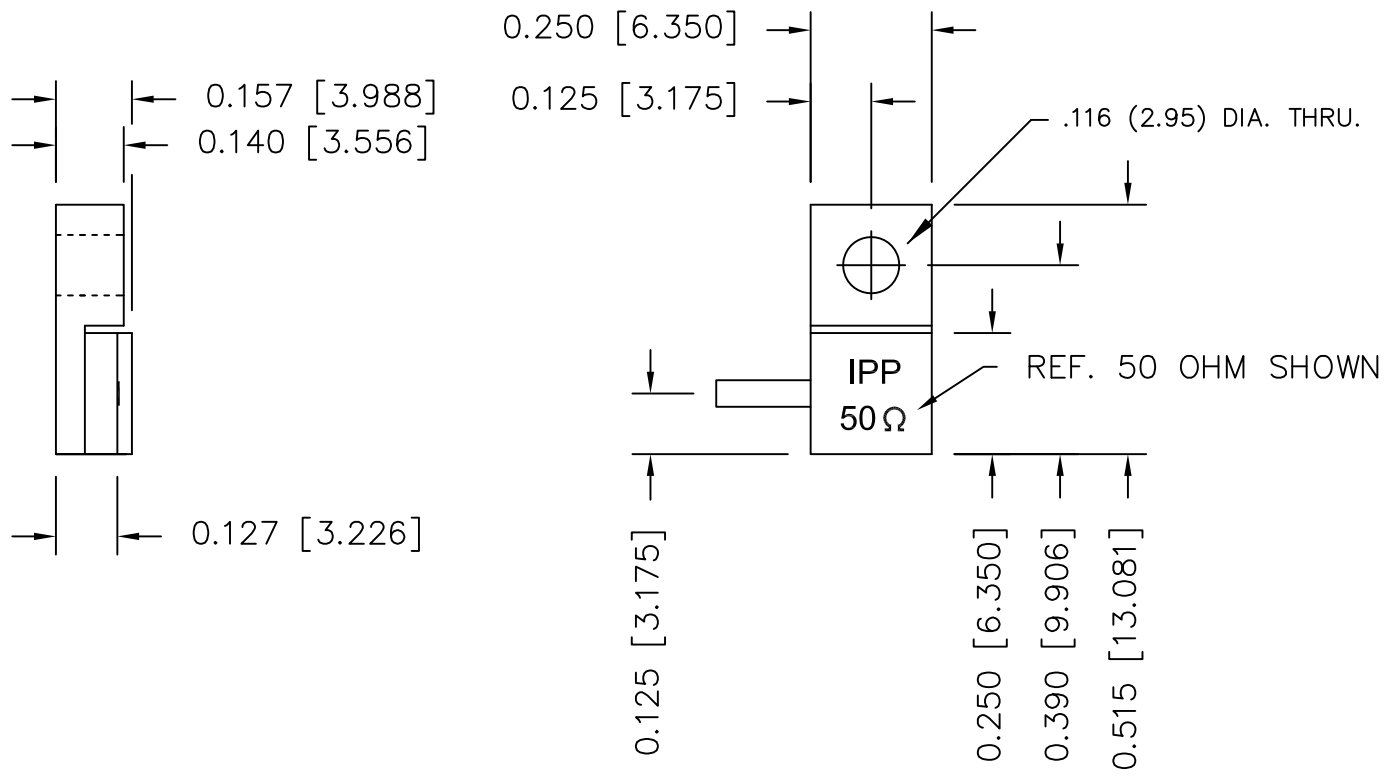

**NOTES**

- LEAD MATERIAL:  
99.99% PURE SILVER,  
.040 WIDE x .005 THICK
- LEAD LENGTH: .150 MIN.
- SUBSTRATE MATERIAL: BeO  
COVER MATERIAL: Al<sub>2</sub>O<sub>3</sub>
- FLANGE MATERIAL: COPPER  
PLATING: NICKEL
- RoHS COMPLIANT.

**ELECTRICAL SPECIFICATIONS**

INPUT POWER: 100 WATT  
 FREQ: DC - 5.0 GHZ.  
 VSWR: 1.10:1 DC - 4.2 GHZ.  
 1.25:1 DC - 5 GHZ.

**POWER DERATING CURVE**

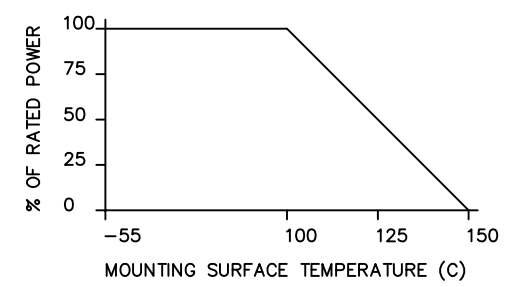

PART NO.	VALUE	TOLERANCE
IPP-TB221-50	50 OHMS	+/- 5%

MATERIAL	[3] [4]	DWN DG	DATE 8-07	<b>Innovative Power Products</b>
FINISH	[4]	ENG TJD	DATE 8-07	
TOLERANCE	.XX ±.02 [.50] IN [MM] .XXX ±.010 [.254]	MANUF TP	DATE 8-07	TITLE
		CAGE CODE: 437R2		TERMINATION, 100 WATT, FLANGE
		SHEET OF 1 1	SCALE 4:1	P/N
				IPP-TB221-XXX
				REV. D