

# TACT SWITCH DTS(M)(J)-6 SERIES

## 6x6 Surface Mounting Type (Ground Terminal Optional)

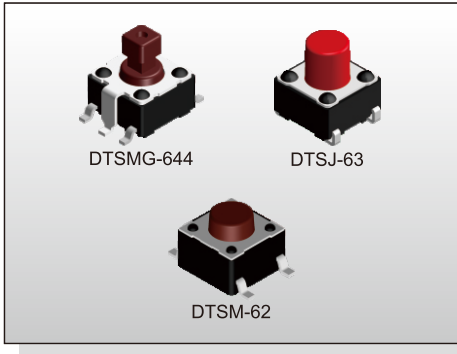

### FEATURES

- ※6x6mm, surface mounting type
- ※Optional ground pin
- ※Reflow solderable

### APPLICATION

- ※Audio, OA equipment
- ※Instrumentation, Communication
- ※White goods

### SPECIFICATION

|                       |   |
|-----------------------|---|
| Contact Rating        | 50mA, 12V DC  |
| Contact Resistance    | 100mΩ max.  |
| Insulation Resistance | 100MΩ min. 500V DC  |
| Dielectric Strength   | 250V AC/1 minute  |
| Operating Force       | 100±50gf, Black(K)<br>160±50gf, Brown(N)<br>260±50gf, Red(R)<br>320±80gf, Salmon(S)<br>520±130gf, Yellow(Y)   |
| Travel                | 0.25mm  |
| Operating Life        | Phosphor Bronze Dome<br>50,000 cycles for 520/320gf<br>100,000 cycles for 260gf<br>200,000 cycles for 160/100gf<br>Stainless Steel Dome<br>300,000 cycles for 520/320gf<br>500,000 cycles for 260gf<br>1,000,000 cycles for 160/100gf |
| Operating Temp.       | -25°C ~ +70°C   |
| Storage Temp.         | -30°C ~ +80°C   |

### HOW TO ORDER

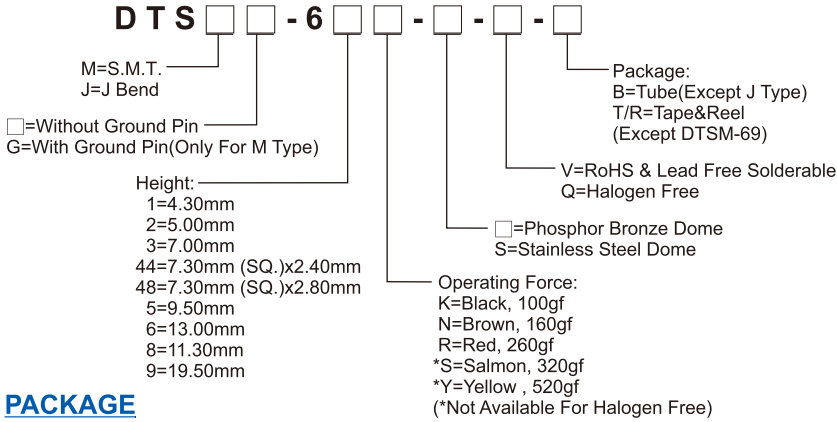

### PACKAGE

<Tube>

77 pcs

<Tape & Reel>

DTSM(G)(J)-61 / DTSMG-62:1000 pcs

DTS(M)(J)-62:900 pcs      DTS(M)(G)(T)-63, 64:700 pcs

DTSM(G)-65:380 pcs      DTSJ-65:400 pcs

### CIRCUIT

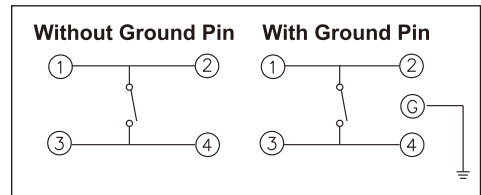

### DTSM-6

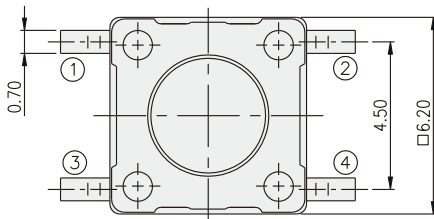

| PART NO. | H     |
|----------|-------|
| DTSM-61  | 4.30  |
| DTSM-62  | 5.00  |
| DTSM-63  | 7.00  |
| DTSM-65  | 9.50  |
| DTSM-66  | 13.00 |
| DTSM-68  | 11.30 |
| DTSM-69  | 19.50 |

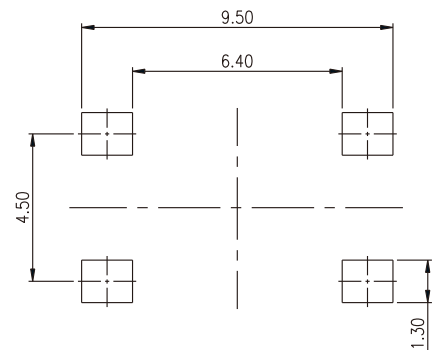
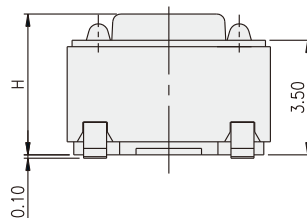
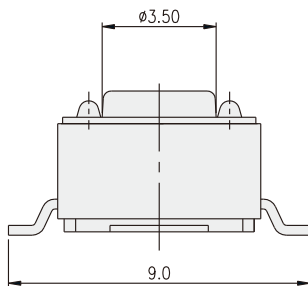

P.C.B. LAYOUT

**DTSM-644(8)**

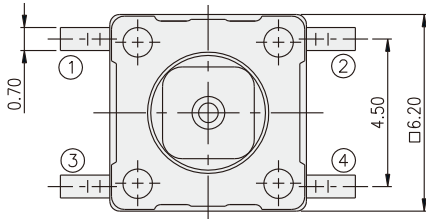

| PART NO. | □A   | □B   |
|----------|------|------|
| DTSM-644 | 2.40 | 1.60 |
| DTSM-648 | 2.80 | 2.00 |

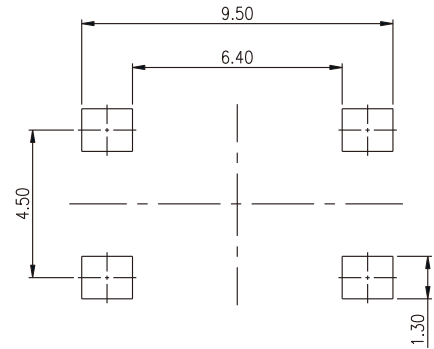
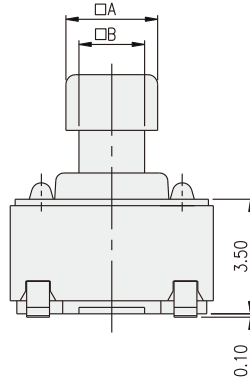
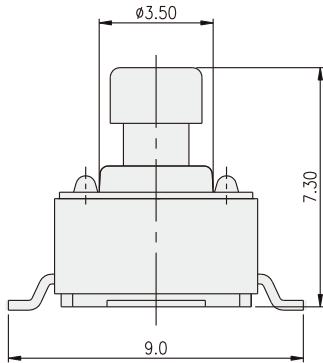

P.C.B. LAYOUT

TACT SWITCH

**DTSMG-6**

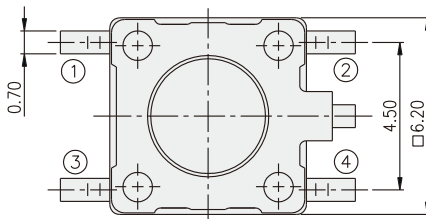

| PART NO. | H     |
|----------|-------|
| DTSMG-61 | 4.30  |
| DTSMG-62 | 5.00  |
| DTSMG-63 | 7.00  |
| DTSMG-65 | 9.50  |
| DTSMG-66 | 13.00 |
| DTSMG-68 | 11.30 |
| DTSMG-69 | 19.50 |

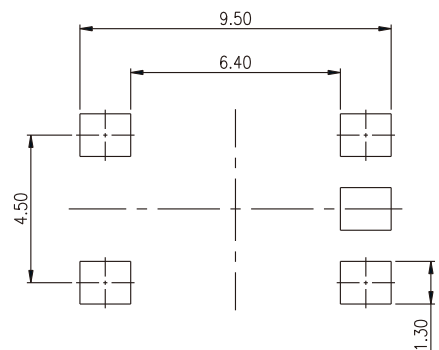
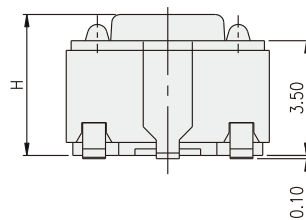
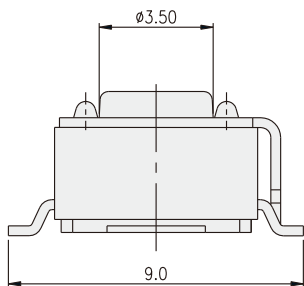

P.C.B. LAYOUT

TACT SWITCH  
**DTS(M)(J)-6 SERIES**

6x6 Surface Mounting Type  
 (Ground Terminal Optional)



DTSJ-6

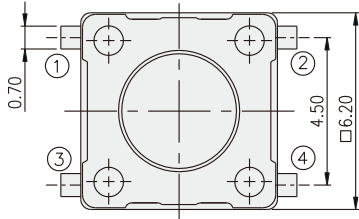

| PART NO. | H     |
|----------|-------|
| DTSJ-61  | 4.30  |
| DTSJ-62  | 5.00  |
| DTSJ-63  | 7.00  |
| DTSJ-65  | 9.50  |
| DTSJ-66  | 13.00 |
| DTSJ-68  | 11.30 |
| DTSJ-69  | 19.50 |

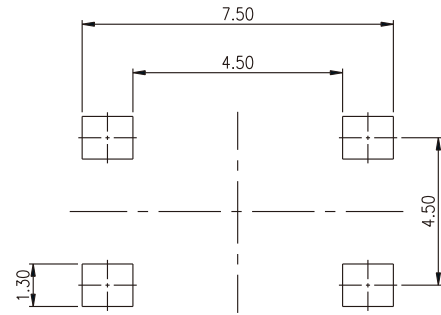
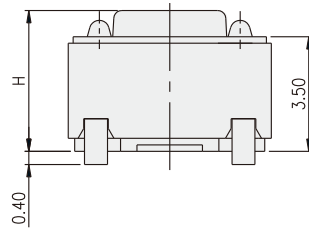
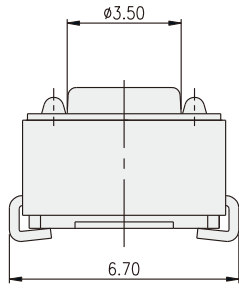

P.C.B. LAYOUT

TACT SWITCH