

1

2

3

4

5

6

7

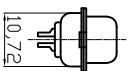
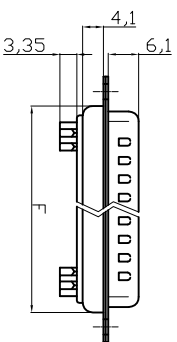
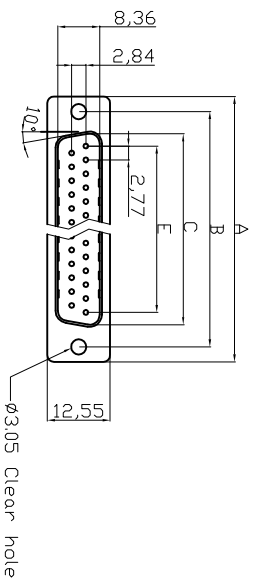
**Male****Product Specification****Material**

Insulator : Glass-Filled Thermoplastic PBT, UL94V-0,White  
 Contact : Copper alloy, Gold flash selective gold  
 Shell: SPCC  
 Clinch Nut : Brass, Nickel Plated  
 Screwlock : Brass, Nickel Plated

**Electrical**

Contact Resistance : 20 milliohms Max at 1 AMP DC.  
 Insulation Resistance : 1000 megohms at 500 VDC  
 Dielectric Withstanding Voltage : 1000 VAC/rms 60Hz for 1 minute  
 Current Rating : 3 AMP  
 Voltage Rating : 250 VAC/rms 60Hz  
 Ⓢ OPERATING TEMPERATURE:-55°C+105°C  
 Order Code:

A-Dx xx LLZ

Contact style: LLZ - Selective gold\*  
 F - Female  
 S - Male  
 No. of Contacts  
 09 / 15 / 29 / 37  
 \* Quality class III

**Dimensions**

Positions	A	B	C	E	F
9	30.81	24.99	16.92	11.08	19.20
15	39.20	33.30	25.25	19.39	27.70
25	53.04	47.04	38.96	33.24	41.10
37	69.40	63.50	55.42	49.86	57.30

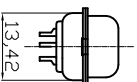
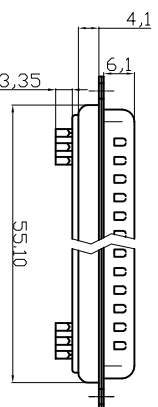
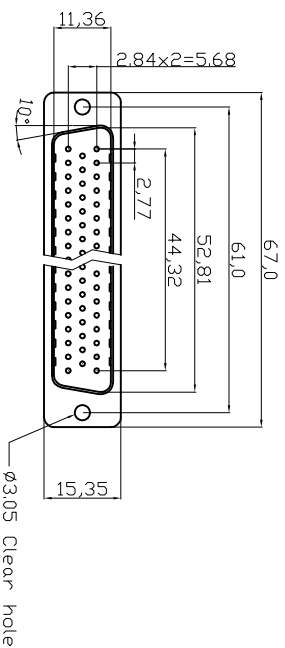
**50 Positions**

Scale	Free				
<b>TOLERANCE</b>					
X.	±0.38				
X.X	±0.25				
X.XX	±0.13				
<b>DIM</b>					
X.	±3°	Ⓢ	Update operation temperature range	13.05.2014	Winnie
X.X°	±1.0°	Ⓢ	Drawn	15.08.2012	Lucas
Angle	TOL	Id.	Modification	Date	Name

**ROHS compliant**

Unit: mm

1

2

3

4

5

6

7

Customer-No.

ASSMANN WSW-No.

A-Dx xx LLZ

Drawing-No.

ASS 4884 CO

rev01

Replace

Sheet  
1/2

  
 WSW components

H

G

F

E

D

C

B

A

1

2

3

4

5

6

7

**Female**

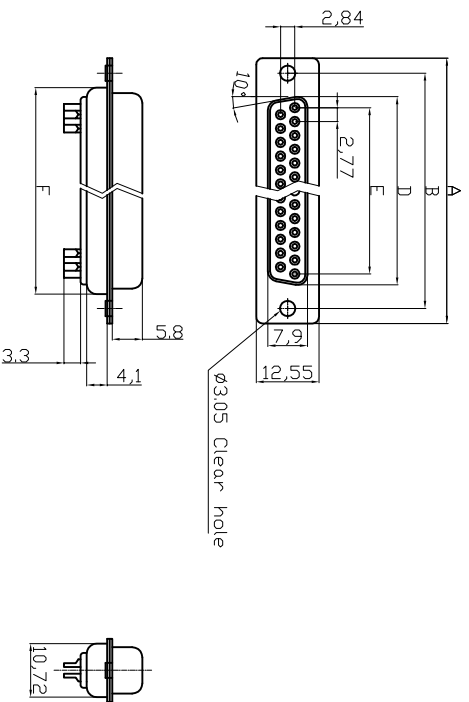

**Product Specification**  
**Material**  
 Insulator : Glass-Filled Thermoplastic PBT, UL94V-0, White  
 Contact : Brass or Phosphor Bronze, Gold flash selective gold plating  
 Shell : Steel, refer to ordering information for plating  
 Clinch Nut : Brass, Nickel Plated  
 Boardlock : Brass, Nickel Plated  
 Screwlock : Brass, Nickel Plated

**Electrical**  
 Contact Resistance : 20 milliohms Max at 1 AMP DC,  
 Insulation Resistance : 1000 megohms at 500 VDC  
 Dielectric Withstanding Voltage : 1000 VAC/rms 60Hz for 1 minute  
 Current Rating : 3 AMP  
 Voltage Rating : 250 VAC/rms 60Hz  
 Operating Temperature : -55°C+105°C

**Dimensions**

Positions	A	B	D	E	F
9	30.81	24.99	16.33	11.08	19.20
15	39.20	33.30	24.70	19.39	27.70
25	53.05	47.04	38.40	33.24	41.10
37	69.40	63.50	54.84	49.86	57.30

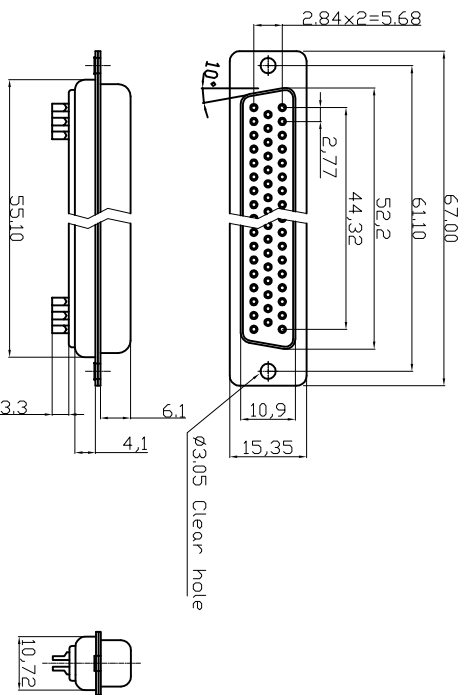

**50 Positions**

**ROHS compliant**  
Unit:mm

Scale	Free				
<b>TOLERANCE</b>					
X.	±0.38				
X.X	±0.25				
X.XX	±0.13				
<b>DIM</b>					
X.°	±3°	①	Update operation temperature range	13.05.2014	Winnie
X.X°	±1.0°	②	Drawn	15.08.2012	Lucas
Angle	TOL	Id.	Modification	Date	Name



Customer-No. \_\_\_\_\_  
 ASSMANN WSW-No. \_\_\_\_\_  
**A-Dx xx LL/Z**  
 Drawing-No. \_\_\_\_\_  
**ASS 4884 CO**  
 Replace \_\_\_\_\_  
 rev01  
 Sheet 2/2

1

2

3

4

5

6

7

H

G

F

E

D

C

B

A