

Recommended P.C.B Layout(Top Side)

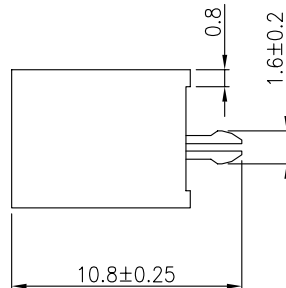

SPECIFICATIONS

1.MATERIAL:

Housig: LCP UL 94V-0
 Color: Black
 Contact: Phosphor bronze
 Hook: Phosphor bronze

2.FINISH:

Contact:3u" Gold/Tin platig on contact area
 100u" min.Tin-Lead Plating on soldertails
 50u" min.Nickel underplating over all
 Hook: 100u"min.Tin-Lead plating on soldertails
 50u"min.Nickel underplating over all



深圳市华宇创精密电子有限公司

TOLERANCE: X.X ±0.30 X.XX ±0.25 X.XXX ±0.15 X.' ±2' X.X' ±0.5'	DRAWN BY : 陈一鸣	DATE : 2014-02-23	PART NAME: SATA 7PIN 全包不开窗 A型
	CHECKED BY: 马跃	DATE : 2014-02-23	PART NO. HYCW04-SATA07-129B
UNIT: mm [inch] SCALE:1:1 SIZE: A4	APPROVED BY: 邱敏	DATE : 2014-02-23	MOLD NO.
			DRAW NO: HYC-SATA15110410
			SHEET NO. 1 OF 1