

Series

DC1050R DC1050

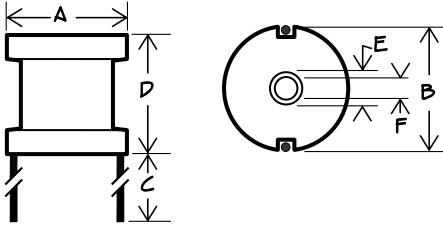

High Current Power Line Chokes

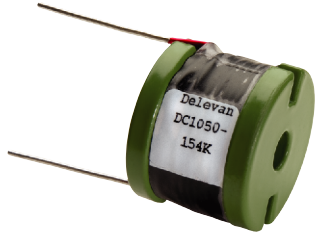

Physical Parameters

	Inches	Millimeters
A	1.050 ± 0.050	26.670 ± 1.270
B	See Characteristics Table	
C	0.750 Min.	19.050 Min.
D	0.840 Max.	21.336 Max.
E (Ref. only)	0.240 Max.	6.096 Max.
F	Clearance Hole for 4/40 Screw	
G	See Characteristics Table	

Leads Tinned to within 1/16" of Body

Inductance Measured @ 1 kHz within 0 A DC on a GenRad 1658A Digibridge, or equivalent

Mechanical Configuration Center hole allows for mechanical mounting; insulated bobbins

Operating Temperature

-55°C to +125°C;
-55°C to +80°C @ full rated current

Current Rating at 80°C Ambient 45°C Rise

Incremental Current Minimum current which causes a 5% maximum decrease in Inductance

Power Dissipation at 80°C 2.20 Watts Max.

Dielectric Withstanding Voltage 1000 V RMS Min.

Marking Parts printed with DELEVAN and API Part Number and Date Code

Packaging Bulk only

Made in the U.S.A.

DASH NUMBER*

NOMINAL INDUCTANCE (μH)

TOLERANCE

DC RESISTANCE MAX. (OHMS) @ 25°C

CURRENT RATING MAXIMUM (A DC)

INCREMENTAL CURRENT (A DC)

DIMENSION B (Inches, Reference)

LEAD DIAMETER (Inches, Reference)

SERIES DC1050 FERRITE CORE							
-104K	100	±10%	0.034	7.5	9.0	0.81	0.046
-124K	120	±10%	0.046	6.5	8.0	0.77	0.040
-154K	150	±10%	0.064	5.5	7.0	0.77	0.040
-184K	180	±10%	0.072	5.1	6.5	0.77	0.040
-224K	220	±10%	0.080	4.8	6.0	0.77	0.040
-274K	270	±10%	0.110	4.2	5.0	0.77	0.036
-334K	330	±10%	0.122	4.0	4.5	0.77	0.036
-394K	390	±10%	0.169	3.4	4.0	0.77	0.032
-474K	470	±10%	0.187	3.2	3.8	0.77	0.032
-564K	560	±10%	0.205	3.0	3.5	0.77	0.032
-684K	680	±10%	0.256	2.7	3.0	0.77	0.029
-824K	820	±10%	0.288	2.5	2.8	0.77	0.029
-105K	1000	±10%	0.426	2.1	2.5	0.77	0.029
-125K	1200	±10%	0.462	2.0	2.2	0.77	0.026
-155K	1500	±10%	0.518	1.9	2.0	0.77	0.026
-185K	1800	±10%	0.705	1.6	1.8	0.77	0.026
-225K	2200	±10%	1.020	1.4	1.5	0.77	0.023
-275K	2700	±10%	1.140	1.3	1.4	0.77	0.023
-335K	3300	±10%	1.270	1.2	1.3	0.77	0.023
-395K	3900	±10%	1.670	1.1	1.2	0.77	0.020
-475K	4700	±10%	1.860	1.0	1.0	0.77	0.020

*Complete part # must include series # PLUS the dash #

For further surface finish information, refer to TECHNICAL section of this catalog.