

## 410-2844 Component Clip, .040 (1,02) Slot, Thread mount, Capped Plunger

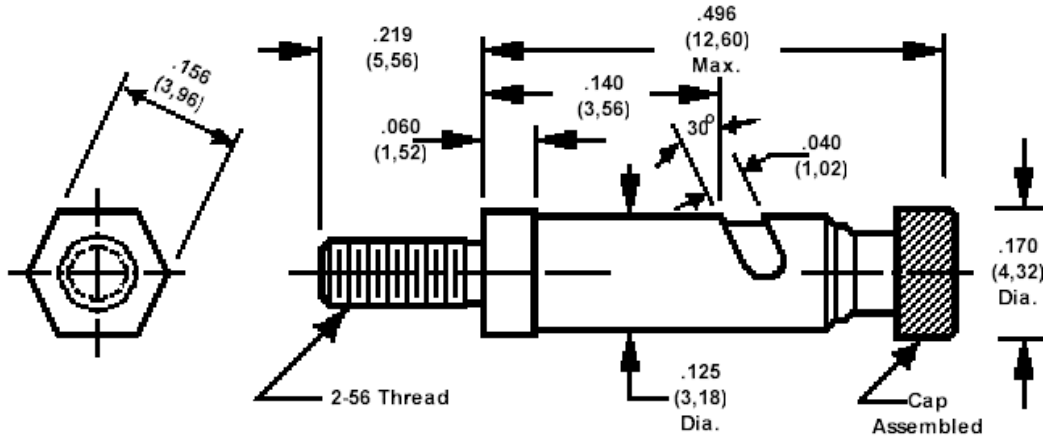

Recommended Lead Wire Sizes - #30 AWG (.010) (0,25) Min. Thru #22 AWG (.025) (0,64) Max.

**How to order code**  
**410-2844-01-02-19**  
**Basic Part No.**

Component	Material	Finish
Housing	Brass	Nickel
Plunger	Brass	Nickel
Spring	Cres. Steel	Passivated
Cap	Nylon	White