

Recommended P.C.B Layout

MATERIAL

Insulator : NYLON 46
Contact Pin : Brass

SPECIFICATION

Current Rate : 1 AMP
Dielectric voltage : 500V AC for one minute
Insulation Resistance : 500MΩMin.
Contact Resistance : 20mΩMax
Operation Temperature : -25°C to + 85°C

712-71-03 T W 0 1
1 2 3 4 5

1. 5: Normal parts
- 7: Green Product
- 9: Green Product High Temp
2. No. of contacts per row
3. G: Gold flash
- S: Selective
- T: Tin plated
4. S: Crystal insulator
- W: Nature Color Insulator
5. Pinrex internal code.

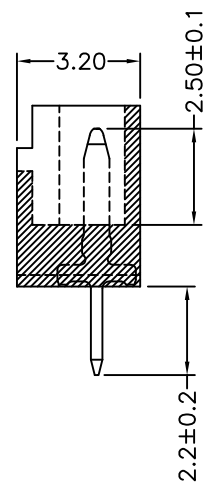

C	ADD ILLUSTRATION	2012/11/14	TOLERANCE		OLD PART NO.		TITLE		频锐科技股份有限公司 PINREX TECHNOLOGY CORP.		
B	REVISE ILLUSTRATION	2008/01/11	.0 =±.30		UNITS : mm	DRAWER	胡雨婷	CHECK		1.25mm HEADER DIP TYPE	
A	RELEASE	2005/01/27	.00 =±.20	SCALE	NONE	SHEET	1 OF 1	REV.	C	APP'D	
REV.	DESCRIPTION	DATE	.000 =±.XXX	SIZE	A4	NEW PART NO.	712-71-03TW01	DRAW NO.	712-71-03TW01 (C版)		
			.0000=±.								
			ANG.=±3'								