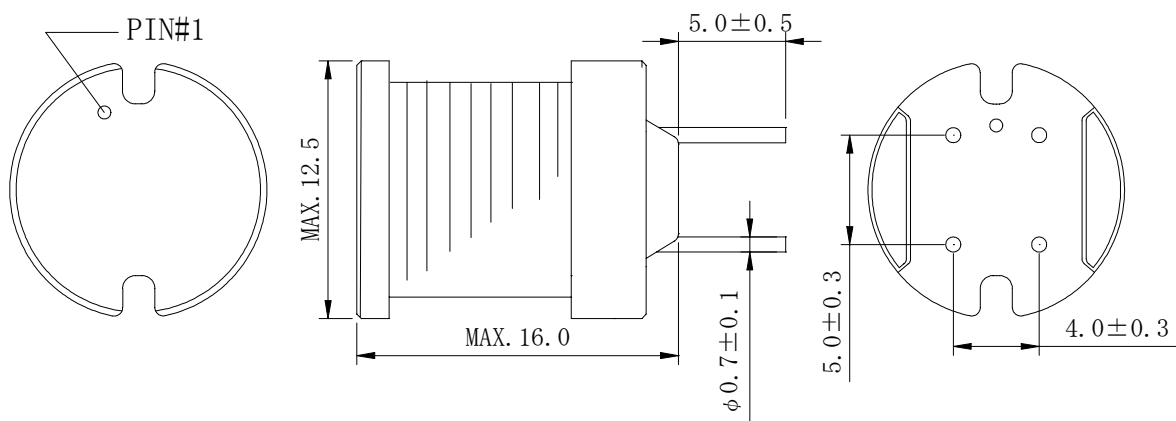
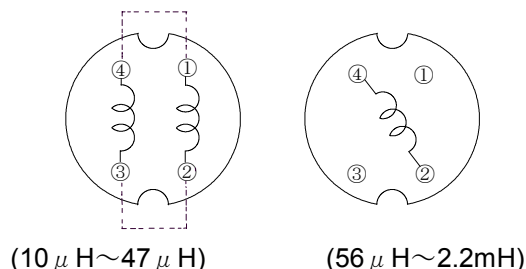

**Type: RCH1216B**
**◆ Product Description**

- 12.5mm Max.φ, 16.0mm Max. Height.
- Inductance range: 10 μH~2.2mH
- Rated current range:0.41~5.0A
- In addition to the standard versions of inductors shown here, custom inductors are available to meet your exact requirements.

**◆ Feature**

- Magnetically unshielded construction.
- Ideally used in Printers, LCD TV, DVD, Printer, Copy Machine, Mainboard of the compounding machines, etc as Power Supplies's Inductors or DC-DC Converter inductors.
- RoHS Compliance

**◆ Dimensions (mm)**

**◆ Schematics (Bottom)**

- ※ To be connected between #1 and #4, #2 and #3 (10 μH ~ 47 μH) when using.
- ※ It is no matter for the electric characteristics if terminal 1 is connected to terminal 4, terminal 2 is connected to terminal 3 with solder. (On the bottom of drum core) (10 μH ~ 47 μH).

**Type: RCH1216B**
**◆ Specification**

Part Name	Stamp	Inductance [Within] (at 1kHz)	D.C.R. ( $\Omega$ ) Max.(Typ.) (at 20°C)※1	Saturation Current (A) ※1		Temperature Rise Current (A) ※2
				at 20°C	at 100°C	
RCH1216BNP-10ØM	100M	10 $\mu$ H $\pm$ 20%	24m(19m)	9.00	8.00	5.00
RCH1216BNP-12ØM	120M	12 $\mu$ H $\pm$ 20%	26m(21m)	7.80	7.00	4.60
RCH1216BNP-15ØM	150M	15 $\mu$ H $\pm$ 20%	29m(23m)	7.20	6.20	4.40
RCH1216BNP-18ØM	180M	18 $\mu$ H $\pm$ 20%	33m(26m)	6.75	5.80	4.20
RCH1216BNP-22ØM	220M	22 $\mu$ H $\pm$ 20%	37m(29m)	6.00	5.30	4.00
RCH1216BNP-27ØM	270M	27 $\mu$ H $\pm$ 20%	41m(32m)	5.50	4.80	3.80
RCH1216BNP-33ØM	330M	33 $\mu$ H $\pm$ 20%	46m(36m)	5.00	4.50	3.60
RCH1216BNP-39ØM	390M	39 $\mu$ H $\pm$ 20%	49m(39m)	4.70	4.10	3.30
RCH1216BNP-47ØM	470M	47 $\mu$ H $\pm$ 20%	56m(44m)	4.30	3.80	3.20
RCH1216BNP-56ØK	560K	56 $\mu$ H $\pm$ 10%	87m(69m)	4.10	3.70	2.70
RCH1216BNP-68ØK	680K	68 $\mu$ H $\pm$ 10%	98m(78m)	3.80	3.30	2.40
RCH1216BNP-82ØK	820K	82 $\mu$ H $\pm$ 10%	107m(85m)	3.20	2.90	2.25
RCH1216BNP-1Ø1K	101K	100 $\mu$ H $\pm$ 10%	121m(96m)	3.00	2.70	2.15
RCH1216BNP-121K	121K	120 $\mu$ H $\pm$ 10%	134m(107m)	2.85	2.60	2.05
RCH1216BNP-151K	151K	150 $\mu$ H $\pm$ 10%	156m(124m)	2.55	2.35	1.90
RCH1216BNP-181K	181K	180 $\mu$ H $\pm$ 10%	206m(164m)	2.20	2.05	1.65
RCH1216BNP-221K	221K	220 $\mu$ H $\pm$ 10%	236m(188m)	2.00	1.85	1.55
RCH1216BNP-271K	271K	270 $\mu$ H $\pm$ 10%	0.32(0.25)	1.85	1.70	1.40
RCH1216BNP-331K	331K	330 $\mu$ H $\pm$ 10%	0.37(0.29)	1.65	1.53	1.30
RCH1216BNP-391K	391K	390 $\mu$ H $\pm$ 10%	0.48(0.38)	1.55	1.35	1.05
RCH1216BNP-471K	471K	470 $\mu$ H $\pm$ 10%	0.55(0.44)	1.45	1.25	1.00
RCH1216BNP-561K	561K	560 $\mu$ H $\pm$ 10%	0.62(0.49)	1.36	1.18	0.95
RCH1216BNP-681K	681K	680 $\mu$ H $\pm$ 10%	0.79(0.63)	1.20	1.06	0.82
RCH1216BNP-821K	821K	820 $\mu$ H $\pm$ 10%	0.88(0.70)	1.14	0.97	0.75
RCH1216BNP-1Ø2K	102K	1.0mH $\pm$ 10%	1.13(0.90)	1.00	0.80	0.65
RCH1216BNP-122K	122K	1.2mH $\pm$ 10%	1.25(1.00)	0.89	0.76	0.61
RCH1216BNP-152K	152K	1.5mH $\pm$ 10%	1.52(1.26)	0.85	0.70	0.54
RCH1216BNP-182K	182K	1.8mH $\pm$ 10%	1.93(1.60)	0.76	0.63	0.46
RCH1216BNP-222K	222K	2.2mH $\pm$ 10%	2.52(2.10)	0.65	0.57	0.41

※1. Saturation current: The DC current at which the inductance decreases to 90% of it's initial value.

※2: Temperature rise current: The DC current at which the temperature rise is  $\Delta t=40^{\circ}\text{C}$ . ( $T_a=20^{\circ}\text{C}$ ).