

# Bandpass Filter

KR Model 2163

*KR Model 2163 is a high performance elliptic bandpass filter. Other center frequencies are available.*

## Passband Amplitude

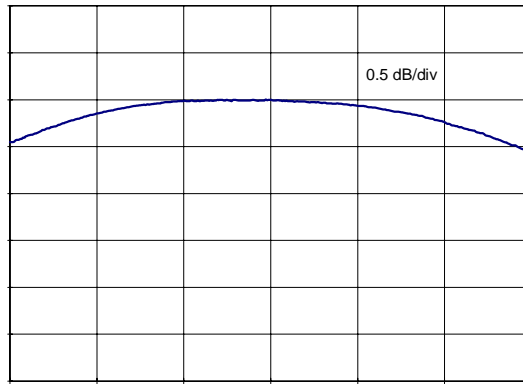

10.7 MHz

11.3 MHz

## Overall Amplitude

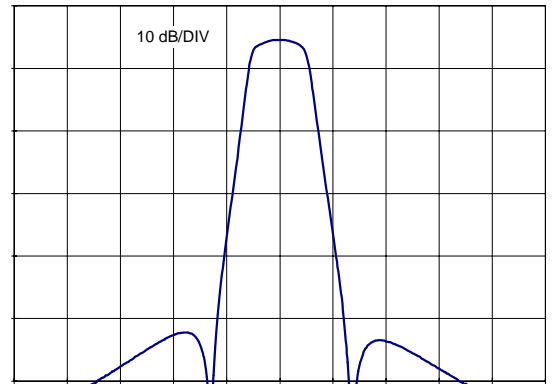

6 MHz

16 MHz

## Specifications

KR Part Number	2163
Filter Type	Bandpass
Insertion Loss	< 4 dB
Center Frequency	10.99 MHz
1 dB Passband Frequencies	10.69 MHz to 11.29 MHz
Lower 40 dB Frequency	9.79 MHz
Upper 40 dB Frequency	12.19 MHz
Source & Load Impedance	50 Ω

## Outline Drawing

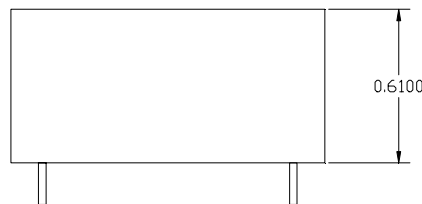
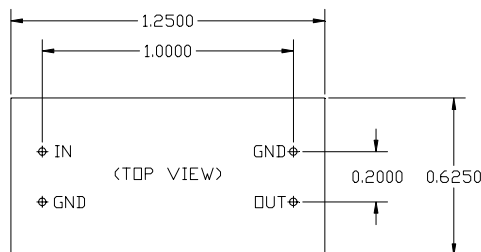

Terminals 0.03" diameter  
Metal Case (5 sides)

**KR Electronics**  
www.krfilters.com  
91 Avenel Street  
Avenel, NJ 07001  
732-636-1900