

REVISION RECORD				
REV	ECO	DESCRIPTION	DRFT	CHKD
△		Drawing Modify	SHY 2/20/02	
△		Add Part Number	SHY 6/04/02	
△		Design Modify	ZY 6/16/02	
△		Add Part Number	CDM 6/16/02	

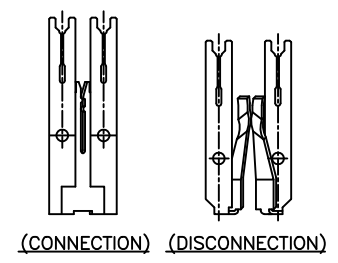
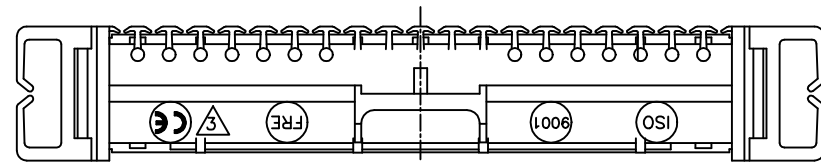
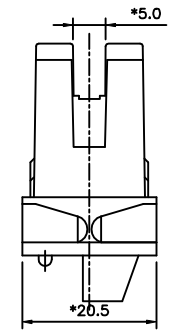
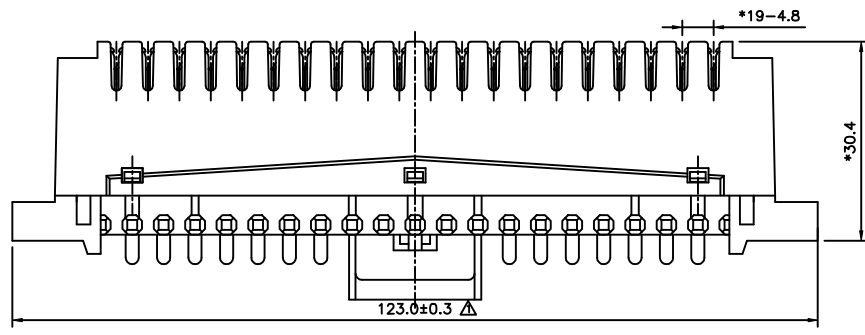
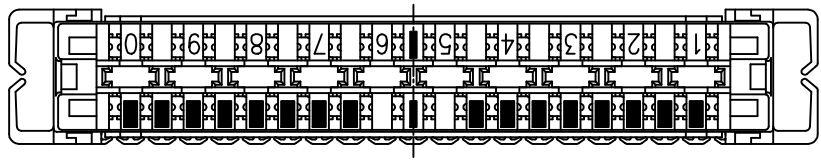

- NOTE:
- MATERIAL:
 - HOUSING- PBT UL94V-0
 - BASE- PBT UL94V-0
 - CONTACT- 0.5mm THICKNESS
PHOSPHOR BRONZE PLATING
OVER NICKEL OVER SILVER
 - CABLE: WIRE SIZES:
 - SOLID COPPER WIRES UP TO 0.4mm - 0.8mm IN DIA
 - INSULATION PE OR PVC INSULATED WIRE
 - PART NUMBER:
 - E4621-110338 (CONNECTION)
 - E4621-210338 (DISCONNECTION)
 - E4621-26063H (DISCONNECTION)
 - E4621-810T38 (KT s type Contact) △
 - E4621-21033J (DISCONNECTION PLATED NI 20u") △

DETACHED LISTS	← MM (INCH) →	DFTO SANDY	DATE 8/12/99	FULL RISE ELECTRONIC CO., LTD	
	TOLERANCES EXCEPT AS NOTED	CHKD ZY	DATE 2004/12/2		
	MM	MFO	DATE	TITLE 10 PAIRS TELECOM BLOCK	
	.0 ±0.20 ±	APPVL SHY	DATE 2004/12/2		
	.00 ±0.15 ±	MATERIAL :		DRAWING NO. GE463001	
.000 ±0.075 ±	ANGLES ±	QT'Y :	SIZE A3		
THIRD ANGLE PROJECTION	FINISH :	SCALE :	/PART NO. SEE NOTE		12/01/04
			DO NOT SCALE DRAWING		SHEET X OF Y