

16

1636 02

Power supply connectors



Power supply plug acc. to JEITA RC-5320A JSAP2, straight version, with solder eyes and bend protection

State: Active

16

1636 02

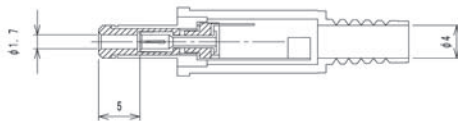
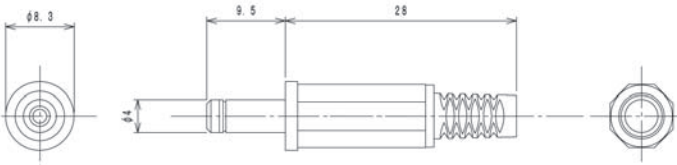

Environmental conditions

Temperature range -20 °C/+70 °C

Materials

Insulating body	PC
Contact	CuZn, nickel-plated
Insulation	POM
Housing	PP

Mechanical data

Outer diameter	4,0 mm
Inner diameter	1,7 mm

Connectable conductors for solder area

Cable diameter	4 mm
----------------	------

Electrical data (at T_{amb} 20 °C)

Rated current	2 A
Rated voltage	6,3 V DC
Rated impulse voltage	500 V/60 s
Insulation resistance	≥ 100 MΩ

Associated products

Counterparts
[↗ 1613 04](#) [↗ 1613 05](#) [↗ 1613 24](#)

16

1636 02

Designation	Pole Number	PU (Pieces)	MDQ (Pieces)
1636 02	2	100	500

Packaging:

in bulk, in a cardboard box or a plastic bag