

Kinghelm®

REV.	MODIFICATION	ECN No.	NAME	DATE
AO	新版发行		宋亮红	2021-02-24

NOTES:

1.MATERIAL:

MOLDING: LCP UL94 V-0
 CONTACT: COPPER ALLOY.
 GOLD PLATED Min ON CONTACT AREA, 100u"
 Min TIN (LEAD FREE) ON SOLDER AREA,
 SHELL: SUS201-H, T=0.25±0.03mm
 50u" NICKEL PLATING OVER ALL.

2.MECHANICAL:

INSERTION: 5~20N.
 EXTRACTION: 8~20N AFTER TEST.
 DURABILITY: 5000 CYCLES

3.ELECTRICAL:

CURRENT: 3A FOR VBUS;

VOLTAGE: 20 V MAX
 WITHSTANDING VOLTAGE: 100V AC R.M.S.
 CONTACT RESISTANCE: 40mΩ MAX.
 INSULATION RESISTANCE: 100MΩ MIN.

4.ENVIRONMENTAL

TEMPERATURE RANGE -25°C ~ +85°C

5.尺寸标注事项:

图示有标示"Ⓢ"为首样全检, 重点管控尺寸

6.产品符合RoHS标准.

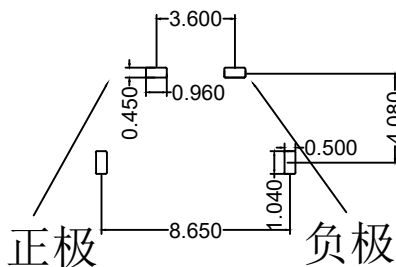
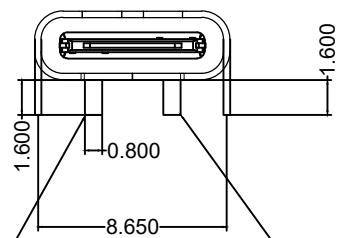
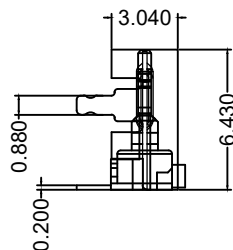
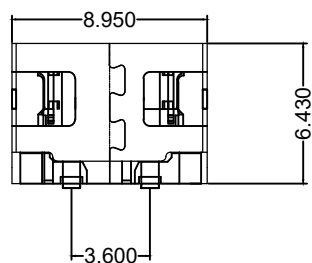

深圳市金航标电子有限公司

.X: ±0.35	.X*: ±1.5*	INTENDED USE:	TITLE:	
.XX: ±0.25	.XX*: ±1.0*	CONNECTOR	TYPE-C 2P 90度母座	
.XXX: ±0.20	.XXX*: ±0.5*	APPD.:	PART NO.:	SEE TABLE
MAT'L.:	SEE NOTES	CHRD.:	DWG. NO.:	T16-000X
FINISH:		DR.:	SCALE: 1:1	PAGE: 1/1
		Len.Song	UNIT: mm	REV.: AO