

DWG. NO.		201-910-1162J	
REV	DESCRIPTION	BY DATE	APPD
B	ECR 7266	2/18/02	<i>[Signature]</i>

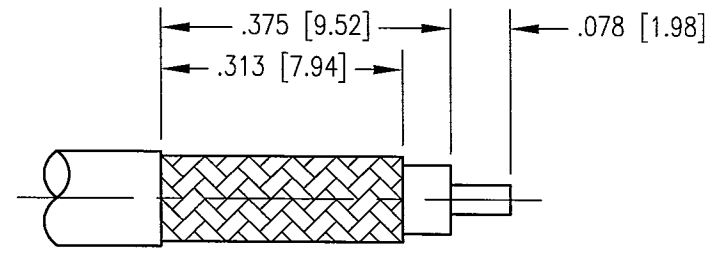
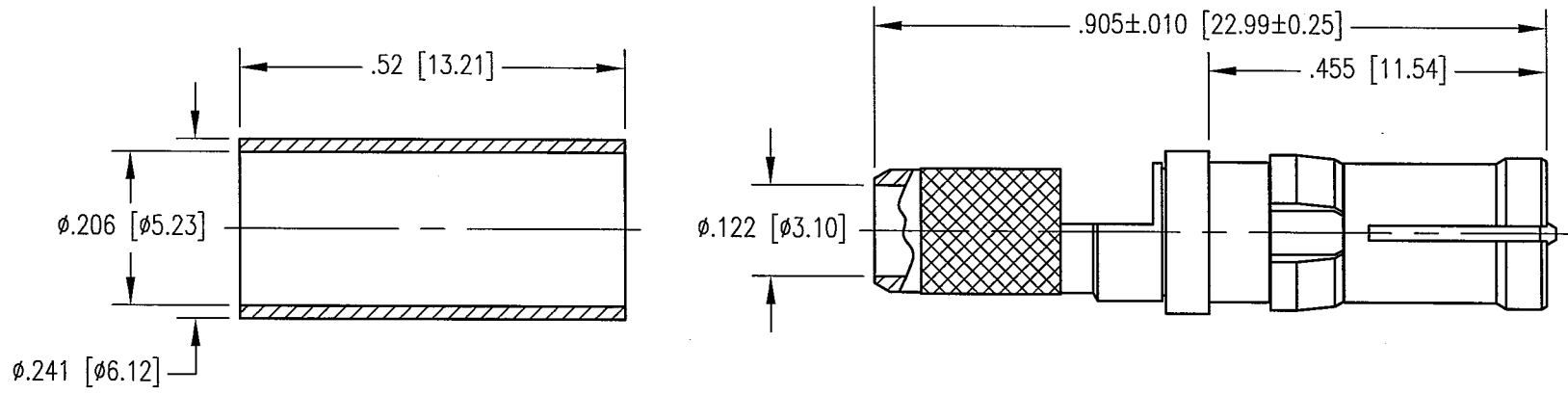

CABLE TRIMMING DIMENSIONS

NOTES:

1. MATERIALS:
 FRONT BODY: BERYLLIUM COPPER PER ASTM B196
 CLIP RING: BERYLLIUM COPPER PER ASTM B194
 FERRULE: COPPER ALLOY
 ALL OTHER METAL PARTS: BRASS PER ASTM B16
 INSULATOR: TEFLON PER ASTM D1710
2. FINISH:
 BODY AND CENTER CONTACT: .000015 MIN. GOLD PER MIL-G-45204 OVER
 .000100 MIN. COPPER PER MIL-C-14550
 FERRULE: .000100 MIN. BRIGHT TIN PER MIL-T-10727 OVER
 COPPER FLASH
 CLIP RING: UNPLATED
3. ELECTRICAL:
 IMPEDANCE: 50 OHMS NOMINAL
 FREQUENCY RANGE: 0 - 900 MHz
4. DESIGNED FOR USE WITH RG-58 CABLE OR EQUIVALENT.
5. FOR CABLING PROCEDURES USE CAP 9-01 WITH TRIMMING DIMENSIONS SHOWN.
6. CRIMP FERRULE USING .213 HEX DIE.

PER ASME Y14.5M-1994 UNLESS OTHERWISE SPECIFIED: DIMENSIONS ARE IN INCHES [MM]		NORTHROP GRUMMAN	
TOLERANCES: DECIMALS .xx ± .01 [0.254] .xxx ± .005 [0.127] ANGLES ± 2°		Winchester Electronics 400 Park Road Watertown, CT 06795	
CUSTOMER DRAWING		TITLE RDM STRAIGHT RECEPTACLE	
DRAWN MJF	DATE 2/18/02	CHECKED <i>[Signature]</i>	DATE 2/18/02
APPROVED <i>[Signature]</i>	DATE 2/18/02	APPROVED <i>[Signature]</i>	DATE 2/18/02
A		201-910-1162J	SHT. 1 OF 1 REV. B