

6mm HEX FEMALE STANDOFFS

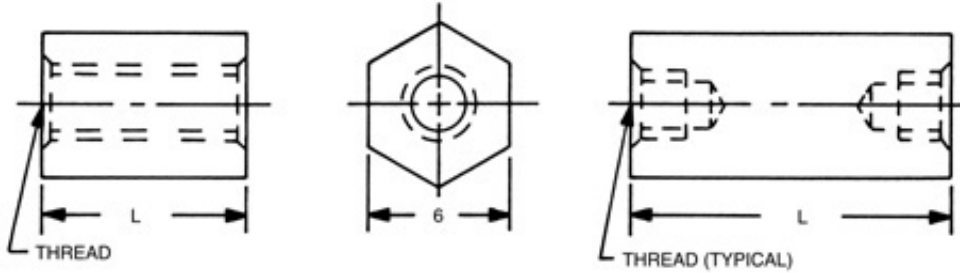

RAF

RAF

Order Code:

Finishes: [\[How to create part numbers\]](#) [\[Material Specifications\]](#)

SELECT	PART NO.	LENGTH
<input type="checkbox"/>	M1300	3
<input type="checkbox"/>	M1301	4
<input type="checkbox"/>	M1302	5
<input type="checkbox"/>	M1303	6
<input type="checkbox"/>	M1304	7
<input type="checkbox"/>	M1305	8
<input type="checkbox"/>	M1306	9
<input type="checkbox"/>	M1307	10
<input type="checkbox"/>	M1308	11
<input type="checkbox"/>	M1309	12
<input type="checkbox"/>	M1310	13
<input type="checkbox"/>	M1311	14
<input type="checkbox"/>	M1312	15
<input type="checkbox"/>	M1313	16
<input type="checkbox"/>	M1314	17
<input type="checkbox"/>	M1315	18

SELECT	PART NO.	LENGTH
<input type="checkbox"/>	M1316	19
<input type="checkbox"/>	M1317	20
<input type="checkbox"/>	M1318	21
<input type="checkbox"/>	M1319	22
<input type="checkbox"/>	M1320	23
<input type="checkbox"/>	M1321	24
<input type="checkbox"/>	M1322	25
<input type="checkbox"/>	M1323	28
<input type="checkbox"/>	M1324	31
<input type="checkbox"/>	M1325	34
<input type="checkbox"/>	M1326	37
<input type="checkbox"/>	M1327	40
<input type="checkbox"/>	M1328	43
<input type="checkbox"/>	M1329	46
<input type="checkbox"/>	M1330	49
<input type="checkbox"/>	M1331	52

Select	CODE	THREAD
<input type="checkbox"/>	3005	M3x0.5
<input type="checkbox"/>	3506	M3.5x0.6
<input type="checkbox"/>	4007	M4x0.7

Select	CODE	MATERIAL	RoHS
<input type="checkbox"/>	A	ALUMINUM	NO
<input type="checkbox"/>	B	BRASS	YES
<input type="checkbox"/>	SS	STAINLESS STEEL	YES
<input type="checkbox"/>	S	STEEL	YES
<input type="checkbox"/>	N	NYLON	YES

Ordering Code			
mxxxx	xxxx	xx	xx
Thread		Finish	
Length		Material	

For non standard items please click here

For thread depth information please click here



© 1999 RAF Electronic Hardware All Rights Reserved

Seymour CT 06483 203 888-2133 Fax: 203 888-9860 www.rafhdwe.com