

FERYSTER

Sketch with main dimensions

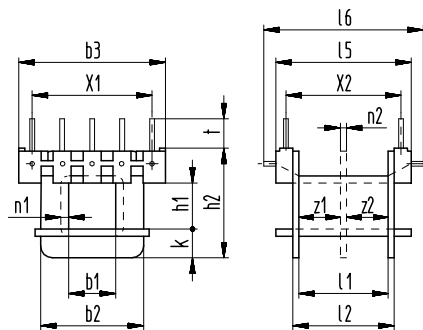

Standard: fully pinned, partial fitting on request.

t = standard pin length alternative pin length in brackets.

The grid distances X1/X2 can be used for metric and for inch measures.

ST
with molded-in pins $\varnothing 0,8$ mm

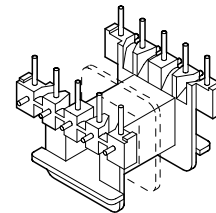

z1	z2	b1	b2	b3	h1	h2	k	l1	l2	l5	l6	n1	n2	t	X1	X2	X3 ①	Type	Art. No.	
$\pm 0,2$	$\pm 0,2$	$\pm 0,1$	$\pm 0,2$	$\pm 0,2$	$\pm 0,1$	$\pm 0,2$	$\pm 0,2$	$\pm 0,2$	$\pm 0,2$	$\pm 0,3$	$\pm 0,3$	+0,2	$\pm 0,1$	$\pm 0,2$	$\pm 0,2$	$\pm 0,2$				
7,3	7,3	7,7	17,2	25	7,7	17,7	4,8	15,6	16,8	22,2	24,6	0,6	1	3,2 (5)	4x5	20	2x5	EE 25/7,7/2 ST	Wz 7854/2 ST	3640

① X3 = max. number of slots or terminals

www.
FERYSTER[®]
-pl

FERYSTER® spółka jawna B. i Z. Sobków
PRODUCENT ELEMENTÓW INDUKCYJNYCH

EF25-K-H-10P-DS