



Sparkle Power Inc.
 A Leading Power Supply Manufacturer
 Web site: www.sparklepower.com



FSP400-601UC (Active PFC & RoHS Compliant)
400 Watts, ATX12V, EPS12V, 1U Switching Power Supply

Features

- Complied with ATX, ATX12V and EPS12V standard
- Active Power Factor Correction (PFC) meet EN61000-3-2
- High efficiency and reliability
- Remote ON/OFF function
- Internal 12V DC fan included
- Noise Killer (thermal fan speed control function)
- Low noise and ripple
- Complies with FCC part 15 subpart J class B 115Vac operation, and CISPR 22 class B at 230Vac operation
- Output over voltage, short circuit, and over current protection
- 100% Hi-pot, ATE, and burn-in tested
- Re-settable power shut down
- Approved by UL60950, CSA C22.2 NO. 60950, TUV EN60950 or VDE EN60950, NEMKO EN60950 (CB Report), CE

Input Characteristics

Input Range: 90 ~ 265Vac (RMS), Full Range Input

Frequency: 47 ~ 63Hz

Input Current: 6A (RMS) @115Vac, 3A (RMS) @230Vac

Inrush Current: 80A Max @115Vac, 120A Max @230Vac cold

start

Output Characteristics

Output Voltage	Minimum Load	Maximum Load	Load Reg.	Line Reg.	Ripple & Noise
+3.3V	0.2A	16A	± 5%	± 1%	50mV P-P
+5V	0.2A	16A	± 5%	± 1%	50mV P-P
+12V1	0.2A	18A	± 5%	± 1%	120mV P-P
+12V2	0.2A	16A	± 5%	± 1%	120mV P-P
-12V	0.0A	0.5A	± 10%	± 2%	120mV P-P
+5Vsb	0.1A	2.5A	± 5%	± 1%	50mV P-P

*+5V and +3.3V total output not exceed 132W

*+12V1 & +12V2 total current not exceed 30A

*+3.3V, +5V, and +12V total output cannot exceed 385W

* This subject power supply is 400W

Specification

- **Temperature Range:** Operating: 0°C ~ +50°C on full load; storage & shipping: -20°C ~ +80°C
- **Humidity:** 5 ~ 95% on operating and storage
- **Dielectric Withstand:** Input to frame ground 1800 VAC for 1 second
- **Efficiency:** 70% at minimum measured at nominal AC main voltage and frequency with maximum load on all outputs
- **Rise time:** Less than 20ms
- **Hold-up Time:** 18ms minimum at nominal input voltage
- **Power Good Signal:** Power on delay time 100 ~ 500ms, off delay 1ms minimum (TTL and CMOS compatible)
- **Leakage Current:** Not exceed 3.5mA at 264Vac, 50Hz
- **MTBF:** 100,000 hours on maximum load at +25°C
- **Dimensions (LxWxH):** 250x100x40.5mm/9.8x3.9x1.6inch

Sparkle Power Inc.
Main Office
 1000 Rock Avenue
 San Jose, CA 95131
 TEL: 408-519-8888
 FAX: 408-519-9999
 E-MAIL: info@sparklepower.com

Sparkle Power Inc.
Los Angeles Office
 17071 Green Drive
 City of Industry, CA 91745
 TEL: 626-839-7180
 FAX: 626-839-3395

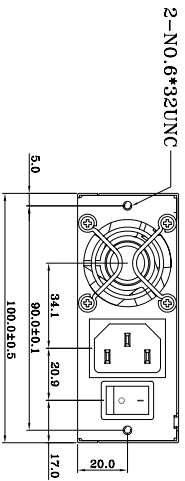
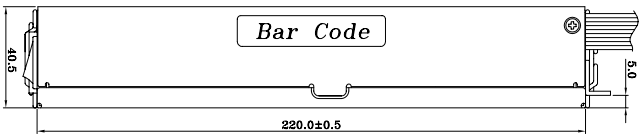
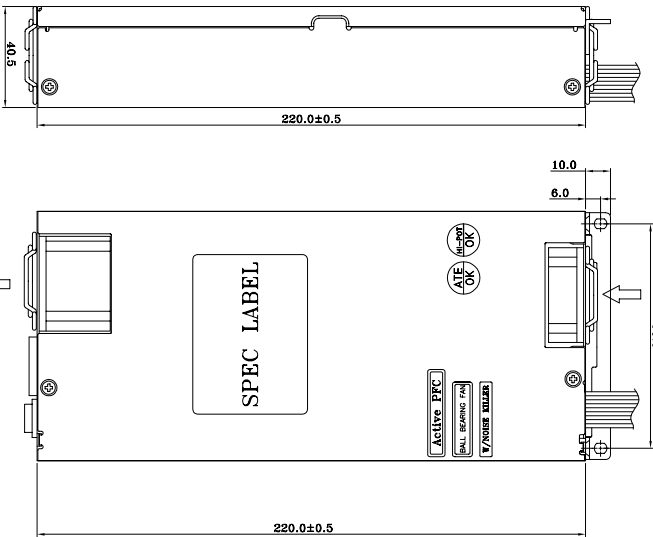
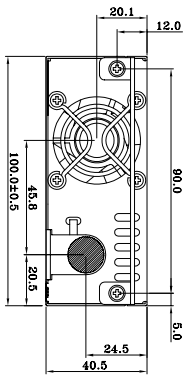
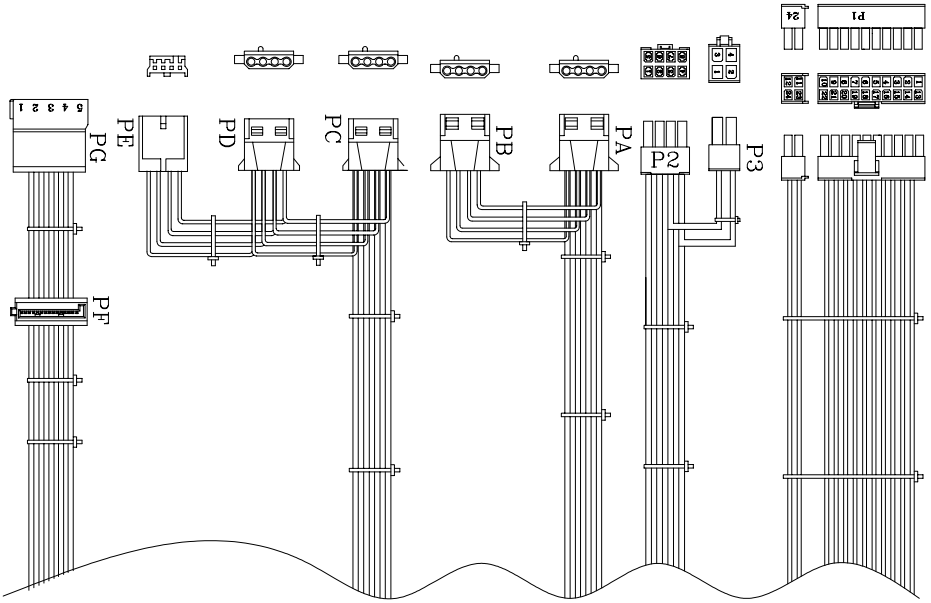

- NOTE:
1. ALL THE LENGTH OF OUTPUT WIRES EXCLUDE HOUSING.
 2. 產地標籤依業務指示加貼.

UNIT:mm

REF. ID.	NO.	PIN	SIGNAL	WIRE COLOR	Gauge	CONNECTOR TYPE	LENGTH
	1	+3.3VDC	ORANGE	18		ITT	695±20
	2	+3.3VDC	ORANGE	18		Bendag	mm
	3	COM	BLACK	18		B786-04N	
	4	+5VDC	RED	18		+B786-20N	
	5	COM	BLACK	18		as reference	
	6	+5VDC	RED	18			
	7	COM	BLACK	18			
	8	PM-OK	GRAY	18			
	9	+5V2B	PURPLE	18			
	10	+12V2	YELLOW	18			
	11	+12V2	YELLOW	18			
	12	+3.3VDC	ORANGE	18			
	13	+5V	BROWN	22			
	14	-12VDC	BLUE	18			
	15	COM	BLACK	18			
	16	PS-ON	GREEN	18			
	17	COM	BLACK	18			
	18	COM	BLACK	18			
	19	COM	BLACK	18			
	20	+5VDC	RED	18			
	21	+5VDC	RED	18			
	22	+5VDC	RED	18			
	23	+5VDC	RED	18			
	24	COM	BLACK	18			
	1	COM	BLACK	18		MOLEX	100±10
	2	COM	BLACK	18		39-01-	mm
	3	+12V1	YEL./BLACK	18		2040	
	4	+12V1	YEL./BLACK	18		or EQUIV.	
	1	+12V2	YELLOW	18		AMP	500±20
	2	COM	BLACK	18		1-60454-01mm	
	3	COM	BLACK	18		or EQUIV.	
	4	+5V	RED	18			
	1	+12V2	YELLOW	18		AMP	200±10
	2	COM	BLACK	18		1-60454-01mm	
	3	COM	BLACK	22		or EQUIV.	
	4	+5V	RED	18			
	1	+12V2	YELLOW	18		AMP	200±10
	2	COM	BLACK	22		171822-4	
	3	COM	BLACK	22		or EQUIV.	
	4	+5V	RED	18			
	1	+12V2	YELLOW	18		AMP	500±20
	2	COM	BLACK	18		CL1271HS8	
	3	+5V	RED	18		-15P	
	4	COM	BLACK	18		or EQUIV.	
	5	+3.3V	ORANGE	18			
	1	+12V2	YELLOW	18		AMP	200±10
	2	COM	BLACK	18		CL1270HS6	
	3	+5V	RED	18		-15P	
	4	COM	BLACK	18		or EQUIV.	
	5	+3.3V	ORANGE	18			

FSP P/N.:9PA4003001
SPI P/N.:FSP400-601UC

MODEL NO. : FSP400-601UC(S031)	TITLE: ASSY	SHEET: 1 OF 1	REV:01
R&D	PE	DRAWN	DATE
			Mar.02.2006
INTERIOR COUNTERSIGN:			黃鈺婷

Mechanical Drawing(外觀/機構圖)表單編號7000P-0111