

Rev	AWO #	Description	Date	Appr
-		RELEASED	9/16/04	

APPROVED: \_\_\_\_\_  
 DATE: \_\_\_\_\_ TITLE: \_\_\_\_\_

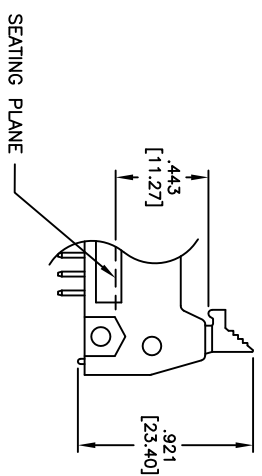
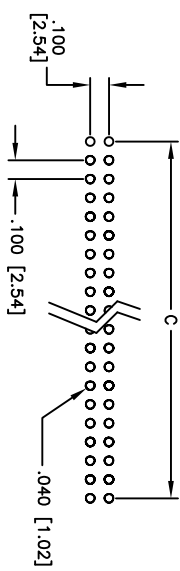
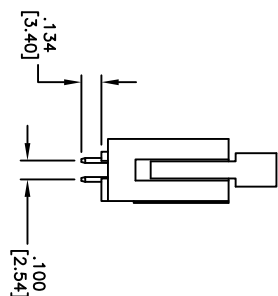
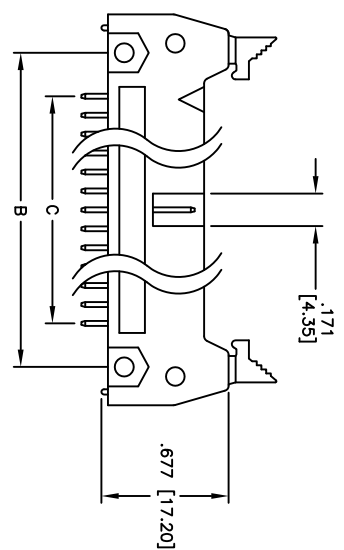
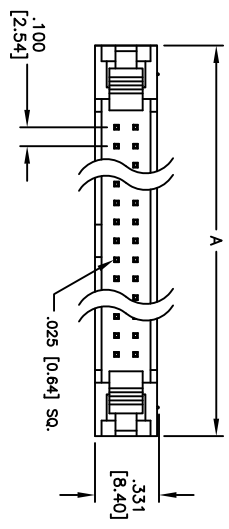

**SPECIFICATIONS:**

**Material:** Insulator: PBT, glass reinforced, rated UL 94V-0, color black  
**Contacts:** Brass

**Plating:** Tin over Copper underplate overall.  
**Electrical:**

**Operating voltage:** 250 VAC max  
**Current rating:** 3 Amps max  
**Contact Resistance:** 20 mohm max  
**Insulation resistance:** 5000 Mohm min  
**Dielectric withstanding voltage:** 1000 VAC

**Mechanical:**  
**Mating durability:** 500 cycles min  
**Temperature Rating:** Operating temperature: -55°C to +105°C  
**Environmental:** Lead free, ROHS compliant.  
**Recommended soldering temp:** 235°C for 5 sec.

Positions: 10, 14, 16, 20, 24, 26, 30, 34, 40, 50, 60, 64  
 A = .100 [2.54] x No. of Spaces + .860 [21.84]  
 B = .100 [2.54] x No. of Spaces + .460 [11.68]  
 C = .100 [2.54] x No. of Spaces

**ADAM TECH**

909 Rahway Avenue, Union, NJ 07083  
 Phone: 908-687-5000 Fax: 908-687-5710

TITLE: LATCH BOX HEADER, STRAIGHT  
 PCB TYPE, TIN PLATED

UNLESS OTHERWISE SPECIFIED ALL DIMENSIONS ARE MM [INCHES] TOLERANCES: EXCEPT AS NOTED		INCHES		HOLDS	
.X	± .10	ØX	± .10		
.XX	± .020	ØXXX	± .015		
.XXX	± .015	ØXXXX	± .010		
APPROVALS		DATE			
DRAWN	SS	9/16/04			
CHECKED					
APPROVED					
SIZE	PART NO.	MHR-XX-VTAS		REV	
X					
REF: S00089T	SCALE: NTS			SHEET 1 OF 1	

