

WITHOUT COVER

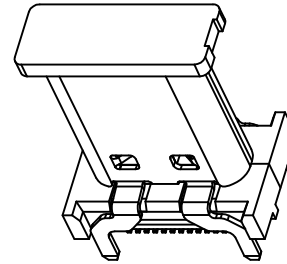

WITH COVER

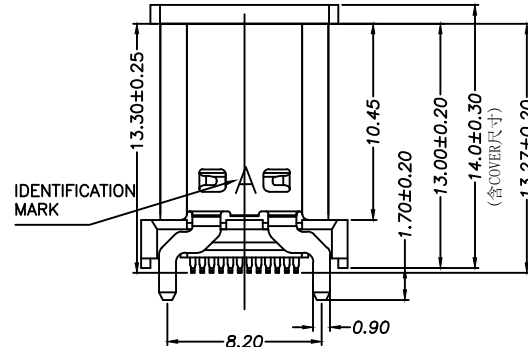
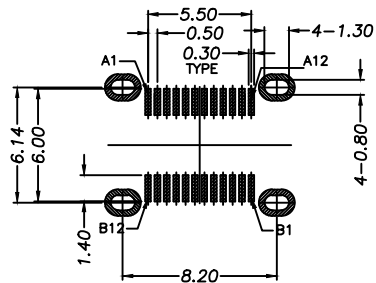
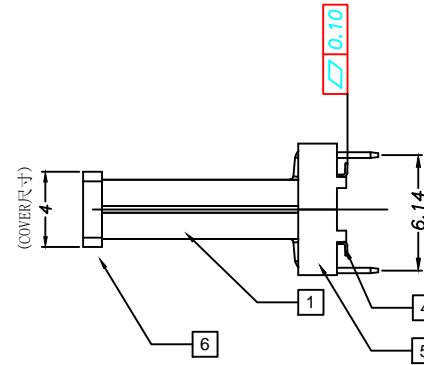
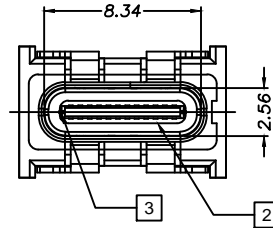
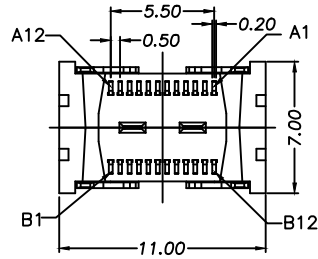

H	
1	13.00
2	13.50
3	15.00

Material:  
 Housing Material: High temperature thermoplastic  
 Contact Terminal: High Grade Copper Alloy  
 Metallic Shell: Stainless Steel  
 Inner Ground Cover Shell: Stainless Steel  
 Mid Plate: Stainless Steel  
 Plating  
 Data Contact  
 Underplating: 50μ" Min. Nickel  
 Contact Plating: 1μ" Gold  
 Solder Area: 80μ" Matte Tin  
 Shell  
 Metallic Shell: 50μ" Min. Nickel  
 Cover Shell  
 Metallic Shell: 80μ" Min. Nickel  
 Inner Ground Cover Shell  
 Metallic Shell: 50μ" Min. Nickel  
 Electrical  
 Voltage Rating: 20V DC  
 Current Rating: Vbus pins collectively 5.00A, GND pins collectively 6.25A, B5 pin 1.25A, Other pins 0.25A per pin.  
 Contact Resistance: 40mΩ Max.  
 Insulation resistance: 100 MΩ MIN.  
 Dielectric withstanding voltage: 100V AC/Minute  
 Mechanical  
 Durability: 10,000 cycles  
 Mating Force: 5 to 20N  
 Unmating Force: 8 to 20N (post test)

A1	GND	B12	GND
A2	SSTXP1	B11	SSRXP1
A3	SSTXN1	B10	SSRXN1
A4	VBUS	B9	VBUS
A5	CC1	B8	SBU2
A6	DP1	B7	DN2
A7	DN1	B6	DP2
A8	SBU1	B5	CC2
A9	VBUS	B4	VBUS
A10	SSRXN2	B3	SSTXN2
A11	SSRXP2	B2	SSTXP2
A12	GND	B1	GND
PIN	SIGNAL NAME	PIN	SIGNAL NAME

### U263-24XN-4BQC16-X

01:AU 1U"Min  
 03:AU 3U"Min  
 05:AU 5U"Min  
 10:AU 10U"Min  
 15:AU 15U"Min  
 30:AU 30U"Min

1:PBT  
 2:PA6T  
 3:PA9T  
 4:LCP

W:WHITE  
 B:BLACK

RECOMMEND P.C.B LAYOUT(COMPONENT SIDE)  
 TOLERANCE FOR PCB LAYOUT IS ± 0.05  
 KEEP OUT AREA

REVISIONS					UNSPECIFIED TOLERANCES	DSND	DATE	SCALE: N/A	MODEL TYPE: 3.1 TYPE C
ΔX					ANGULAR			VIEW:	PART NO.:
ΔX					L ≤ 4			UNIT: mm/in	DWG NO.:
ΔX					4 < L ≤ 16			SIZE: A4	U263-24XN-4BQC16-X
MARK	DESCRIPTION	DATE	REVISED	APPROVED	16 < L ≤ 63				WEIGHT
					L > 63				SHEET
									REVISION
									1/1
									A0