

## 571-4250 Insulated solder terminal, Turreted, Feed thru

Recommended mounting hole .158 (4,01)

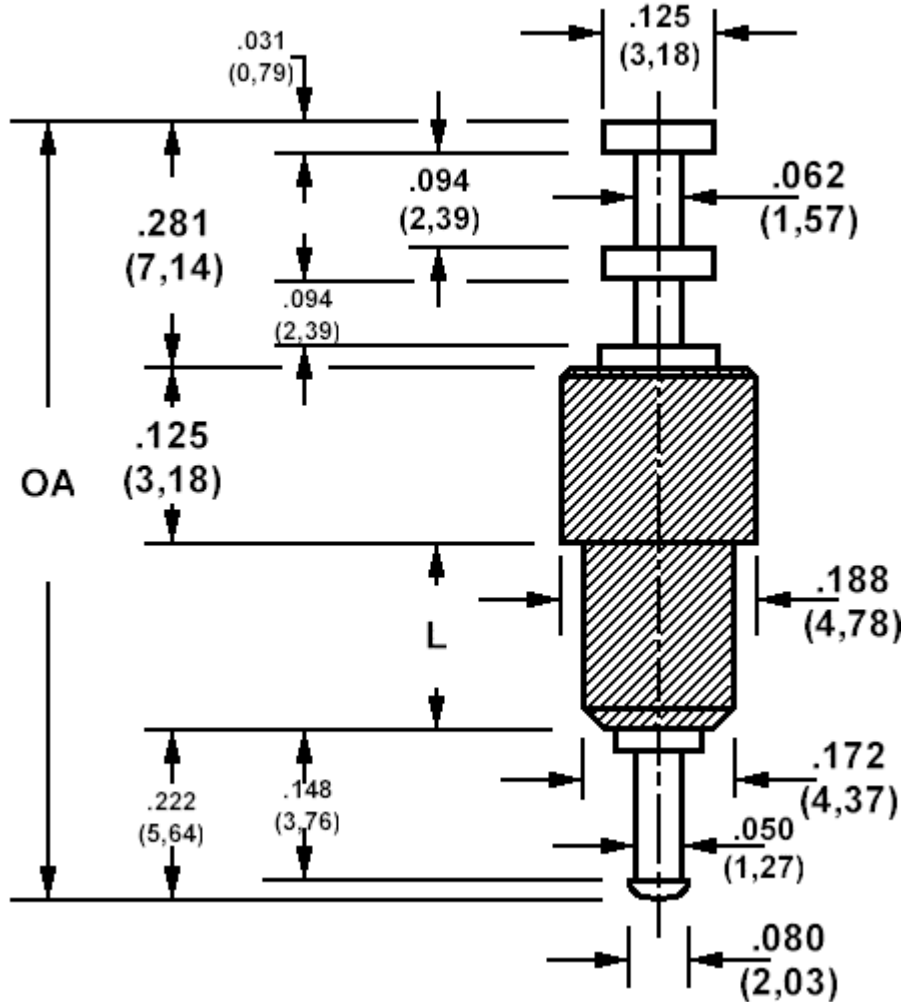

How to order code  
**571-4250-01-YY-19**

Basic Part No (XX = panel thickness, YY = plating finish. See tables for options)

Basic Part No.		OA (ref)	L	Panel Thickness (XX)
571-4250	-01	0.828 (21,03)	.200 (5,08)	.031 (0,79) to .162 (4,11)

Component	Material	Finish (YY)	
		-01	-05
Terminal	Brass	Silver	Electro Solder
Insulator	Teflon - white		

Additional Specifications	
Flashover VRMS at Sea Level	5500
Capacitance (pF)	1.0

Teflon is a registered trademark of Dupont