

PART NUMBER	TAB SIZE	WIRE RANGE AWG	DIMENSIONS in.		
			A $\pm .015$	B $\pm .010$	C $\pm .010$
D18-250B	.250 X .032 (6.4 X 0.8)	22-18	.63 (16.0)	.30 (7.6)	.12 (3.0)
D14-250B	.250 X .032 (6.4 X 0.8)	16-14	.63 (16.0)	.30 (7.6)	.12 (3.0)

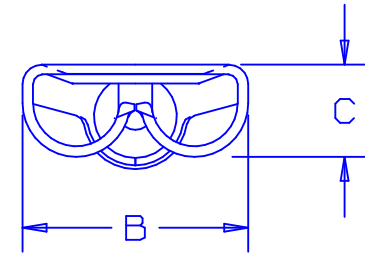

NOTES:

- USED FOR:  
A. STRANDED COPPER WIRE ONLY  
B. 302°F (150°C) MAX TEMP RATING
- PACKAGE QTY:  
A. STD: C=100  
B. BULK: M=1000
- MATERIAL:  
A. STAMPING: .016 (0.41) THK BRASS, TIN PLATED
- WIRE STRIP LENGTH  $9/32 \begin{matrix} +1/32 \\ -0 \end{matrix}$  ( $7.1 \begin{matrix} +0.8 \\ -0 \end{matrix}$ )
- FIRST INSERTION FORCE: 12 LB (53N) MAX  
FIRST WITHDRAWAL FORCE: 12 LB (53N) MAX  
6 LB (27N) MIN
- INSTALLATION TOOLS:  
A. CT-100 (POCKET B)
- DIMENSIONS IN BRACKETS ARE IN MILLIMETERS OR mm<sup>2</sup>

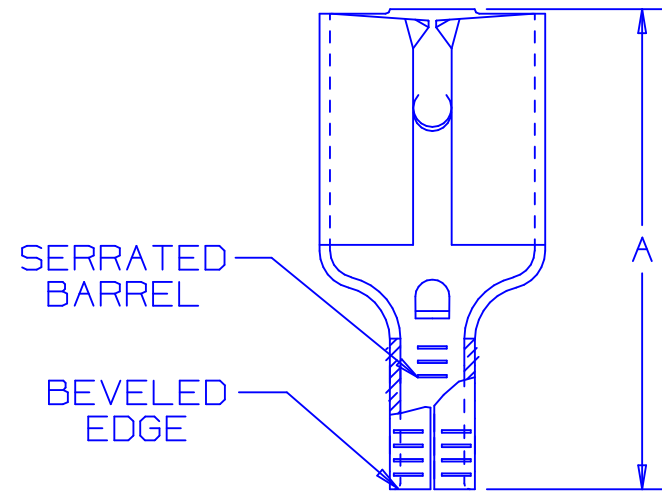

CERTIFIED  
LR31212

A41209\_07

07	7/03	KLFU		ADDED INTERNAL SERRATIONS			
06	1/01	KMDS	SKB	CAD FILE SPEC. WAS N41209AA_PCD_05	8938	JAC	CCH
05	6-95	MS		UPDATED NOTES AND DIMENSIONS	03372		
04	8-88	DW	MC	REDRAWN WITH REVISIONS			JRB
REV	DATE	BY	CHK	DESCRIPTION	ECN#	CUST	PM

**PANDUIT**

CORP.

TINLEY PARK, ILLINOIS

NON-INSULATED FEMALE DISCONNECT  
(BUTTED SEAM)

DRAWN BY DAW    CHK'D    SCALE NONE    DRAWING NO. A41209