

### 1. Mechanical Dimensions:

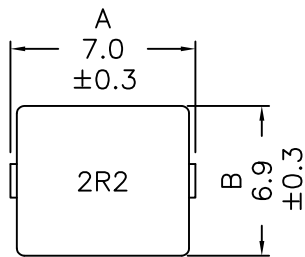

Top view

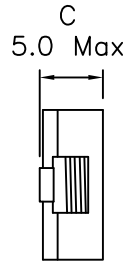

Side view

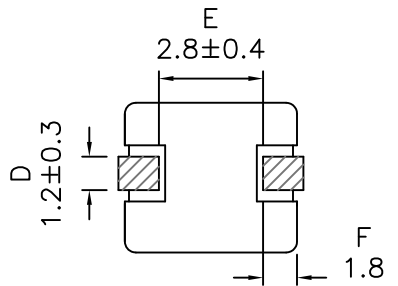

Bottom view

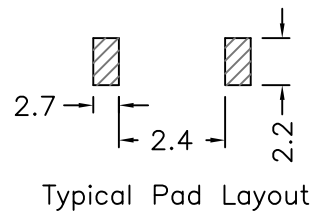

Typical Pad Layout

### 2. Schematic:

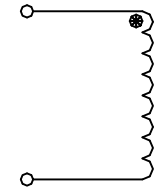

### 3. Electrical Specifications:

OCL: 2.20uH±20% @100KHz 0.25V, 0.0Adc

Q: tbd Min @100KHz 0.25V

Isat: 14.0Adc (Based on 20% Typ drop in OCL)

Irms: 8.0Adc (Based on 40°C Temp Rise Typ)

DCR: 17.7 mOhms ±10%

#### Notes:

1. Solderability: Leads shall meet MIL-STD-202G, Method 208H for solderability.
2. Flammability: UL94V-0
3. ASTM oxygen index: > 28%
4. Insulation System: Class F 155°C. UL file E151556
5. Operating Temperature Range: All listed parameters are to be within tolerance from -40°C to +85°C
6. Storage Temperature Range: -55°C to +125°C
7. Aqueous wash compatible
8. SMD Lead Coplanarity: ±0.004"(0.102mm)
9. Electrical and mechanical specifications 100% tested
10. RoHS Compliant Component

**PRELIMINARY**

DOC. REV: A/1

<b>XFMRs Inc.</b> www.XFMRs.com	Title: <b>SMD INDUCTORS</b>		
	UNLESS OTHERWISE SPECIFIED	P/N: XFHCL6MD-2R2M	REV. A
TOLERANCES: .xx ±0.25 Dimensions in MM	DWN.	Feng	Jul-10-12
	CHK.	YK Liao	Jul-10-12
SHEET 1 OF 1	APP.	BSJ	Jul-10-12