

RL-4400-1H

COMMON MODE CHOKES

DESCRIPTION

- Common Mode Choke

ENVIRONMENTAL DATA

- Storage temperature range: -55°C to +130°C
- Operating temperature range: -40°C to +130°C

PACKAGING INFORMATION

- Packaging information: pg. 494

FEATURES & APPLICATIONS

- Maximize performance in the smallest possible package
- High inductance and high current capabilities
- Three sizes available with inductance values ranging from 390 μ H to 18.7 mH
- Current rating ranging from 220 mA to 1.60 A
- Dielectric withstanding voltage rated at 2000 VAC line to line, 750 VAC wind to core
- Temperature rise: 50°C max

Verify operation with sample in actual circuit. Order samples at www.rencousa.com.

MECHANICAL DIMENSIONS

U.S. Standard (mm)

PART NUMBER	A (MAX.)	B (MAX.)	C (MAX.)	D (MIN.)	E (REF.)	F (REF.)
RL-4400-1H	0.650 (16.51)	0.510 (12.95)	0.590 (14.99)	0.125 (3.18)	0.276 (7.00)	0.315 (8.00)

PART NUMBER	PART WEIGHT
RL-4400-1H	6.0g (0.21oz)

FRONT VIEW

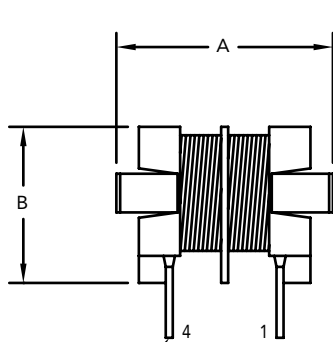

PIN DIMENSION
0.023 (0.58)

SIDE VIEW

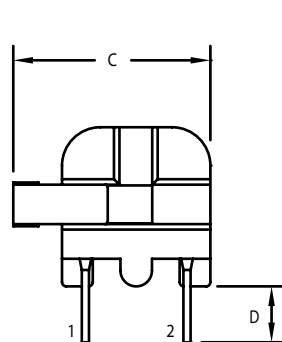

RECOMMENDED PCB LAYOUT

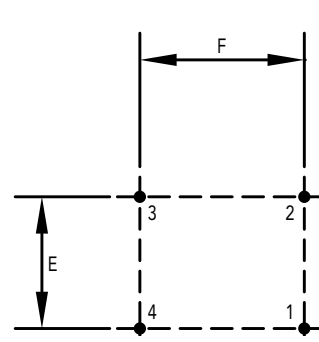

SCHEMATIC

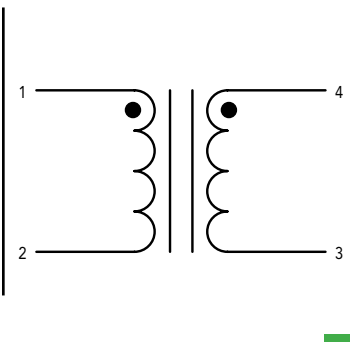

RENCO ELECTRONICS INC.

595 International Place, Rockledge, FL 32955-4200 USA • www.rencousa.com • ISO 9001 Certified
Toll Free Engineering Hot Line: 800.645.5828 • P: 321.637.1000 • F: 321.637.1600



RL-4400-1H

Renco Part No. RL-4400-1H	Inductance (mH) -0+60%	DCR Max. (Ohms)	I _{rms} (A)
RL-4400-1H-0.39	0.39	0.08	1.60
RL-4400-1H-0.68	0.68	0.13	1.20
RL-4400-1H-0.90	0.90	0.19	1.00
RL-4400-1H-1.40	1.40	0.30	0.80
RL-4400-1H-2.10	2.10	0.48	0.65
RL-4400-1H-3.30	3.30	0.74	0.50
RL-4400-1H-4.90	4.90	1.20	0.40
RL-4400-1H-7.40	7.40	1.80	0.35
RL-4400-1H-11.5	11.50	2.80	0.27
RL-4400-1H-18.7	18.70	4.45	0.22

NOTES:

1. ELECTRICAL SPECIFICATIONS MEASURED AT 25°C
2. I_{rms} - CURRENT THAT CAUSES THE TEMPERATURE TO RISE APPROX. 40°C ABOVE AMBIENT OF 25°C
3. INDUCTANCE TESTED AT 10 kHz, 0.1 V_{rms}

