

PART NO.	CURRENT RATING	BODY COLOR	RATED VOLTAGE
0293525.MXJ	25 A	LIGHT BROWN	32 V
0293530.MXJ	30 A	LIGHT GREEN	32 V

ELECTRICAL CHARACTERISTICS TEST

% OF RATED CURRENT	CLEARING TIME 25A - 30A	
	MIN.	MAX.
110 %	-	-
150 %	-	-
200 %	5 SEC.	70 SEC.
300 %	-	6 SEC.
400 %	-	3 SEC.

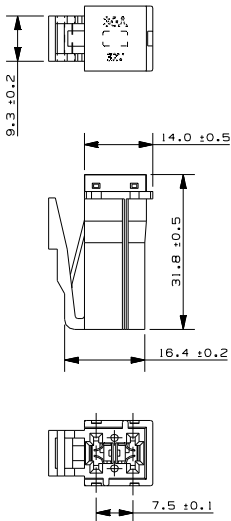
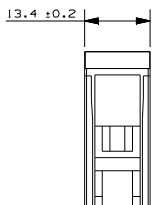

PART NO.	CURRENT RATING	BODY COLOR	RATED VOLTAGE
0293545.MXJ	45 A	RED	32 V
0293565.MXJ	65 A	BLACK	32 V
0293575.MXJ	75 A	GRAY	32 V

ELECTRICAL CHARACTERISTICS TEST

% OF RATED CURRENT	CLEARING TIME 45A - 75A	
	MIN.	MAX.
110 %	14,400 SEC.	-
150 %	100 SEC.	-
200 %	2 SEC.	60 SEC.
300 %	-	5 SEC.
400 %	-	2 SEC.

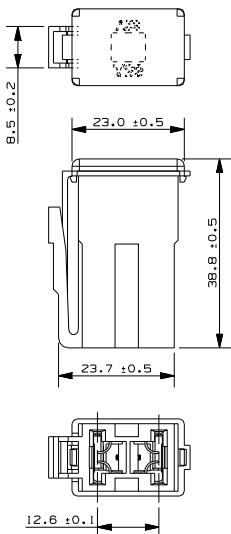
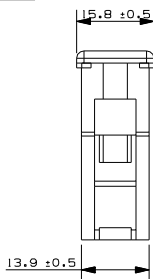

NO	COMPONENT NO	DESCRIPTION	QTY/M	U/M
BILL OF MATERIAL				
UNLESS OTHERWISE SPECIFIED, DIMENSIONS ARE IN MILLIMETERS. DIMENSIONS IN BRACKETS [] ARE INCHES UNLESS OTHERWISE SPECIFIED, DIMENSIONS DO NOT INCLUDE PLATING.				
©	DENOTES CRITICAL CHARACTERISTICS.			
CPK	DENOTES CPK DIMENSIONS. -MINIMUM CPK VALUE			
(ST)	DENOTES A CHARACTERISTIC THAT PROVIDES AN INDICATION OF PROCESS PERFORMANCE. PROCEDURE FOR MEASUREMENT AND TRACKING TO BE DEFINED IN LITTELFUSE INSPECTION INSTRUCTIONS			
CP	DENOTES CP DIMENSIONS. -MINIMUM CP VALUE MUST BE WITHIN THE DIMENSIONAL LIMITATIONS SHOWN ON DRAWING AND INITIALLY LOCATED TO ALLOW FOR MAXIMUM TOOL LIFE			

COPIES TO		MATERIAL SPEC	
1	9	FINISH	1:1
2	10	SCALE	1:1
3	12	DATE	08/13/10
4	13	DATE	SUPER DR
5	14	DATE	FINISH GOOD WT
6	15	DATE	GRAMS/PIECE
7	16	DATE	0.5 - 50 0.5 - 50 0.5 - 50 0.5 - 50
8	17	DATE	10.05 10.05 10.05 10.05
18	18	DATE	120 - 400 120 - 400 120 - 400 120 - 400
19	19	DATE	±0.15 ±0.15 ±0.15 ±0.15
20	20	DATE	±0.2 ±0.2 ±0.2 ±0.2
21	21	DATE	±0.15 ±0.15 ±0.15 ±0.15
22	22	DATE	±0.15 ±0.15 ±0.15 ±0.15
23	23	DATE	±0.15 ±0.15 ±0.15 ±0.15
24	24	DATE	±0.15 ±0.15 ±0.15 ±0.15
25	25	DATE	±0.15 ±0.15 ±0.15 ±0.15
26	26	DATE	±0.15 ±0.15 ±0.15 ±0.15
27	27	DATE	±0.15 ±0.15 ±0.15 ±0.15
28	28	DATE	±0.15 ±0.15 ±0.15 ±0.15
29	29	DATE	±0.15 ±0.15 ±0.15 ±0.15
30	30	DATE	±0.15 ±0.15 ±0.15 ±0.15
31	31	DATE	±0.15 ±0.15 ±0.15 ±0.15
32	32	DATE	±0.15 ±0.15 ±0.15 ±0.15
33	33	DATE	±0.15 ±0.15 ±0.15 ±0.15
34	34	DATE	±0.15 ±0.15 ±0.15 ±0.15
35	35	DATE	±0.15 ±0.15 ±0.15 ±0.15
36	36	DATE	±0.15 ±0.15 ±0.15 ±0.15
37	37	DATE	±0.15 ±0.15 ±0.15 ±0.15
38	38	DATE	±0.15 ±0.15 ±0.15 ±0.15
39	39	DATE	±0.15 ±0.15 ±0.15 ±0.15
40	40	DATE	±0.15 ±0.15 ±0.15 ±0.15
41	41	DATE	±0.15 ±0.15 ±0.15 ±0.15
42	42	DATE	±0.15 ±0.15 ±0.15 ±0.15
43	43	DATE	±0.15 ±0.15 ±0.15 ±0.15
44	44	DATE	±0.15 ±0.15 ±0.15 ±0.15
45	45	DATE	±0.15 ±0.15 ±0.15 ±0.15
46	46	DATE	±0.15 ±0.15 ±0.15 ±0.15
47	47	DATE	±0.15 ±0.15 ±0.15 ±0.15
48	48	DATE	±0.15 ±0.15 ±0.15 ±0.15
49	49	DATE	±0.15 ±0.15 ±0.15 ±0.15
50	50	DATE	±0.15 ±0.15 ±0.15 ±0.15
51	51	DATE	±0.15 ±0.15 ±0.15 ±0.15
52	52	DATE	±0.15 ±0.15 ±0.15 ±0.15
53	53	DATE	±0.15 ±0.15 ±0.15 ±0.15
54	54	DATE	±0.15 ±0.15 ±0.15 ±0.15
55	55	DATE	±0.15 ±0.15 ±0.15 ±0.15
56	56	DATE	±0.15 ±0.15 ±0.15 ±0.15
57	57	DATE	±0.15 ±0.15 ±0.15 ±0.15
58	58	DATE	±0.15 ±0.15 ±0.15 ±0.15
59	59	DATE	±0.15 ±0.15 ±0.15 ±0.15
60	60	DATE	±0.15 ±0.15 ±0.15 ±0.15
61	61	DATE	±0.15 ±0.15 ±0.15 ±0.15
62	62	DATE	±0.15 ±0.15 ±0.15 ±0.15
63	63	DATE	±0.15 ±0.15 ±0.15 ±0.15
64	64	DATE	±0.15 ±0.15 ±0.15 ±0.15
65	65	DATE	±0.15 ±0.15 ±0.15 ±0.15
66	66	DATE	±0.15 ±0.15 ±0.15 ±0.15
67	67	DATE	±0.15 ±0.15 ±0.15 ±0.15
68	68	DATE	±0.15 ±0.15 ±0.15 ±0.15
69	69	DATE	±0.15 ±0.15 ±0.15 ±0.15
70	70	DATE	±0.15 ±0.15 ±0.15 ±0.15
71	71	DATE	±0.15 ±0.15 ±0.15 ±0.15
72	72	DATE	±0.15 ±0.15 ±0.15 ±0.15
73	73	DATE	±0.15 ±0.15 ±0.15 ±0.15
74	74	DATE	±0.15 ±0.15 ±0.15 ±0.15
75	75	DATE	±0.15 ±0.15 ±0.15 ±0.15
76	76	DATE	±0.15 ±0.15 ±0.15 ±0.15
77	77	DATE	±0.15 ±0.15 ±0.15 ±0.15
78	78	DATE	±0.15 ±0.15 ±0.15 ±0.15
79	79	DATE	±0.15 ±0.15 ±0.15 ±0.15
80	80	DATE	±0.15 ±0.15 ±0.15 ±0.15
81	81	DATE	±0.15 ±0.15 ±0.15 ±0.15
82	82	DATE	±0.15 ±0.15 ±0.15 ±0.15
83	83	DATE	±0.15 ±0.15 ±0.15 ±0.15
84	84	DATE	±0.15 ±0.15 ±0.15 ±0.15
85	85	DATE	±0.15 ±0.15 ±0.15 ±0.15
86	86	DATE	±0.15 ±0.15 ±0.15 ±0.15
87	87	DATE	±0.15 ±0.15 ±0.15 ±0.15
88	88	DATE	±0.15 ±0.15 ±0.15 ±0.15
89	89	DATE	±0.15 ±0.15 ±0.15 ±0.15
90	90	DATE	±0.15 ±0.15 ±0.15 ±0.15
91	91	DATE	±0.15 ±0.15 ±0.15 ±0.15
92	92	DATE	±0.15 ±0.15 ±0.15 ±0.15
93	93	DATE	±0.15 ±0.15 ±0.15 ±0.15
94	94	DATE	±0.15 ±0.15 ±0.15 ±0.15
95	95	DATE	±0.15 ±0.15 ±0.15 ±0.15
96	96	DATE	±0.15 ±0.15 ±0.15 ±0.15
97	97	DATE	±0.15 ±0.15 ±0.15 ±0.15
98	98	DATE	±0.15 ±0.15 ±0.15 ±0.15
99	99	DATE	±0.15 ±0.15 ±0.15 ±0.15
100	100	DATE	±0.15 ±0.15 ±0.15 ±0.15

TOLERANCES UNLESS OTHERWISE SPECIFIED (REF. ISO 2768-PM)

30° ANGLE PROJECTION

REVISION DRWG. NO. 0293500.MXJ

SL O W B L O W

FUSE - PAL 293 ATP 32V

LITTELFUSE

LIPA CITY, BATANGAS, PHILIPPINES

REVISION A