

Kinghelm®

REVISIONS					
REV	NUMBER	DESCRIPTION	DWN	CHK	DATE
A		DESIGN			

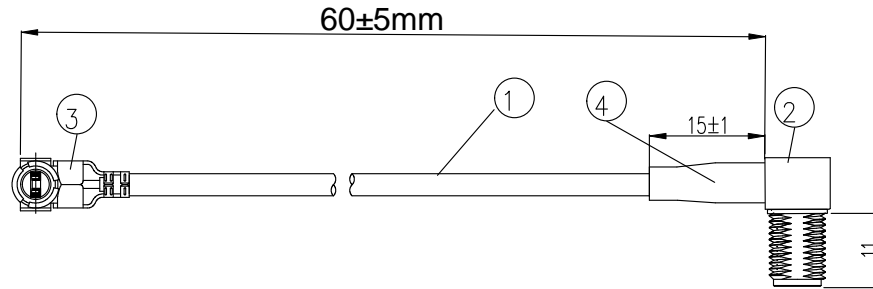

NOTES:

1. ELECTRICAL:
 - 1.1. VOLTAGE RATING:DCV 100V 10MS
 - 1.2. CONDUCTANCE RESISTANCE: 3.0 OHM/MAX.
 - 1.3. INSULATION RESISTANCE: 20M OHM/MIN.
 - 1.4. THE CABLE SHOULD BE 100% ELECTRICAL TEST
 - 1.5. IT SHOULD BE NO ANY OPEN/SHORT, MISWIRING AND INTERMITTENT FAILURES.
2. MATERIAL:
 - 2.1. SEE TABLE
3. ALL COMPONENTS ARE RoHS COMPLIANT.

ITEM NO.	PART NUMBER	DESCRIPTION	QTY.
④	套管	黑色热缩套管, 2.5*15MM	AS
③	接头	IPEX 1.13国产端子	1
②	接头	SMA 母头母针 弯头, 11牙, 镀金	1
①	同轴线	RF1.13黑色线,OD: 1.10mm	AS

深圳市金航标电子有限公司

WWW.BDS666.COM

型号: KH-IPEX-SMA-W-60

0755-83044319

ALL DIMENSION ARE IN MM	DRAWN Jamy	DATE 2019 /03 /01
	ENG.	
COMPUTER GENERATED IN SOLIDWORKS	MFG.	
DO NOT SCALE THIS DRAWING	Q.A.	

I-pex1.13-to sma/f L=60MM

CUSTOMER P/N:

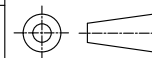

GENERAL TOLERANCE FOR ANGLES X.X X.XX X.XXX
± 1° ± 0.3 ± 0.25 ± 0.150

SIZE	Number	REV
B		A

SCALE: Free TYPE SHEET 1 OF 1