



Features

- 100A contact switching capability
- Low coil power consumption and Pulse driven
- Dielectric Strength of 4KV between coil and contacts
- Excellent anti shock ability and high reliability
- Both single and dual coil relay available
- Environmental friendly product (RoHS Compliant)

Contact Capacity

Model	SY32
Nominal switching capacit (res load)	100A 250 VAC
Max switching current	100A
Max switching voltage	250VAC
Max switching power	25,000 VA

Characteristic Data

Contact material	Silver alloy	
Initial contact resistance (at 6VDC 1A)	2m Ω Max.	
Operate time (at nominal volt).	30msec .Max.	
Release time (at nominal volt).	30msec .Max.	
Initial insulation resistance	1,000M Ω Min.(DC500V)	
Initial dielectric strength	Between open contacts : AC 1,000V , 50/60Hz 1min	
	Between coil and contact : AC4,000V , 50/60Hz 1min	
Vibration resistance	Functional	10 ~ 55Hz at double amplitude of 1.5 mm
	Destructive	10 ~ 55Hz at double amplitude of 1.5mm
Shock resistance	Functional	100GMin.
	Destructive	10 G min.
Endurance (operations)	Mechanical (at 1,800 ops./h)	200,000 cycles
	Electrical (at 120 ops./h)	1,000 cycles
Ambient temperature	-40°C ~ +70°C (no condensation)	

Coil Data (at 20°C)

Nominal voltage (VDC)	Single coil resistance 10% (Ω)	Dual coil resistance 10% (Ω)		Operate voltage (Max)	Release voltage (Max)	Pulse duration (ms)	Standard Nominal operating power
		set	reset				
5	8.4	4.2	4.2	80 % of nominal voltage	80 % of nominal voltage	100Min.	Single/Dual: 3.0W /6.0W
6	12.5	6	6				
9	27	13.5	13.5				
12	50	24	24				
18	108	54	54				
24	192	96	96				
48	768	384	384				

Ordering Information

Nomenclature								
SY32	-100	-1	12	D	M	2	R	-XX
Special Parameter : Nil-Standard type,XX-Customized Requirement								
Polarity : Nil-Positive polarity, R-Reverse polarity								
Coil Type:1-Single coil,2-Dual coils								
Contact Form : M-Form A,B-FormB								
Coil Power : D:Standard type -Single/Dual:3.0W/6.0W								
Coil Voltage (VDC) : 05 , 06 , 09 , 12 , 18 , 24 , 48								
Number of Poles : 1-1 Pole								
Switching Capacity: 100A								
Type Designation : SY32								

Outline Dimensions, Wiring Diagram, (unit : mm)Mounting Holes

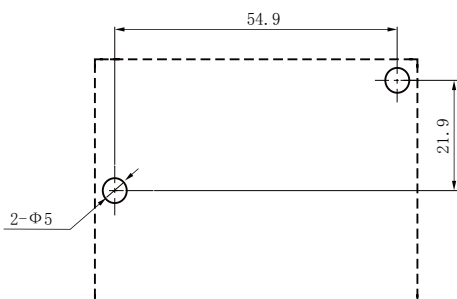
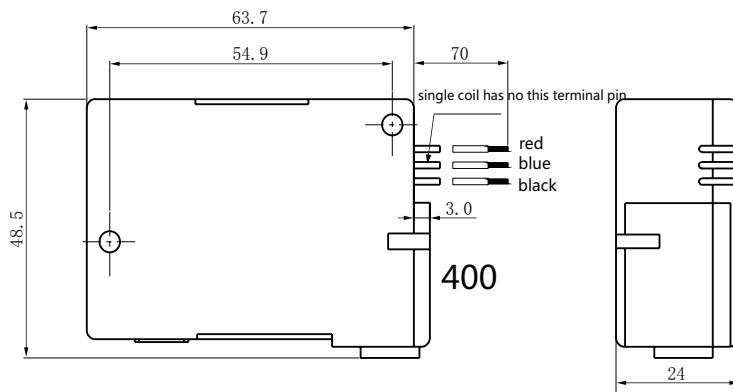

Unless other wise specified :

If dimension < 1mm, tolerance : $\pm 0.2\text{mm}$;

If dimension 1~5mm, tolerance : $\pm 0.3\text{mm}$;

If dimension > 5mm, tolerance : $\pm 0.4\text{mm}$.

Note : 1. Extended terminal dimension is dimension before soldering .

2. Tolerance of mounting holes : $\pm 0.5\text{mm}$.

Typical Applications

● Industrial machinery

● Electrical device

● Air conditioner and home appliances

Wiring diagram

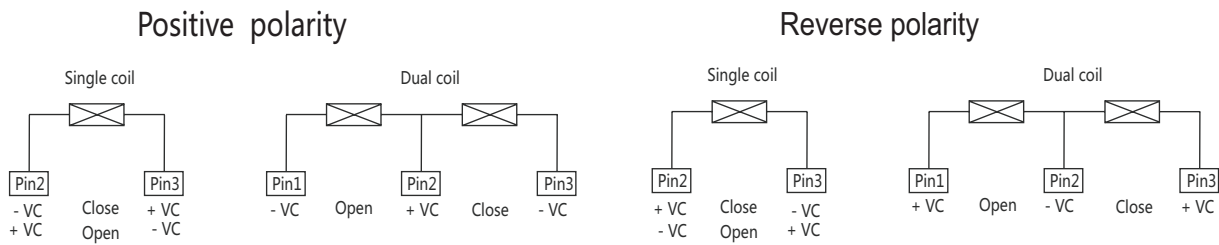

Typical drawing

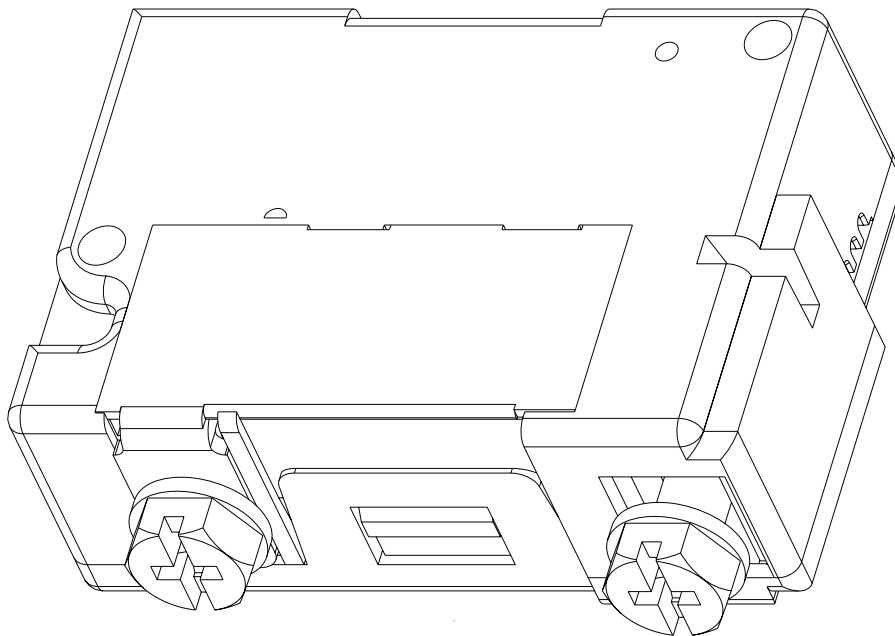

Note:

Typical drawing is just for reference customized terminals with metering components are acceptable
Please contact us for any special requirements.

Announcements :

- 1 The magnetic latching relay is to be supplied with contacts close (Operate) or contacts open (Release), but the contact status may got changed due to unexpected shock or vibration during delivering or mounting You can reset the contact status according to your requirement.
- 2 In order to make sure the contacts are completely closed or opened energized voltage to Operate or Release coil should be the nominal operate /release voltage, impulse width should be 5 times more than specified operate /release time in the specification but less than 1minute .Do not apply power to Operate and Release coils at the same time.

Disclaimer:

This datasheet is just for customer's reference, The newest specification you can get from the website of sanyou relays. We could not evaluate all the performances and parameters for all possible applications, so the user should choose the suitable relay for their own application or require us to provide necessary help. If there is any query, please contact Sanyou for the technical service however, it is the user's responsibility to determine which relay should be used.