

Rev	AWO #	Description	Date	Appr
-		RELEASED	2/15/11	

APPROVED: \_\_\_\_\_  
 DATE: \_\_\_\_\_ TITLE: \_\_\_\_\_

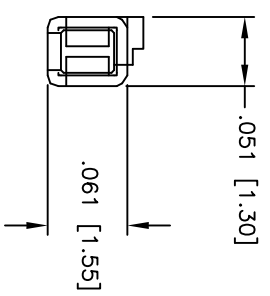
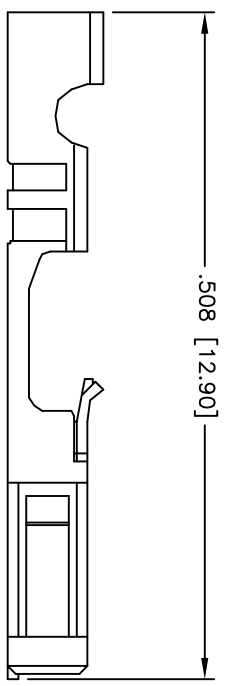
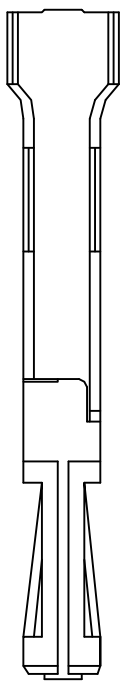

**SPECIFICATIONS:**

- Material: Contact: Phosphor Bronze
- Plating: Matte Tin over Copper underplate on tails
- Electrical: Operating voltage: 250 VAC max  
Current rating: 3 Amps max
- Contact resistance: 30 mohms max
- Dielectric withstanding voltage: 500 VAC for 1 minute
- Mechanical: Recommended Wire Range: 24 to 28 Awg
- Recommended Insulation Thickness: O.D. .063" [1.60mm] Max.
- Temperature Rating: Operating temperature: -40°C to +105°C
- Packaging: R = Chain on reel (15,000 pcs / Reel)
- Environmental: Lead free, RoHS compliant

**ADAM TECH**

909 Rahway Avenue, Union, NJ 07083  
 Phone: 908-687-5000 Fax: 908-687-5710

TITLE: CRIMP CONTACT, MATTE TIN PLATED

UNLESS OTHERWISE SPECIFIED ALL DIMENSIONS ARE INCHES [MM]	
TOLERANCES: EXCEPT AS NOTED	
INCHES	HOLE
.X ± .10	Ø.X ± .10
.XX ± .020	Ø.XXX ± .015
.XXX ± .015	Ø.XXX ± .010
APPROVALS	DATE
DRAWN AY	2/15/11
CHECKED JL	2/15/11
APPROVED	

SIZE X	PART NO. CDH-C-MT-R	REV. -
REF: S00018T	SCALE: NTS	SHEET 1 OF 1