

1. Features

1. This specification applies Low Profile Power Inductors.
2. 100% Lead(Pb) & Halogen-Free and RoHS compliant.
3. High reliability -Reliability test meet AEC-Q200
4. Operating temperature-55~+125°C (Including self - temperature rise)

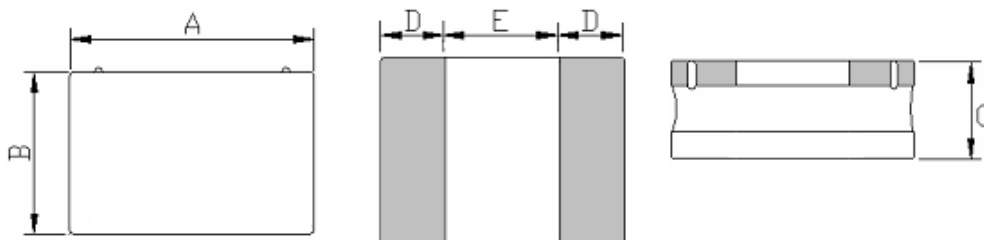

2. Dimension



| Series | A(mm) | B(mm) | C(mm) | D(mm) | E(mm) |
|-------------|---------------|---------------|--------|-----------|-----------|
| DFP201610TV | 2.0 -0.1/+0.2 | 1.6 -0.1/+0.2 | 1.0Max | 0.60 ref. | 0.80 ref. |

Units: mm

3. Part Numbering

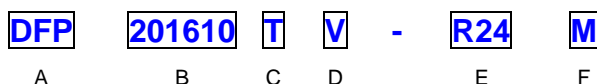

- A: Series
 B: Dimension
 C: Lead Free Material
 D: Category Code V=Vehicle
 E: Inductance R24=0.24uH
 F: Inductance Tolerance M=±20%

4. Specification

| TAI-TECH Part Number | Inductance (uH) | Tolerance (%) | Test Frequency (Hz) | DCR (Ω) typ. | DCR (Ω) Max. | I sat (A) typ. | I sat (A) Max. | I rms (A) typ | I rms (A) MAX |
|----------------------|-----------------|---------------|---------------------|--------------|--------------|----------------|----------------|---------------|---------------|
| DFP201610TV-R24M | 0.24 | ±20% | 0.1V/1M | 0.023 | 0.028 | 5.10 | 4.50 | 4.40 | 3.90 |
| DFP201610TV-R33M | 0.33 | ±20% | 0.1V/1M | 0.031 | 0.040 | 3.90 | 3.50 | 3.50 | 3.10 |
| DFP201610TV-R47M | 0.47 | ±20% | 0.1V/1M | 0.035 | 0.042 | 3.85 | 3.40 | 3.30 | 3.00 |
| DFP201610TV-R68M | 0.68 | ±20% | 0.1V/1M | 0.046 | 0.055 | 3.25 | 2.80 | 2.80 | 2.50 |
| DFP201610TV-1R0M | 1.0 | ±20% | 0.1V/1M | 0.059 | 0.072 | 2.90 | 2.50 | 2.40 | 2.20 |
| DFP201610TV-1R5M | 1.5 | ±20% | 0.1V/1M | 0.098 | 0.118 | 2.30 | 1.80 | 2.10 | 1.80 |
| DFP201610TV-2R2M | 2.2 | ±20% | 0.1V/1M | 0.141 | 0.170 | 2.10 | 1.70 | 1.70 | 1.55 |

