

MAPX	MODIFICATION	DATE

A
B
C
D
E
F
G

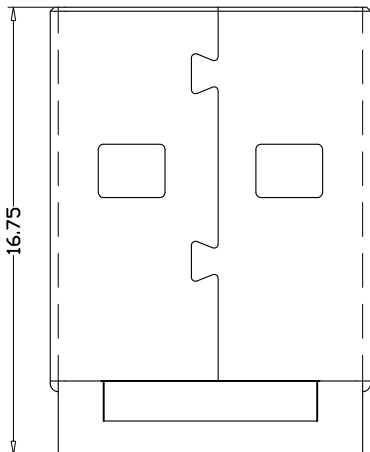
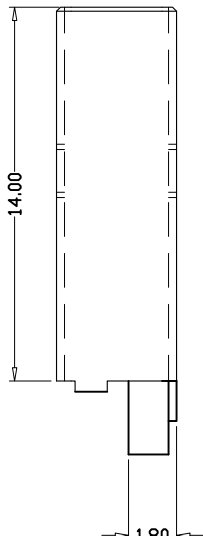
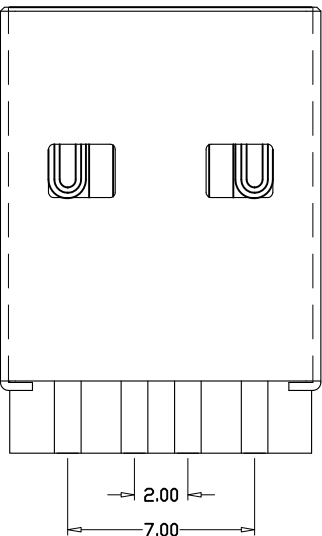

NOTES:
Housing: Thermoplastics
Contact: Copper Alloy
Shell: Copper Alloy/Steel
Voltage Current Rating:1.5 AMP. 30V AC
Insulation Resistance:1000MΩ Min.
Contact Resistance:30 MΩ Max.
Dielectric Withstanding Voltage:500V AC
Temperature Range:-55° C to +85° C
Insulator color: Black/White
Plastic material:PBT/LCP
Shell finish:Nickel plated/Tin-Lead plated
Contact finish:
01:Selective Gold Flash
02:Selective Gold 3U”
03:Selective Gold 5U”
04:Selective Gold 15U”
05:Selective Gold 30U”

产品图 PRODUCT CHART DWG				深圳市精拓金电子有限公司						
公差一览表 TOLERANCE UNLESS OTHERWISE				单位 UNITS	MM	制图 DRAWING	Z-Y-B	制图料号 PRODUCT PART NO.	917-121A101XA10400	
X.	±0.15	X.	±5°	比例 SCALE	1:1	审核 CHKD		产品名称 PRODUCT NO.	AM5代MD白胶3U1比1亮面ZB	
.XX	±0.05	.XX	±1°	日期 DATE	2013.1.15	核准 APPD		角法 VIEW	⊕	版本 VER
.XXX	±0.03	.XXX	±0.5°							AO

1 2 3 4 5 6 7 8 9 10