

**PRINCIPAL SPECIFICATIONS**

Model Number	Frequency Range, MHz	Freq., Perform., MHz	Isolation, dB		Insertion Loss, dB		Phase Balance		Amplitude Bal., dB		VSWR, (In/Output)		Internal Load Dissip.
			Min.	Typ.	Max.	Typ.	Max.	Typ.	Max.	Typ.	Max.	Typ.	
PDS-20-600	50 - 1000	50 - 150	15	25	1.0	0.7	2°	1°	0.3	0.1	1.8:1	1.5:1	125 mW
		150 - 1000	25	30	1.0	0.7	2°	1°	0.3	0.1	1.4:1	1.2:1	

**Package Outline**

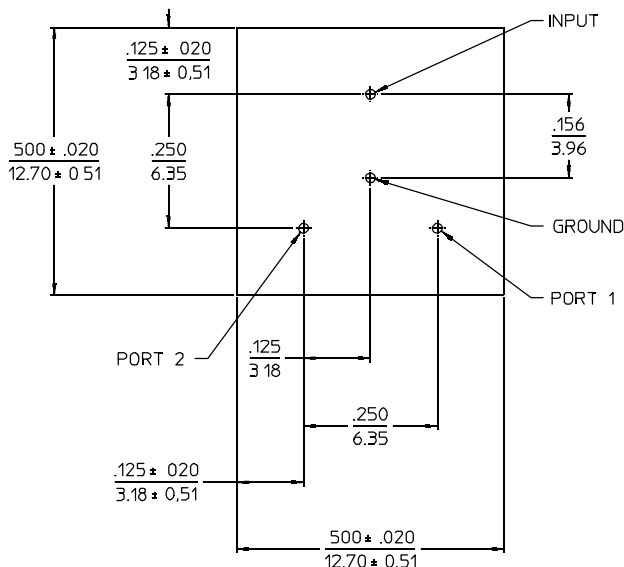
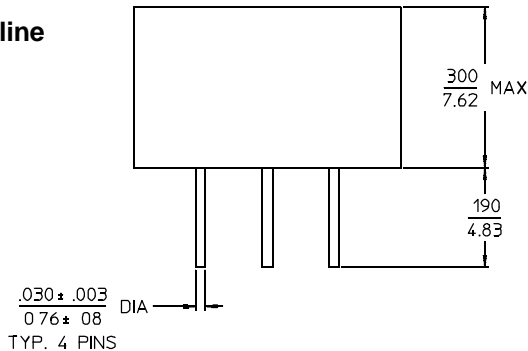

NOTES: 1. Tolerance on 3 place decimals ±.010(.25) except as noted.  
2. Dimensions in inches over millimeters.

**GENERAL SPECIFICATIONS**

- Coupling: - 3 dB nom.
- Impedance: 50 Ω nom.
- CW Input Power: 1 Watt max.  
(When used as a divider with 1.2:1 VSWR<sub>out</sub>)
- Package Type: Square Header
- Weight: 0.32 oz. (9 g)
- Operating Temperature: - 55° to +85°C

**General Notes:**

1. The PDS-20-600 2-way Power Divider/Combiner covers 50 to 1,000 MHz using a special lumped element design to reduce the size making it suitable for applications requiring high performance in a small package.
2. For maximum reliability in a PC package, Merrimac recommends the use of a Meri-Pac™ equivalent PDP-2N series which is hermetically sealed with a welding process.

22Feb96