

Single peg for 4 contacts only

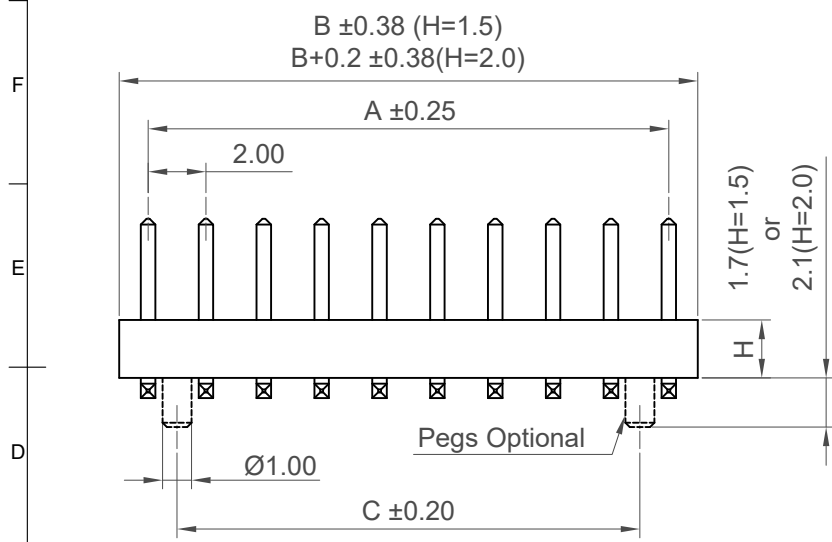

Recommended P.C.B Layout
 Solder Area

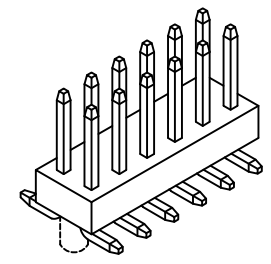
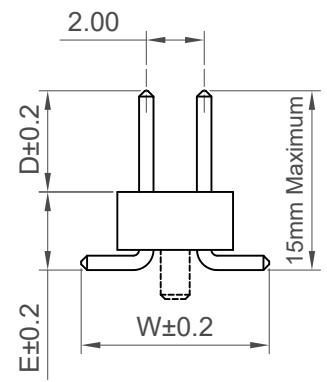

Specifications

Material
 Contact: Copper Alloy
 Insulator:
 Standard: Polymer, LCP, UL 94-V0
 Options: Polyamide, Nylon 6T, UL 94-V0

Electrical
 Current Rating: 2 Amp per pin
 Insulation Resistance: 1000 MΩ min
 Contact Resistance: 20 mΩ max.
 Dielectric Withstand Voltage: AC 500 V

Mechanical & Environmental
 Operating Temperature: -40°C to +105°C

Soldering Process
 LCP (Standard) -
 IR Reflow: 260°C for 10 sec.
 Manual Solder: 350°C for 3-5 sec
 Nylon 6T (Option) -
 IR Reflow: 260°C for 10 sec.
 Manual Solder: 350°C for 3-5 sec
Mates with (Subject to pin length)
 BF065 BF075 BF080 BF095
 BF100 BF105 BF110 BF112
 BF115 BF120 BF185

Number of Contacts	Dimensions		
	A	B	C
4	2.0	4.0	N/A
6	4.0	6.0	2.0
8	6.0	8.0	4.0
10	8.0	10.0	6.0
12	10.0	12.0	8.0
14	12.0	14.0	10.0
16	14.0	16.0	12.0
18	16.0	18.0	14.0
20	18.0	20.0	16.0
22	20.0	22.0	18.0
24	22.0	24.0	20.0
26	24.0	26.0	22.0
28	26.0	28.0	24.0
30	28.0	30.0	26.0
32	30.0	32.0	28.0
34	32.0	34.0	30.0
36	34.0	36.0	32.0
38	36.0	38.0	34.0
40	38.0	40.0	36.0
42	40.0	42.0	38.0
44	42.0	44.0	40.0
46	44.0	46.0	42.0
48	46.0	48.0	44.0
50	48.0	50.0	46.0

Ordering Grid
 BF030-XXX-XX-XXXX-XXXX-XXXX-XX
 Request Samples and Quotation

No. of Contacts
 04 to 50

Contact Plating
 A = Gold Flash All Over (Standard)
 B = Selective Gold Flash Contact Area/Tin On Tail
 C = Tin All Over
 D = 10µ" Gold All Over
 G = 10µ" Gold Contact Area/Tin On Tail
 I = 30µ" Gold Contact Area/Tin On Tail

Insulator Height 'H'
 B = 2.00mm (Standard)
 A = 1.50mm

Locating Peg
 0 = Without
 1 = With

Dimension D (1/100mm) (Post Height)
 0200 = 2.00mm (Standard)
 0400 = 4.00mm (Standard)
 0600 = 6.00mm (Standard)
 Or specify custom Post Height
 eg. 0250 = 2.50mm
 (Maximum 0800 = 8.00mm)
 (Minimum 0100 = 1.00mm)

Dimension W (1/100mm) (Footprint Width)
 0600 = 6.00mm (Standard where 'H' = 2.00mm)
 0550 = 5.50mm (Standard where 'H' = 1.50mm)
 Or specify custom Footprint Width
 eg. 0550 = 5.50mm (Tooling charge may apply)

Dimension E (1/100mm) (PCB to Top of Insulator)
 0277 = 2.77mm (Standard where 'H' = 2.00mm)
 0220 = 2.20mm (Standard where 'H' = 1.50mm)
 Or specify custom Dimension E
 eg. 0250 = 2.50mm
 (Minimum 0260 = 2.60mm where 'H' = 2.00mm)
 (Minimum 0210 = 2.10mm where 'H' = 1.50mm)

Packing Options
 B = Tape & Reel with Cap (Standard)
 D = Tube
 E = Tube with Cap

Insulator Material
 L = LCP (Standard)
 N = Nylon 6T

Part Number		Product Description	
BF030		2.0mm Pitch Pin Header, Dual Row, Surface Mount	
Drawing Date		26th October 2007	
By	CC	Tolerances (Except as Noted)	Units:
Detail	BF030 D PCN	Length X ± 0.30 D PCN X.X ± 0.20 X.XX ± 0.15 X.XXX ± 0.10	Angle X° ± 5° X.X° ± 2° X.XX° ± 1° X.XXX° ± 0.5°
Revision	D7	Metric (mm)	
Date	27/04/22	 	

This drawing is confidential and copyright of Global Connector Technology, Ltd (GCT). This drawing must not be copied or disclosed without written consent. E & OE

GCT
www.gct.co

Not to Scale	Drawn By LYH	Sheet No. 1/1
--------------	--------------	---------------