

DWG. NO.		261-910-0630G	
REV	DESCRIPTION	BY DATE	APPD
E	ECN 2360	7/9/97	AT

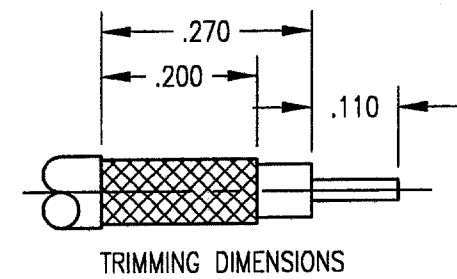
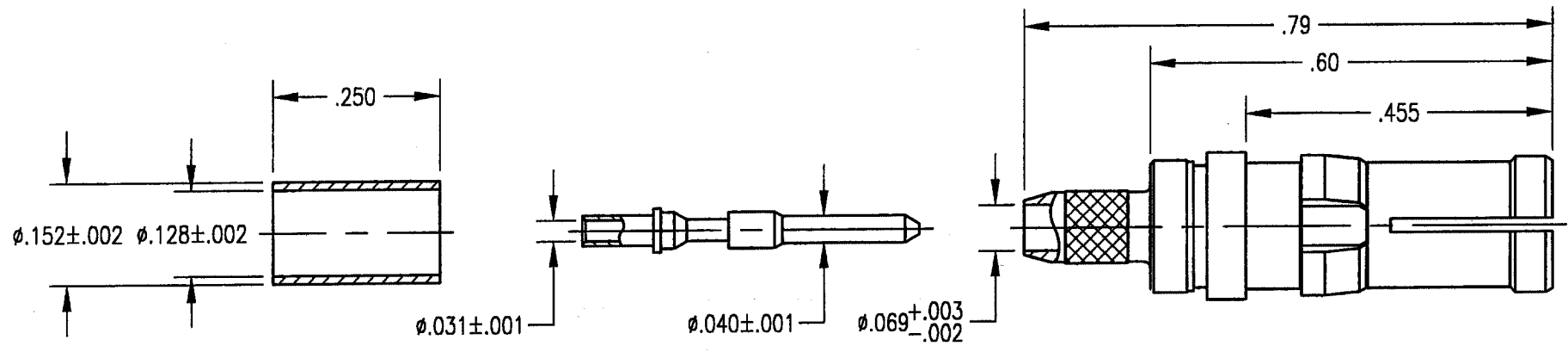

NOTES:

- MATERIALS:
 FRONT BODY: BERYLLIUM COPPER PER ASTM B196
 REAR BODY AND CONTACT: BRASS PER ASTM B16
 INSULATOR: TEFLON PER ASTM D1710
 FERRULE: BRASS PER ASTM B16
 CLIP RING: BERYLLIUM COPPER PER ASTM B194
- FINISH:
 BODIES AND CONTACT: .000030 MIN. GOLD PER MIL-G-45204 OVER
 .000050 MIN. NICKEL PER QQ-N-290
 CLIP RING: .000100 MIN. NICKEL PER QQ-N-290 OVER COPPER
 FLASH
 FERRULE: .000005 MIN. GOLD PER MIL-G-45204 OVER .000050 MIN.
 NICKEL PER QQ-N-290
- FOR ASSEMBLY USE CAP 9-07 WITH ABOVE TRIM DIMENSIONS

PER ASME Y14.5M-1994 UNLESS OTHERWISE SPECIFIED: DIMENSIONS ARE IN INCHES OR INCHES/MM				Litton			
TOLERANCES: .XX ± .01/0.254 .XXX ± .005/0.127 ANGLES ± Z°				400 Park Road Wolcott, Connecticut 06795			
SCALE: 4:1				Winchester Electronics/RETCONN			
CUSTOMER DRAWING				TITLE RDM CRIMP/CRIMP RECEPTCLE WITH CAPTIVE CENTER CONTACT			
DRAWN KJT	DATE 7/9/97	CHECKED JMC	DATE 7/9/97	A		261-910-0630G	SHT. OF 1 1
APPROVED AT	DATE 7/9/97	APPROVED AT	DATE 7/9/97				REV. E