

| Rev | AWO # | Description | Date | Appr |
|-----|-------|-------------|---------|------|
| - | | RELEASED | 9/15/10 | |

APPROVED: _____
 DATE: _____ TITLE: _____

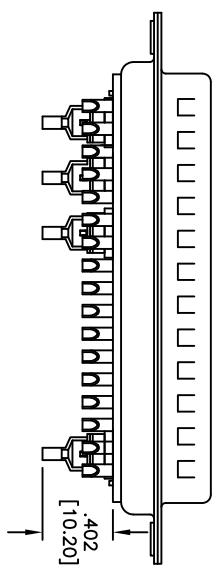
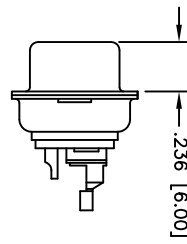
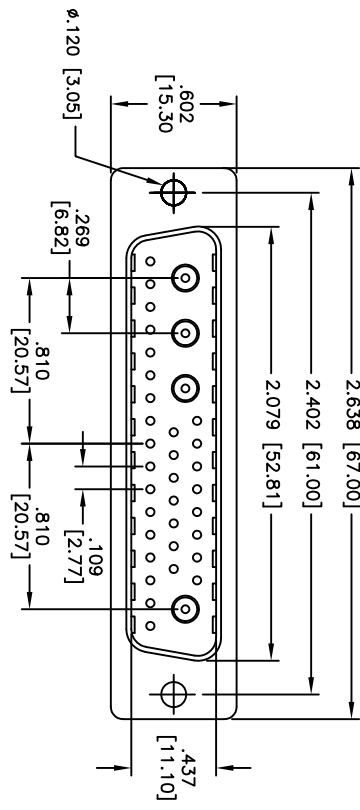

SPECIFICATIONS:

Material:
 Insulator: PBT, 30% glass reinforced, rated UL 94V-0
 Insulator color: Black
 Coaxial center Insulator: Teflon
 Coaxial center Insulator color: White
Contacts: Brass
 Shell: Steel, Tin plated
 Hardware: Brass, Nickel plated
Plating:
 Gold flash over Nickel underplate overall
Electrical:
 Operating voltage: 250 VAC max
 Current rating: 10 – 40 Amps max (See Chart)
 Contact resistance: 10 mohms max
 Insulation resistance: 5,000 Mohms min
 Dielectric withstanding voltage: 1,000 VAC for 1 minute
Temperature Rating:
 Operating temperature: -55°C to +280°C
 Environmental:
 Lead free, RoHS compliant



ADAM TECH

909 Railway Avenue, Union, NJ 07083
 Phone: 908-687-5000 Fax: 908-687-5710

TITLE: D-SUB POWER PLUG; D36W4; STRAIGHT, FEMALE, SOLDER CUP

| | | | |
|---|--------|-----------------------------|--------------|
| UNLESS OTHERWISE SPECIFIED ALL DIMENSIONS ARE INCHES [MM] | | TOLERANCES: EXCEPT AS NOTED | |
| INCHES | | HOLEES | |
| .X | ± .10 | Ø.X | ± .10 |
| .XX | ± .020 | Ø.XX | ± .015 |
| .XXX | ± .015 | Ø.XXX | ± .010 |
| APPROVALS | | DATE | |
| DRAWN | AY | | 9/15/10 |
| CHECKED | VW | | 9/15/10 |
| APPROVED | | SIZE | PART NO. |
| | | X | D36W4-PD-1-1 |
| | | REF: | S00019T |
| | | SCALE: | NTS |
| | | SHEET | 1 OF 1 |