

DWG. NO. 5W5P-1004			
REV	DESCRIPTION	BY DATE	APPD
A	ECR 6567	JEM 2/17/01	LJS

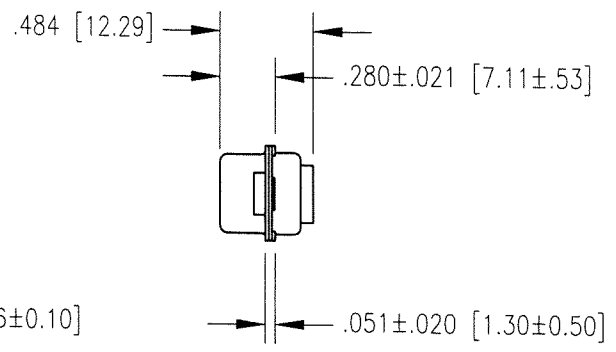
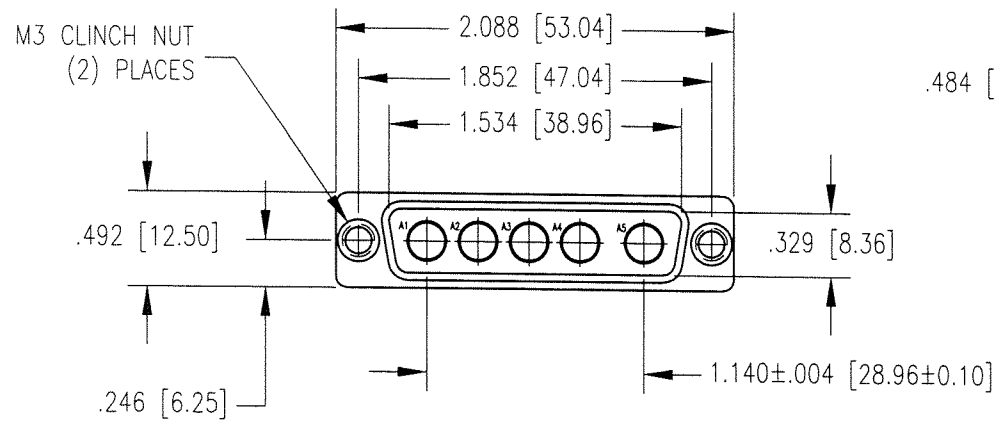
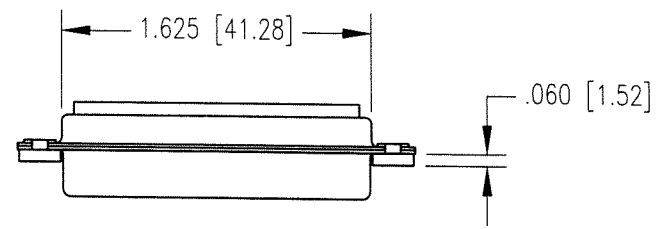

NOTES:

1. MATERIALS:
SHELL AND CLINCH NUTS: STEEL PER ASTM A568
INSULATOR: GLASS FILLED POLYESTER
2. FINISH:
SHELL: YELLOW CHROMATE OVER ZINC PER ASTM B633
INSULATOR: BLACK

PER ASME Y14.5M-1994 UNLESS OTHERWISE SPECIFIED: DIMENSIONS ARE IN INCHES (MM)		Litton	
TOLERANCES: DECIMALS .xx ± .01/0.254 .xxx ± .005/0.127 ANGLES ± 2°		Winchester/Retconn 400 Park Road Watertown, Connecticut 06795	
SCALE: 1:1		TITLE	
CUSTOMER DRAWING		5W5P D-SUB CONNECTOR	
DRAWN JED	DATE 1/15/01	CHECKED JEM	DATE 1/16/01
APPROVED JMC	DATE 1/16/01	APPROVED KJT	DATE 1/16/01
A		5W5P-1004	SHT. 1 OF 1 REV. A