

PCB LAYOUT TOP VIEW

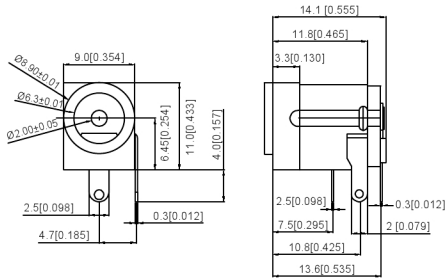

SCHEMATIC	
Model	DC-005E
Center Pin	Ø2.0 mm
	Ø2.5 mm

SPECIFICATIONS:

规格:

1. ELECTRICAL CHARACTERISTICS:

电气特性:

1-1.RATING:

评级:

1-2. CONTACT RESISTANCE:30mΩ MAX.(INITIAL)

接触电阻: 最大30mΩ (初始)

1-3. DIELECTRIC WITHSTANDING VOLTAGE:500V AC FOR ONE MINUTE

介质耐受电压: 500V AC FOR ONE MINUTE

1-4.INSULATION RESISTANCE: 100MΩ MIN. MEASURED BY 500V DC

绝缘电阻: 500V 直流电测得的最小值为100MΩ

2. MECHANICAL CHARACTERISTICS:

机械特性:

2-1. INSERTION FORCE:0.3~3.0 KGF

插入力: 0.3~3.0 KGF

2-2. WITHDRAWAL FORCE:0.3~3.0 KGF

拔出力: 0.3~3.0 KGF

3. LIFE TEST:5,000 CYCLES MIN.

寿命试验: 至少5000次循环。

4.FOR REFLOW SOLDERING LEAD-FREE PROCESS.

用于回流焊无铅工艺。

5.REPRESENT CRITICAL DIMENSIONS.

表示关键尺寸。

	MATERIAL	PLATING
center pin	Brass	tin
terminal 1	Brass	tin
terminal 2	Sus	tin
terminal 3	Brass	tin
plastic	Pbt	

广东星坤科技股份有限公司

生	日期
效	
Δ*	
文件	工程章

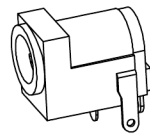

MARK	DESCRIPTION	REVISIONS	DATE	REVISED	APPROVED
ANGLAR	±5°				
X.X	±0.2mm				
X.XX	±0.1mm				
X.XXX	±0.05mm				

DSND	DATE	SCALE: N/A	MODEL TYPE: DC POWER JACK
DWN	DATE	VIEW:	PART NO.:
CHKD	DATE	UNIT: mm/in	DWG NO.:
APPD	DATE	SIZE: A4	DC-005E-2.5A-2.0
XKB INDUSTRIAL PRECISION CO.,LIMITED			WEIGHT SHEET REVISION 1.0g 1/1 A0