



BLOCK TYPE AVALANCHE AUTOMOTIVE RECTIFIER

BA50L

AVALANCHE VOLTAGE 20 to 24 Volts

CURRENT 50 Amperes

Technical Specification:

Features:

- High power capability
- Economical
- Avalanche Voltage: 20V to 24V
- Glass passivated chip

MECHANICAL DATA

- Copper cup with transfer molded plastic
- Epoxy: UL94-0 rate flame retardant
- Polarity: BA50L-P lead-P
BA50L-N lead-N
- Technology vacuum soldered
- Lead: Plated slug, solderable per MIL-STD-202E Method 208C
- Weight: 0.094 ounce 2.65 Grams

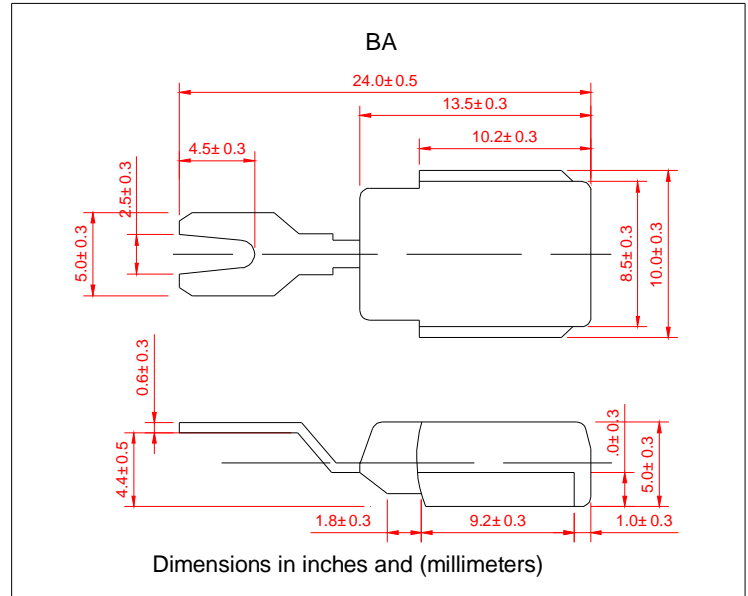

MAXIMUM RATINGS AND ELECTRICAL CHARACTERISTICS

- Ratings at 25°C ambient temperature unless otherwise specified
- Single Phase, half wave, 60Hz, resistive or inductive load
- For capacitive load derate current by 20%

Electrical Characteristics @ 25°C	SYMBOLS	BA50L-P/BA50L-N			UNITS
		MIN	NOMINAL	MAX	
Peak Repetitive Reverse Voltage	V_{RRM}		17		Volts
Working Peak Reverse Voltage	V_{RRM}		17		
DC Blocking Voltage	V_{DC}		17		
Average Rectified Forward Current ($T_c=125^\circ\text{C}$)	I_o		40		Amps
Repetitive Peak Reverse Surge Current $T_c=10\text{msec}$ Duty Cycle < 1%	I_{RSM}		40		Amps
Breakdown Voltage ($V_{br@I_r=100\text{mA}, T_c=25^\circ\text{C}}$)	V_{br1}	20	22	24	Volts
$I_r=90\text{Amps}, T_c=150^\circ\text{C}, PW=80\text{usec}$	V_{br2}			32	Volts
Forward Voltage Drop @ $I_f=100\text{Amps} < 300\text{usec}$	V_F		1.05	1.08	Volts
Peak Forward Surge Current	I_{FSM}		600		Amps
Reverse Leakage ($V_R=17\text{Vdc}$) $T_A=25^\circ\text{C}$	I_R		1.0	2.0	uAmps
Operating and Storage Junction Temperature Range	T_J, T_{STG}	-65 to +175			°C

Notes: 1. Enough heatsink must be considered in application.

