

Distribution Unit with 1 IEC Appliance Inlet C14 and 2 Appliance Outlets F, Shuttered

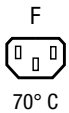

See below:

**Approvals and Compliances**

**Description**

- Stand alone module
- 1 Function :  
of 2 outlets , Pin temperature 70 °C , Protection class I , shuttered

**Weblinks**

[pdf datasheet](#), [html-datasheet](#), [General Product Information](#), [Distributor-Stock-Check](#), [Accessories](#), [Detailed request for product](#)

**Technical Data**

|                                 |   |                         |  |
|---------------------------------|---|-------------------------|--|
| Ratings IEC                     | 10A / 250VAC; 50Hz  | appliance inlet/-outlet | C14 acc. to IEC 60320-1,<br>/ F acc. to IEC 60320-3  |
| Ratings UL/CSA                  | 10A / 250VAC; 60Hz  |                         | UL 498 CSA C22.2 no. 42 (for cold conditions) pin-temperature 70 °C, 10A, Protection Class I |
| Dielectric Strength             | > 2.5kVAC between L-N<br>> 2.5kVAC between L/N-PE<br>(3 sec/50Hz) |                         |  |
| Allowable Operation Temperature | -25 °C to 70 °C   |                         |  |
| Insulation cover                | Suitable for appliances with protection class I acc. to IEC 61140 |                         |  |
| Material: Housing               | Thermoplastic, black, UL 94V-0                                    |                         |  |

**Approvals and Compliances**

Detailed information on product approvals, code requirements, usage instructions and detailed test conditions can be looked up in [Details about Approvals](#)

**Product standards**

Product standards that are referenced

| Organization | Design                | Standard         | Description   |
|--------------|-----------------------|------------------|---|
|              | Designed according to | IEC 60320-1      | Appliance couplers for household and similar general purposes         |
|              | Designed according to | IEC 60320-3      | Appliance couplers for household and similar general purposes         |
|              | Designed according to | UL 498           | Standard for Attachment Plugs and Receptacles                         |
|              | Designed according to | CSA C22.2 no. 42 | General Use Receptacles, Attachment Plugs, and Similar Wiring Devices |





**Application standards**

Application standards where the product can be used

| Organization | Design                         | Standard     | Description   |
|--------------|--------------------------------|--------------|---|
|              | Designed for applications acc. | IEC/UL 60950 | IEC 60950-1 includes the basic requirements for the safety of information technology equipment. |

**Compliances**

The product complies with following Guide Lines

| Identification   | Details                                      | Initiator   | Description   |
|--|--|-------------|---|
|  | <a href="#">CE declaration of conformity</a> | SCHURTER AG | The CE marking declares that the product complies with the applicable requirements laid down in the harmonisation of Community legislation on its affixing in accordance with EU Regulation 765/2008. |
|  | RoHS   | SCHURTER AG | EU Directive RoHS 2011/65/EU  |
|  | China RoHS                                   | SCHURTER AG | The law SJ / T 11363-2006 (China RoHS) has been in force since 1 March 2007. It is similar to the EU directive RoHS.  |
|  | REACH  | SCHURTER AG | On 1 June 2007, Regulation (EC) No 1907/2006 on the Registration, Evaluation, Authorization and Restriction of Chemicals 1 (abbreviated as "REACH") entered into force.                               |

**Dimensions [mm]**

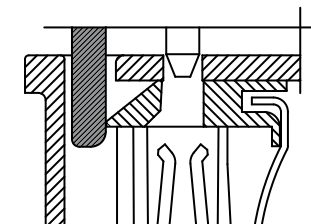
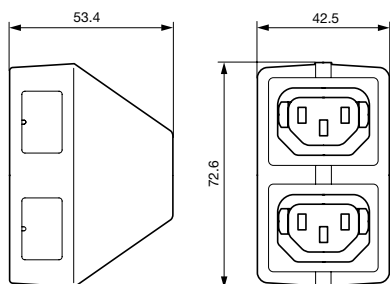

Shutter operation:  
shutters opened by plug insertion

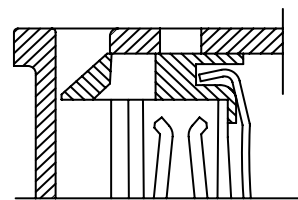

Shutter operation:  
shutters closed when plug is removed

**All Variants**

| Type | Order Number |
|------|--------------|
| 4741 | 4741.0000    |

 Most Popular.

Availability for all products can be searched real-time: <https://www.schurter.com/en/Stock-Check/Stock-Check-SCHURTER>

**Packaging unit** 50 Pcs

**Mating Inlets/Plugs**

**Category / Description**

[Plug Overview complete](#)



|   |      |
|---|------|
| IEC Plug E, Cord Connector (Rewireable), Straight, max. cable Diameter 8.5 mm | 4732 |
| IEC Plug E, Cord Connector (Rewireable), Straight, max. Cable Diameter 10 mm  | 4735 |
| IEC Plug E, Cord Connector (Rewireable), Straight                             | 9009 |
| IEC Plug E, Cord Connector (Rewireable), Angled, max. Cable Diameter 8.5 mm   | 4733 |
| IEC Plug E, Cord Connector (Rewireable), Angled, max. Cable Diameter 10 mm    | 4736 |
| <a href="#">Plug further types to 4741</a>                                    | ...  |