

Rev	AWO #	Description	Date	Appr
-		RELEASED	1/14/11	

APPROVED: _____
 DATE: _____ TITLE: _____

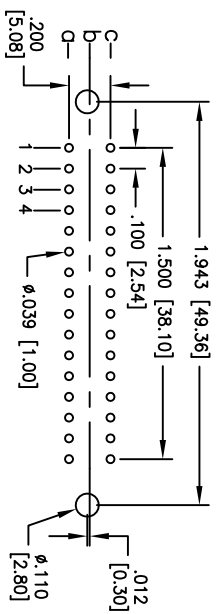
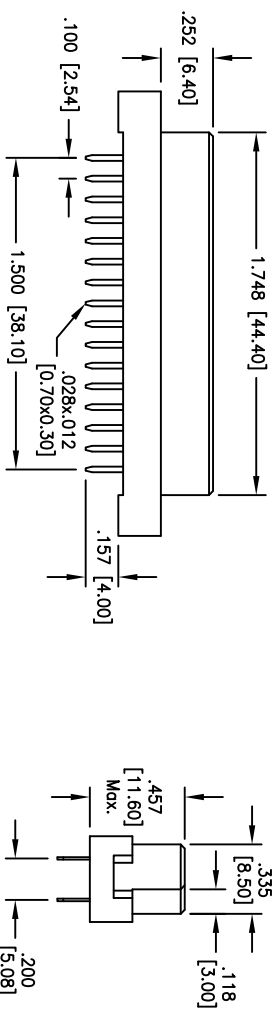
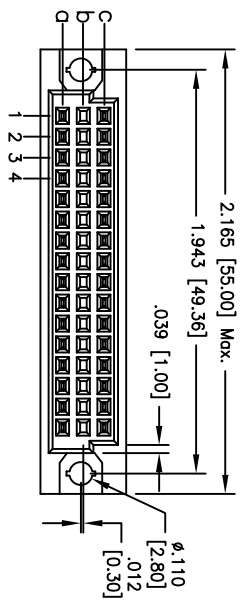

RECOMMENDED PCB LAYOUT

"X"	PLATING	CLASS
1	30 u" Gold	1
2	15 u" Gold	2
3	Gold Flash	3

SPECIFICATIONS:

Material:
 Insulator: PBT, glass reinforced, rated UL 94V-0
 Contacts: Phosphor Bronze
Plating:
 Gold over Nickel underplate on contact area,
 Tin over Copper underplate on solder tails.
 (See chart for thickness)

Electrical:

Current rating: 2 Amps max
 Contact resistance: 50 mohms max
 Insulation resistance: 1000 Mohms min
 Dielectric withstanding voltage: 1000 VAC for 1 minute
Temperature Rating:
 Operating temperature: -55°C to +105°C
 Environmental:
 Lead free, RoHS compliant.
 Recommended soldering temp: 235°C for 5 sec.



ADAM TECH

909 Railway Avenue, Union, NJ 07083
 Phone: 908-687-5000 Fax: 908-687-5710

TITLE: DIN TYPE C FEMALE, 32 PINS LOADED
 3 ROW STRAIGHT, ROW A & C LOADED

UNLESS OTHERWISE SPECIFIED ALL DIMENSIONS ARE MM [INCHES] TOLERANCES: EXCEPT AS NOTED		HOLE SIZE	
.XX ± .10	ØXX ± .10	.XXX ± .015	ØXXX ± .015
APPROVALS		DATE	
DRAWN	AY	1/14/11	
CHECKED	JL	1/14/11	
APPROVED			

SIZE	PART NO.	SCALE	SHEET
X	DIN-32FS-S32-A1CX	NTS	1 OF 1
REV.			

A

B

C

D

A

B

C

D

6

5

4

3

2

1