

SCHEMATIC

FUNCTION: 1P1T ON-ON

RATING: 2A 48VDC
 ILLUMINATION VOLTAGE:
 Forward: 2.8V 20mA
 Reverse: 2.8V 20mA

CONTACT RESISTANCE:
 Initial: 50mΩ Max. at 1A 12VDC

INSULATION RESISTANCE:
 1,000MΩ Min. at 500VDC
 DIELECTRIC STRENGTH:
 2,000VAC Min. for 1 Minute
 ELECTRICAL LIFE:
 50,000 Cycles
 MECHANICAL LIFE:
 1,000,000 Cycles

TEMPERATURE:
 Operating: -20°C to 70°C
 INGRESS PROTECTION:
 IP65

APPROVALS:
ROHS
 COMPLIANT

MATERIALS

BUSHING: Stainless Steel (304)
 BASE: Polycarbonate (PC)
 POLYETHYLENE TEREPHTHALATE (PET), U194 V-2
 ACTUATOR: Stainless Steel (304)
 Polycarbonate (PC)
 HARDWARE: Nickel Plated Brass (H59)

SEALING: Silicone Rubber
 INNER ASSEMBLY: Polyoxymethylene (POM)
 Phosphor Bronze
 SPRING: Spring Steel

CONTACTS: Silver/Cadmium Oxide (AgCdO)
 TERMINALS: Silver Plated Brass (H62)
 Silver Plated Phosphor Bronze
 O-RING: Silicone Rubber

COLORS AND FINISH

BEZEL: Stainless Steel
 Machine Finish
 ACTUATOR: Stainless Steel
 Machine Finish
 ILLUMINATION: White (Forward)
 Green (Reverse)
 MARKING: Power Symbol (M01)

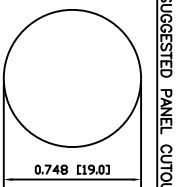
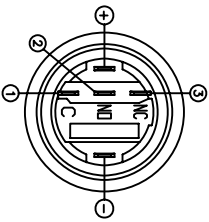

MAXIMUM PANEL THICKNESS: 0.433 [11.0mm]

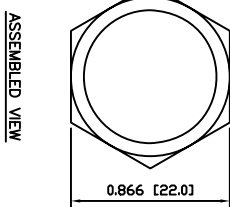
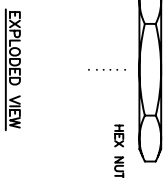

EXPLODED VIEW

ASSEMBLED VIEW

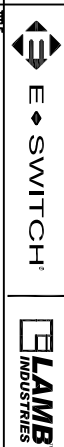

PV4F230SS-3C1-M01

REV.	DATE	BY	CHK
A	10/06/18	CAB	
B	09/10/18	CAB	
1	10/06/18	CAB	

THE INFORMATION CONTAINED IN THIS DOCUMENT IS PROPRIETARY TO E-SWITCH AND IS NOT TO BE COPIED OR TRANSMITTED

REV. A

NEW RELEASE DESCRIPTION

2004

5/30/12

DRWN BY

SCALE

±0.008 [±0.2] / ±1

PROJECTION

TRIP NUMBER

52-PV4F230SS3C1M01

DATE

8-6-2012

REVISION

A